

**Date:** 10/05/2024 **Author:** THM/JC **Project:** THM5981

**Comments:**  
Traffic Management Plan to enable THM with works at Vesey Clos in Abbeyleix, Co. Laois.

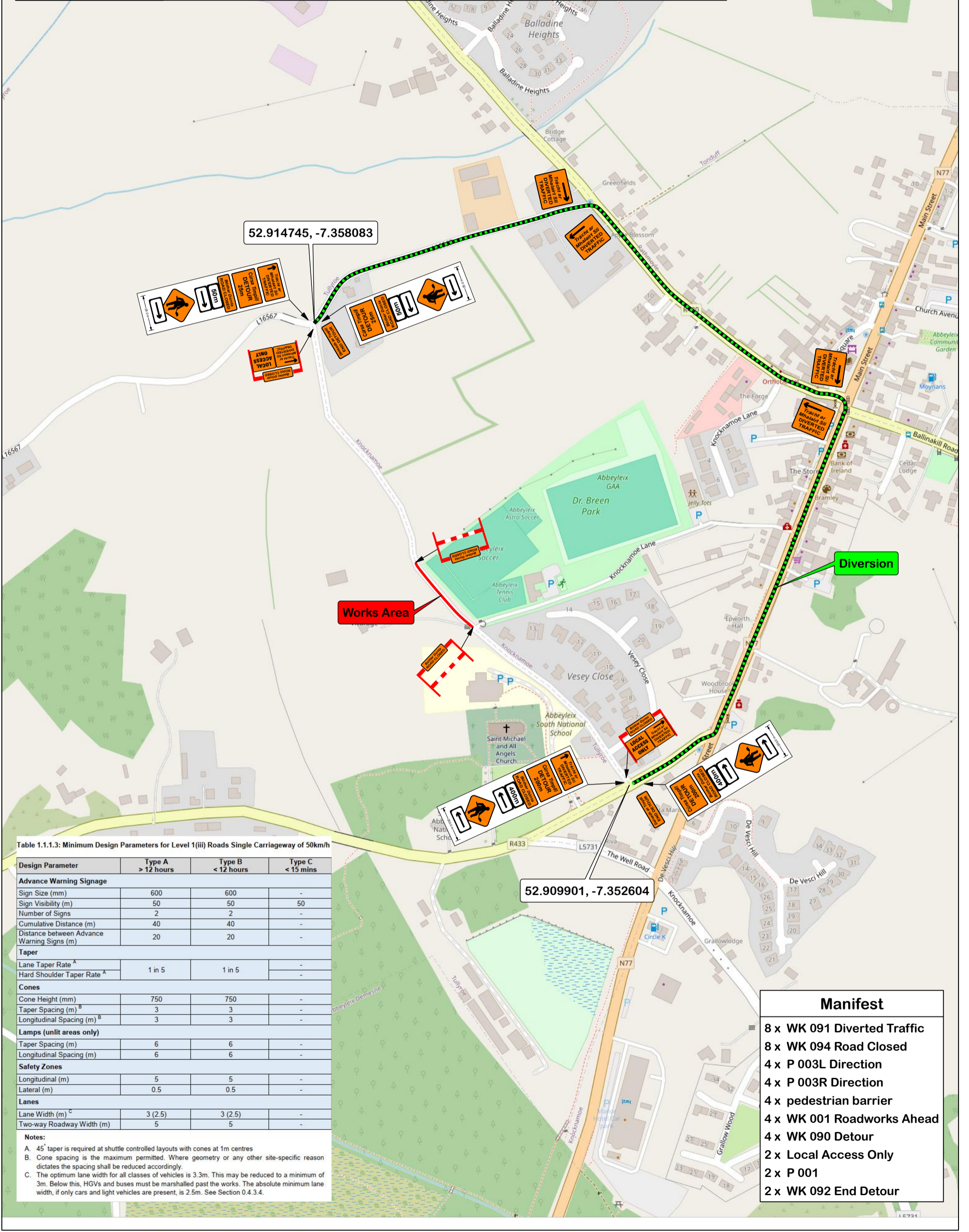

Table 1.1.1.3: Minimum Design Parameters for Level 1(iii) Roads Single Carriageway of 50km/h

Design Parameter	Type A > 12 hours	Type B < 12 hours	Type C < 15 mins
<b>Advance Warning Signage</b>			
Sign Size (mm)	600	600	-
Sign Visibility (m)	50	50	50
Number of Signs	2	2	-
Cumulative Distance (m)	40	40	-
Distance between Advance Warning Signs (m)	20	20	-
<b>Taper</b>			
Lane Taper Rate <sup>A</sup>	1 in 5	1 in 5	-
Hard Shoulder Taper Rate <sup>A</sup>	-	-	-
<b>Cones</b>			
Cone Height (mm)	750	750	-
Taper Spacing (m) <sup>B</sup>	3	3	-
Longitudinal Spacing (m) <sup>B</sup>	3	3	-
<b>Lamps (unlit areas only)</b>			
Taper Spacing (m)	6	6	-
Longitudinal Spacing (m)	6	6	-
<b>Safety Zones</b>			
Longitudinal (m)	5	5	-
Lateral (m)	0.5	0.5	-
<b>Lanes</b>			
Lane Width (m) <sup>C</sup>	3 (2.5)	3 (2.5)	-
Two-way Roadway Width (m)	5	5	-

**Notes:**  
 A. 45° taper is required at shuttle controlled layouts with cones at 1m centres  
 B. Cone spacing is the maximum permitted. Where geometry or any other site-specific reason dictates the spacing shall be reduced accordingly.  
 C. The optimum lane width for all classes of vehicles is 3.3m. This may be reduced to a minimum of 3m. Below this, HGVs and buses must be marshalled past the works. The absolute minimum lane width, if only cars and light vehicles are present, is 2.5m. See Section 0.4.3.4.

<b>Manifest</b>	
8 x	WK 091 Diverted Traffic
8 x	WK 094 Road Closed
4 x	P 003L Direction
4 x	P 003R Direction
4 x	pedestrian barrier
4 x	WK 001 Roadworks Ahead
4 x	WK 090 Detour
2 x	Local Access Only
2 x	P 001
2 x	WK 092 End Detour