

PN2701-03-01 R428, Road Closure - Diversion

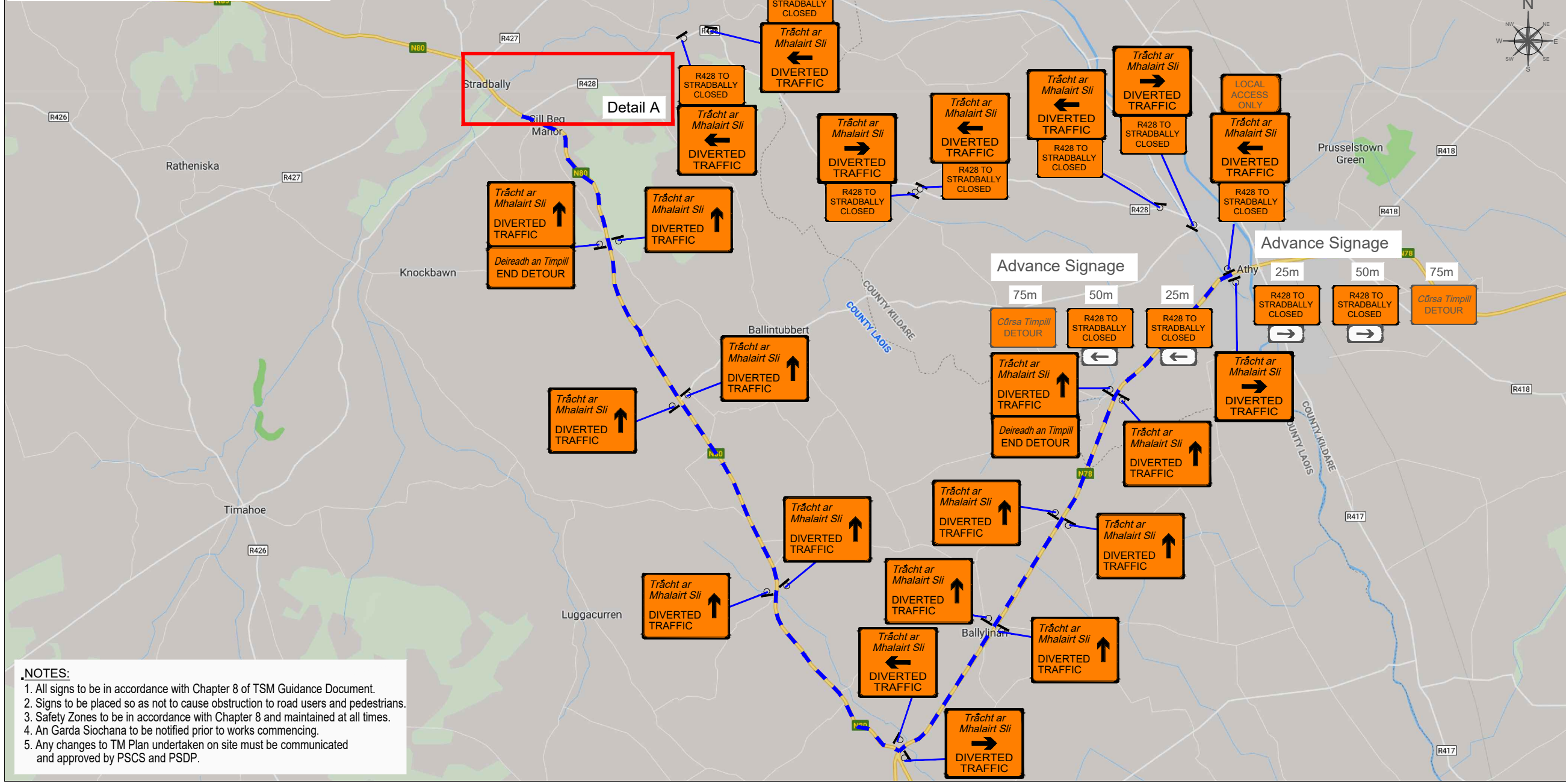

NOTES:
 1. All signs to be in accordance with Chapter 8 of TSM Guidance Document.
 2. Signs to be placed so as not to cause obstruction to road users and pedestrians.
 3. Safety Zones to be in accordance with Chapter 8 and maintained at all times.
 4. An Garda Síochána to be notified prior to works commencing.
 5. Any changes to TM Plan undertaken on site must be communicated and approved by PSCS and PSDP.

DESIGN PARAMETERS

Roadworks Type	- B
Speed Limit	- 80km/h
Sign Visibility	- 120m
Number of Signs	- 4
Cumulative Distance	- 800m
Distance between:	
advance signs (m)	- 200m
Taper at Lane	- 1 in 55
Taper at HS	- 1 in 30
Max. Cone Spacing:	
At Tapers	- 3m
Longitudinal	- 12m
Cone Height	
Max. Lamp Spacing:	
At Tapers	- 6m
Longitudinal	- 12m
Safety Zones:	
Longitudinal	- 60m
Lateral	- 1.2m
Min. Lane Width	- 3.0m

LEGEND:

- WORKS AREA
- SAFETY ZONES
- TAPER
- CONES
- SIGN LOCATION
- DIVERSION ROUTE

	WK 111		WK 062
			WK 052, 053

SIGN LOCATION PLACEMENT IS TO BE DECIDED BY THE ONSITE SUPERVISOR, AS TO DETERMINE THE LOCATION FOR THE BEST VISIBILITY AND HIGHEST AWARENESS

MTC
 CONSULTING AND DESIGN
Road Traffic Management Design and Planning
 W: www.mtcdesign.ie E: info@mtcdesign.ie
 T: 085 141 4424
 E: mtcdesign@bt.ie
 R: Roscrea, Co. Tipperary

AllSafe Road Services Limited

Client: Mark Rochford

Project Title: CATTLE UNDERPASS R428, STRADBALLY CO. LAOISE

Drawing Title: Traffic Management Plan R428, Road Closure

Design:	Checked:
TS	
Drawn:	Approved:
TS	
Drawing no.:	Project no.:
01	PN 2701-03
Scale:	Revision:
A3 @ NTS	0
Date:	
	DATE : 09/04/2019