

ADOPTED 25/01/2022
LAOIS COUNTY COUNCIL
COUNTY DEVELOPMENT PLAN
2021-2027

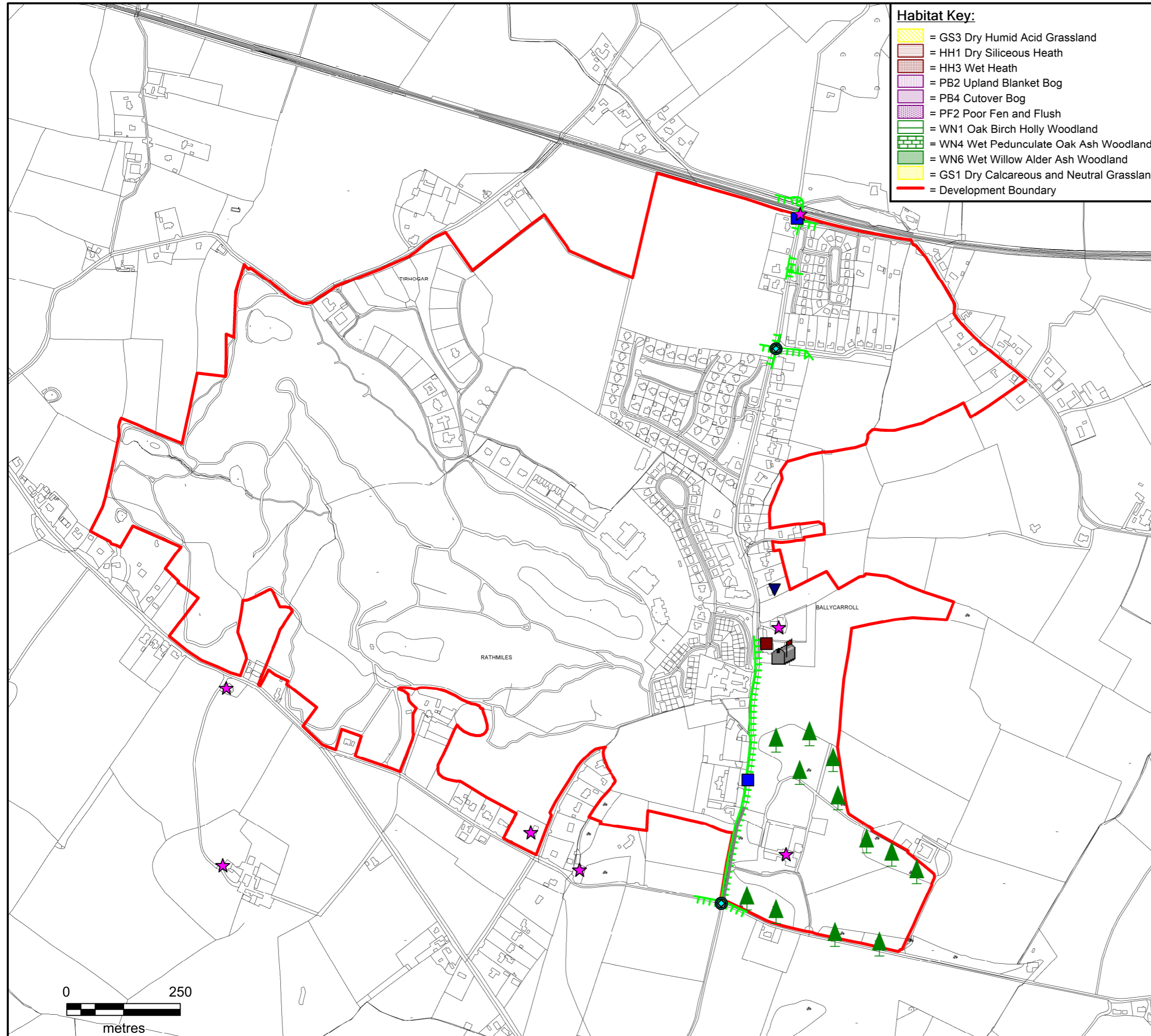
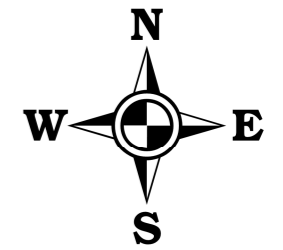
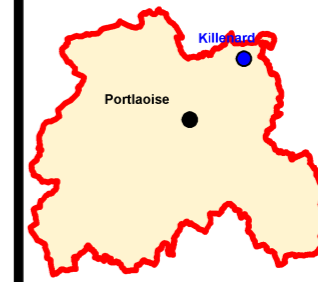

Habitat Key:

	= GS3 Dry Humid Acid Grassland
	= HH1 Dry Siliceous Heath
	= HH3 Wet Heath
	= PB2 Upland Blanket Bog
	= PB4 Cutover Bog
	= PF2 Poor Fen and Flush
	= WN1 Oak Birch Holly Woodland
	= WN4 Wet Pedunculate Oak Ash Woodland
	= WN6 Wet Willow Alder Ash Woodland
	= GS1 Dry Calcareous and Neutral Grassland
	= Development Boundary

Objective Legend:

	= Welcome Sign		= Provision of Planting
	= Protect Tree Stand		= Demarcation of Parking Spaces
	= Signage Locations For Recycling		= Upgrade Open Space
	= Recycling Centre Locations		= Provide or Improve Pedestrian Crossing
	= Play Ground		= Re-surface Area Within
	= Green Area		= Signage for School/Community Centre
	= Seating & Bins		= Maintain Signage
	= Picnic Area		= Maintain Signage To Old Graveyard
	= Protected Structures		= Maintain Signage To For Emo Court
	= Designate Architectural Conservation Area (ACA)		= Set Down For Bus Area
	= Archaeological Zone		= New Dublin-Cork Bus Stop
	= Provide Lime Killin Feature		= Maintain Stone Wall
	= School Flashing Lights		
	= Traditional Lighting		
	= New Lighting		
	= Park and Ride Area		
	= Area for Master Plan		
	= Amenity Area		
	= Provide or Improve Footpaths and Public Lighting		
	= Up Grade and Construct Footpath where necessary		
	= Provide Walkway on Riversides		
	= Clean Out River		
	= Maintain Natural Boundary		
	= Development Boundary		
	= Opportunity/Regeneration Sites		
	= Traffic Calming Measures		
	= Improve Junction Layout		

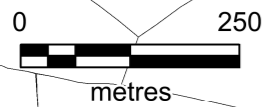

MAP 6.4 (B) - KILLENARD



LAOIS COUNTY COUNCIL
FORWARD PLANNING SECTION

Drawn: Bryan Scully	Checked: David O'Hara & Nathan Smith	Approved: Angela McEvoy
------------------------	---	----------------------------

PRODUCED BY LAOIS COUNTY COUNCIL'S FORWARD PLANNING SECTION UNDER COPYRIGHT AGREEMENT FROM ORDNANCE SURVEY OF IRELAND. ALL RIGHTS RESERVED. LICENCE NO. 2022/28/CCMA/LAOISCOUNTYCOUNCIL