

Design Parameter	Type A > 12 hours
Advance Warning Signage	
Sign Size (mm)	600
Sign Visibility (m)	90
Number of Signs	4
Cumulative Distance (m)	480
Distance between Advance Warning Signs (m)	120
Taper	
Lane Taper Rate ^A	1 in 40
Hard Shoulder Taper Rate ^A	
Cones	
Cone Height (mm)	750
Taper Spacing (m) ^B	3
Longitudinal Spacing (m) ^B	12
Lamps (unlit areas only)	
Taper Spacing (m)	6
Longitudinal Spacing (m)	24
Safety Zones	
Longitudinal (m)	45
Lateral (m)	1.2
Lanes	
Lane Width (m) ^C	3
Other Design Considerations	
Type of System	Traffic Lights
Road Type	Level 2 (i) 80km
Works Length	<300m
Traffic Voulmn (AADT)	< 5,000 veh/day

Type A – Works requiring full time Temporary Traffic Management (TTM)

Proposed Start Date	12/09/2023
Proposed Completion Date	22/09/2023

Notes:
For Location, refer to Client Layout Plan

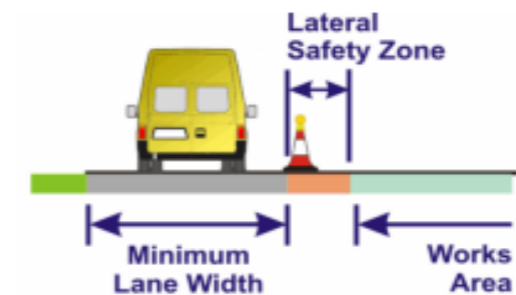

Dunne Brothers Ltd
 "50 years in Plant Hire & Civil Engineering"
 Civil Engineering | Groundworks | Planthire | Demolitions | Utilities
 O'Moore Street, Mountmellick, Laois Tel: 057 8624163
 Email: info@dunnebros.ie

Drawing:	Traffic Management Plan Traffic Signals at Crooked Wood - Phase 2
Project:	Portlaoise MD Paths 2023
Client:	Laois County Council
Date:	06/09/2023 Dwg No. 003