

Table 8.2.2.4  
Minimum Design Parameters for Level 1(HI) Roads  
(Single Carriageway of 50km/h)

Design Parameter	Type A > 12 hours	Type B < 12 hours	Type C < 15 mins
<b>Advance Warning Signage</b>			
Sign Size (mm)	600	600	-
Sign Visibility (m)	50	50	50
Number of Signs	2	2	-
Cumulative Distance (m)	40	40	-
Distance between Advance Warning Signs (m)	20	20	-
<b>Taper</b>			
Lane Taper Rate <sup>A</sup>	1 in 5	1 in 5	-
Hard Shoulder Taper Rate <sup>A</sup>	-	-	-
<b>Cones</b>			
Cone Height (mm)	750	750	-
Taper Spacing (m) <sup>B</sup>	3	3	-
Longitudinal Spacing (m) <sup>B</sup>	3	3	-
<b>Lamps (unit areas only)</b>			
Taper Spacing (m)	6	6	-
Longitudinal Spacing (m)	6	6	-
<b>Safety Zones</b>			
Longitudinal (m)	5	5	-
Lateral (m)	0.5	0.5	-
<b>Lanes</b>			
Lane Width (m) <sup>C</sup>	3 (2.5)	3 (2.5)	-
Two-way Roadway Width (m)	5	5	-

**Note 1:** Written Dimensions are preferred, do not scale dimensions. All Dimensions to be checked before works commence and any discrepancies reported.  
**Note 2:** All Signage to be erected outside visibility splays at junctions and Site Access.  
**Note 3:** Traffic Management will be audited and monitored in order to ensure safety and adequate traffic maneuverability. Should changes be required TTMP will be revised accordingly  
**Note 4:** Interaction between local residents and land owners will be carried out by Main Contractor  
**Note 5:** All Lighting requirements within the works will be the responsibility of the Main Contractor.

**DATE:**  
10.11.2023

**JOB NUMBER:**  
RVLCKCE10112023

**PROJECT NUMBER:**  
RVLCKCE10112023

**AUTHOR:**  
James O'Neill

**LOCATION:**  
Rossmoreview, Graigcullen, Carlow

Temporary Traffic Management to enable works on Rossmore View Estate

Type of TTM:  
Static - Road Narrows - 5 - 5.5m lane maintained for 2 way traffic into Rossmore View - Phase 2



**Legend**

- Area of Assessment on the Day
- Cone
- Pedestrian Tape
- Safety Zone
- Temporary Stores Area
- Unobstructed Pedestrian Pathway
- Work Area

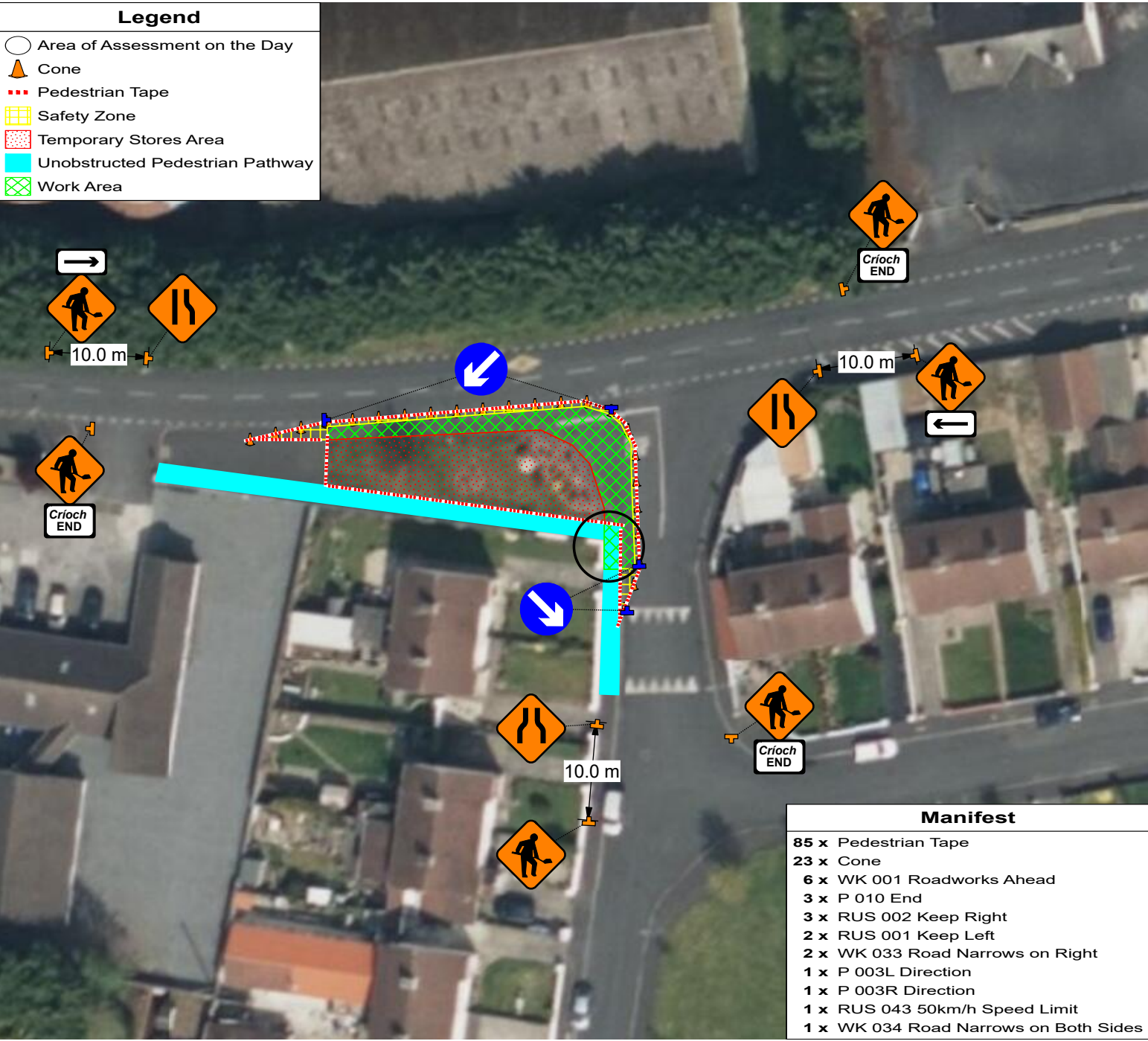

**Manifest**

- 85 x Pedestrian Tape
- 23 x Cone
- 6 x WK 001 Roadworks Ahead
- 3 x P 010 End
- 3 x RUS 002 Keep Right
- 2 x RUS 001 Keep Left
- 2 x WK 033 Road Narrows on Right
- 1 x P 003L Direction
- 1 x P 003R Direction
- 1 x RUS 043 50km/h Speed Limit
- 1 x WK 034 Road Narrows on Both Sides