

BALLICKMOYLER, CO. LAOIS

TEMPORARY TRAFFIC LIGHTS

LOCATION 1

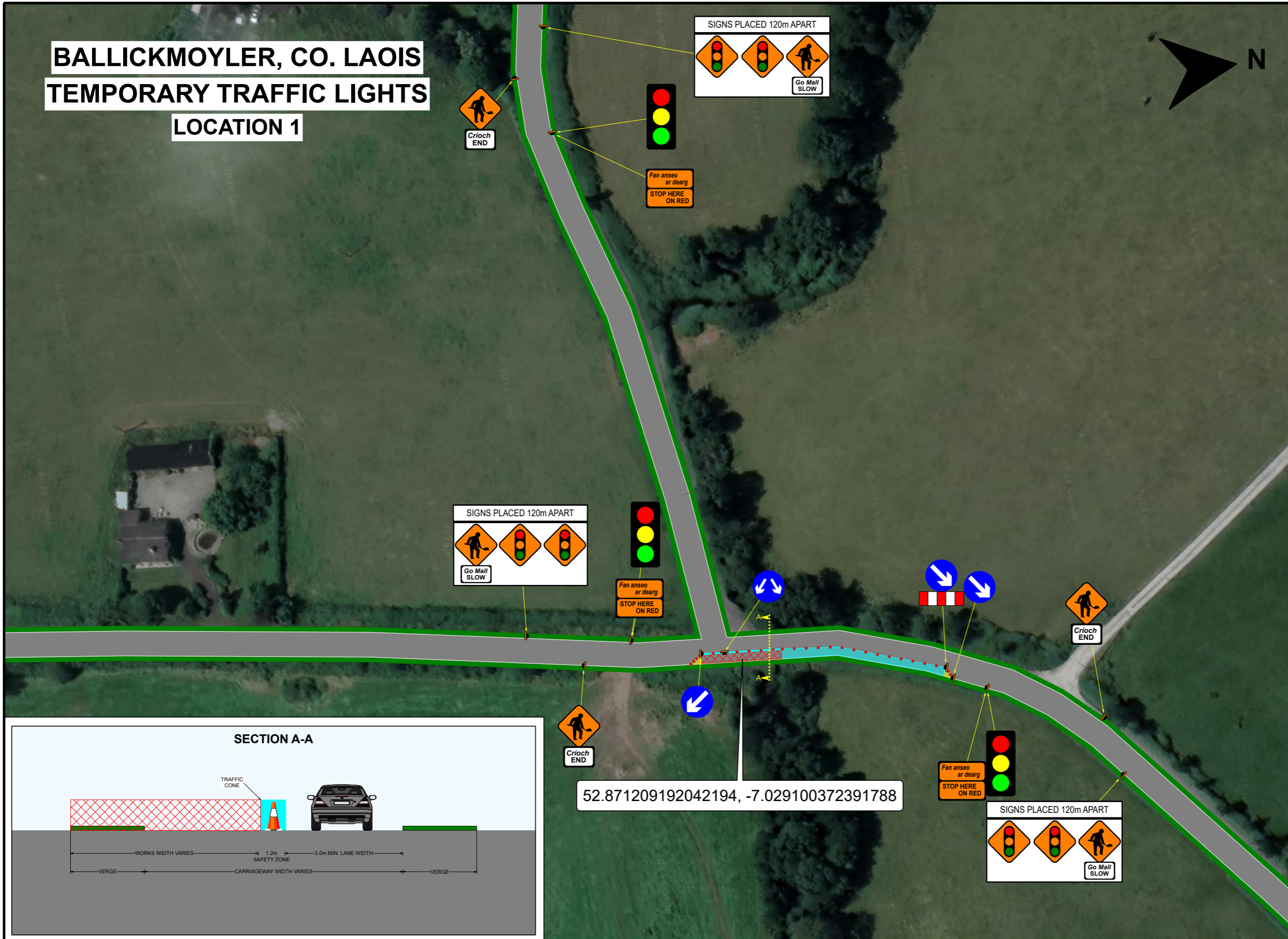

DESIGN PARAMETERS	
CHAPTER 8 ROAD LEVEL:	2(i)
SPEED LIMIT:	80km/h
ROADWORKS TYPE:	B
NUMBER OF ADVANCED SIGNS:	3
SIGN VISIBILITY:	90m
ADVANCED SIGNAGE DISTANCE:	120m
SIGNS SIZE RECTANGULAR - MIN:	600mm
SIGNS SIZE CIRCULAR - MIN:	750mm
CONE HEIGHT - MIN:	750mm
TAPER CONE SPACING:	3.0m
LONGITUDINAL CONE SPACING:	12m
RATE OF TAPER: LANE - 1 IN 40m 45°; HS - 1 IN 40m	
SAFETY ZONE: LONGITUDINAL - 45m; LATERAL - 1.2m	
UNOBSTRUCTED WIDTH:	3.3m
MAXIMUM LENGTH OF SUTTLE:	500m
MINIMUM LANE WIDTH:	3.0m
TM SYSTEM:	TEMPORARY TRAFFIC LIGHTS

SITE LOCATION

SITE SPECIFIC NOTES

--	--

Legend

	Cone		Safety Zone
	Taper		Temp Traffic Sign
	Work Area		

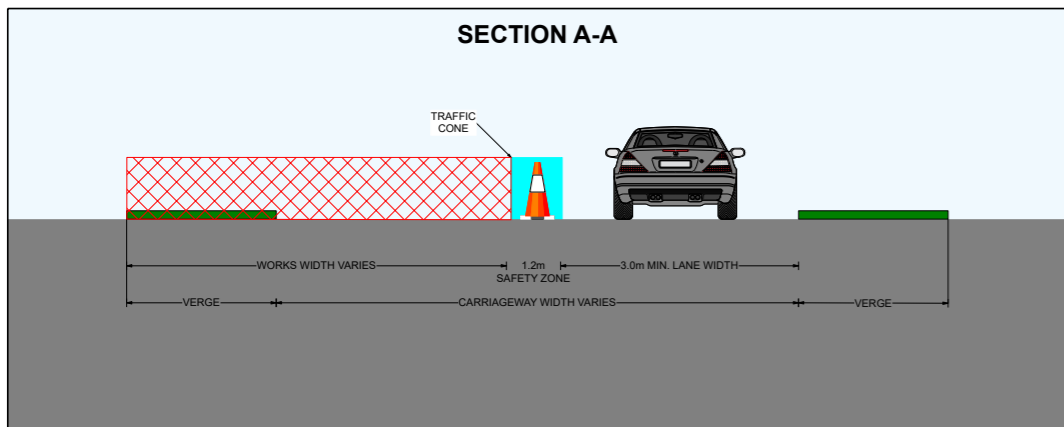

52.871209192042194, -7.029100372391788

COMPLETE HIGHWAY MAINTENANCE

DUBLIN OFFICE
UNIT 28, SECOND AVE
COOKSTOWN INDUSTRIAL
ESTATE, D24 H9PA
TALLAGHT, CO. DUBLIN
TEL: (01) 424 2070

CORK OFFICE
UNIT 6, WATERGRASSHILL
BUSINESS PARK,
T56 TD42
WATERGRASSHILL,
CO. CORK
TEL: (0) 21 488 9581

COPYRIGHT © 2024
THIS DRAWING AND ANY DESIGN HEREON IS THE COPYRIGHT OF CHM GROUP AND
MUST NOT BE REPRODUCED WITHOUT THEIR WRITTEN CONSENT. ALL DRAWINGS
REMAIN THE PROPERTY OF CHM GROUP.

- ### GENERAL NOTES
- 1) THIS TRAFFIC MANAGEMENT PLAN MAY ONLY BE IMPLEMENTED BY A TEMPORARY TRAFFIC OPERATIONS SUPERVISOR (TTOS) WHO MUST CARRY OUT A SITE RISK ASSESSMENT TO MODIFY (IF NECESSARY) THE MEASURES DESCRIBED TO SUIT ACTUAL SITE CONDITIONS BEFORE IMPLEMENTATION.
 - 2) THE TTOS MUST BE IN POSSESSION OF THE VALID CONSTRUCTION SKILLS REGISTRATION CARD 'SIGNING, LIGHTING, AND GUARDING AT ROADWORKS' CONSTRUCTION REGULATIONS 2006.
 - 3) THE TTOS TO DETERMINE EXACT POSITION OF SIGNS CONSIDERING THE SITE SPECIFICS.

- 4) IN ORDER THAT THE REQUIREMENTS AS SET PER SECTION 17(2) 2005 ACT ARE SATISFIED, FURTHER ALTERATION TO THE PLAN MUST BE ADVISED BY THE PSDP AS PER CONSTRUCTION REGULATIONS 2006 PS 5, REGS 16-17 AND REG 97 (2a & 2b) RESPECTIVELY. IN ADDITION THE PSCS SHOULD FURTHER DIRECT ANY CHANGES AS THE PROJECT PROGRESSES.
- 5) ALL WORKS ARE TO BE CARRIED OUT IN ACCORDANCE WITH LOCAL AUTHORITY REQUIREMENTS AND TO BE INCLUDED IN THE SITE SPECIFIC SAFETY & HEALTH PLAN.
- 6) MAINTENANCE CHECKS SHOULD BE CARRIED OUT AT REGULAR INTERVALS AND IN ACCORDANCE WITH CONTRACT SPECIFICATIONS.
- 7) TEMPORARY SIGNS SUPPORTS OR STANDS SHOULD BE DESIGNED IN ACCORDANCE WITH SPECIFICATION TS4.

- 8) CONTRACTOR TO CARRY OUT A SITE RISK ASSESSMENT PRIOR TO THE INSTALLATION OF THE TRAFFIC MANAGEMENT PLAN TO ENSURE THAT CONDITIONS REFLECT THOSE CONSIDERED FOR DESIGN POST SUBMISSION.
- 9) ALL SIGNS USED FOR THIS TRAFFIC MANAGEMENT PLAN MUST COMPLY WITH CHAPTER 8 OF TRAFFIC SIGNS MANUAL LATEST EDITION.
- 10) WK 052 / WK 053 TO BE USED WHEN A DESIGNATED WORKS ACCESS IS REQUIRED. REFER TO CH. 8 FOR USAGE. BANKSMEN TO MANAGE SITE ACCESS & EGRESS.
- 11) THE ABSOLUTE MINIMUM WIDTH ALLOWED FOR PEDESTRIANS IS 1.2M AND FOR A ONE-WAY CYCLE TRACKS IS 1.25M.

- 12) SAFETY BARRIERS USED FOR THIS TMP MUST COMPLY WITH TII DN-REQ-03034-1 IS EN 1317-1 e) TEMPORARY SAFETY BARRIER.
- 13) THE CONTRACTOR SHALL BE RESPONSIBLE FOR PROVIDING ALL REQUIRED RAMP ACCESS TO ALL CHANGES IN ROAD SURFACE LEVEL WHERE TRAFFIC RUNS ON A TEMPORARY SURFACE AND ALSO FOR CYCLE/PEDESTRIAN RAMP WHERE THERE IS A LEVEL DISCONTINUITY AS A RESULT OF THE WORKS ON CYCLE PATHS & FOOTPATHS.
- 14) ADDITIONAL SIGNS MAY BE USED TO COMPLEMENT THE SPECIFIC SIGNS USED AT THE ROADWORKS: WARNING SIGNS - YELLOW BACKGROUND - DESCRIBED IN CHAPTER 6. REGULATORY SIGNS - DESCRIBED IN CHAPTER 5, ETC. THEY ALL MUST COMPLY WITH THE SPECIFICATIONS OF 'TRAFFIC SIGNS MANUAL' AND 'TS4: GUIDELINES, CERTIFICATION SCHEME AND SPECIFICATION FOR CONSTRUCTION OF TRAFFIC SIGNS'.

REV	DESCRIPTION	DATE	REV/CHK BY	BY

CLIENT:

Laois County Council
Áras an Chontae, Portlaoise, Co. Laois

PROJECT:
BALLICKMOYLER, CO. LAOIS

TITLE:
TEMPORARY TRAFFIC LIGHTS

DIRECTOR: BE	PM: JM	CHECKED: CI
SCALE: N.T.S.	DRAWN BY: DB	DATE: 19/06/2024
STAGE: CONSTRUCTION		
DRAWING NO: EN 7087 - 000 - 001		

A3 (297x420mm)