

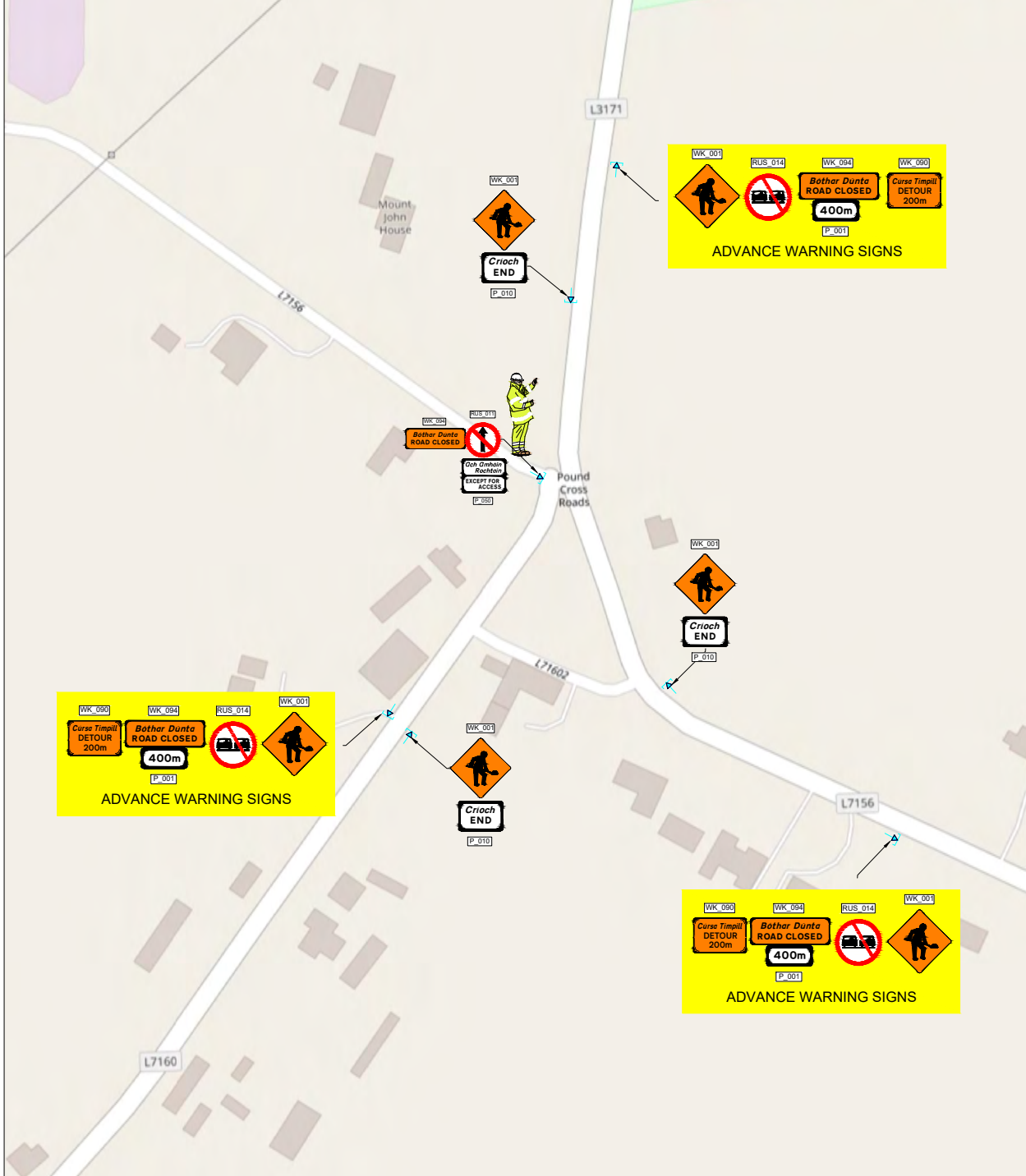

# WESTERN CLOSURE POINT



# EASTERN CLOSURE POINT



## CHAPTER 8 - ROAD LEVEL 2(i) 80km/h

Design Parameters	TYPE A >12 hours	TYPE B <12 hours	TYPE C <15 mins
Advance Warning Signs			
Sign Size (mm)	600	600	-
Sign Visibility (m)	90	90	90
No. of Signs	4	3	-
Cumulative Distance (m)	480	360	-
Distance between Advance Warning Signs (m)	120	120	-
Taper			
Lane Taper Rate	1 in 40	1 in 40	-
Hard Shoulder Taper Rate			
Cones			
Cone Height (mm)	750	750	-
Taper Spacing (m)	3	3	-
Longitudinal Spacing (m)	12	12	-
Lamps (unit areas only)			
Taper Spacing (m)	6	6	-
Longitudinal Spacing (m)	24	24	-
Safety Zones			
Longitudinal (m)	45	45	-
Lateral (m)	1.2	1.2	-
Lanes (minimum)			
Lane Width (m)	3	3	-

### TTM SYSTEM: ROAD CLOSURE & DETOUR

REV:	DESCRIPTION:	BY:	DATE:

KEY:

- SIGN MARKER
- CLOSED ROAD SECTION
- DETOUR ROUTE A
- DETOUR ROUTE B

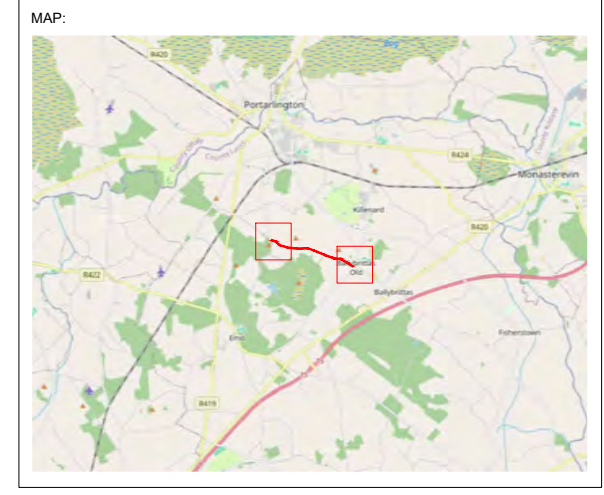

PROJECT: ROAD IMPROVEMENT

TITLE: GREENPARK ROAD CLOSURE & DETOUR WITH LOCAL ACCESS

CATEGORY: PLANNING

SCALE AT A3: NTS	DATE: 22/03/2024	DRAWN: NW	CHECKED: VS
---------------------	---------------------	--------------	----------------

DRAWING NO: D007-164-001a	REVISION: 0
------------------------------	----------------

DRAWING NOTES:

- L7156 GREENPARK ROAD TO BE CLOSED AT LOUGH CROSS TO THE WEST AND POUND CROSS TO THE EAST
- TMO REQUIRED AT EACH CLOSURE POINT TO ALLOW LOCAL ACCESS TRAFFIC ONLY

© Cinnte Safety Limited (2024)



### NOTES:

- Unless categorised as 'Construction', this Temporary Traffic Management Layout Drawing (TTMLD) has been prepared without a Site-Specific Site Survey Risk Assessment (SSRA) and must not be used for construction purposes until such time as a SSRA has been conducted to ensure all hazards have been identified and accounted for.
- The Temporary Traffic Management Contractor is required to have carried out a Dynamic On-Site Risk Assessment prior to the installation of this TTMLD to ensure that the conditions reflect those considered for the design
- This TTMLD has been prepared in accordance with the Traffic Signs Manual (2019), the Construction Regulations (2013), and any prevailing Road Authority Bye-Laws and Regulations
- If this TTMLD is categorised as 'Construction', it applies only to the Project and Location covered by a SSRA and detailed in the Title Block
- Construction drawings and SOP's are only to be installed when Traffic Flow Counts have been taken and the results are within the parameters set out in the Traffic Signs Manual (2019), DTTAS TTM Design Guidance, and DTTAS TTM Operations Manual
- The TTM Designer accepts no responsibility for the results where the Traffic Signs Manual (2019), DTTAS TTM Design Guidance and DTTAS TTM Operations Manual have not been adhered to in their entirety
- Any alteration other than by the TM Designer renders this TTMLD and any information herein void
- Any Reproduction or Copying of this TTMLD is strictly prohibited unless written permission is given by the TM Designer
- Where a site-specific survey has not been carried out by Cinnte Safety Ltd, the Company does not accept the appointment as TM Designer for the project. Any TTMLD produced by Cinnte Safety Ltd is for the Preliminary Safety Plan only and must be developed by a TM Designer appointed by the Main Contractor





# DETOUR ROUTES

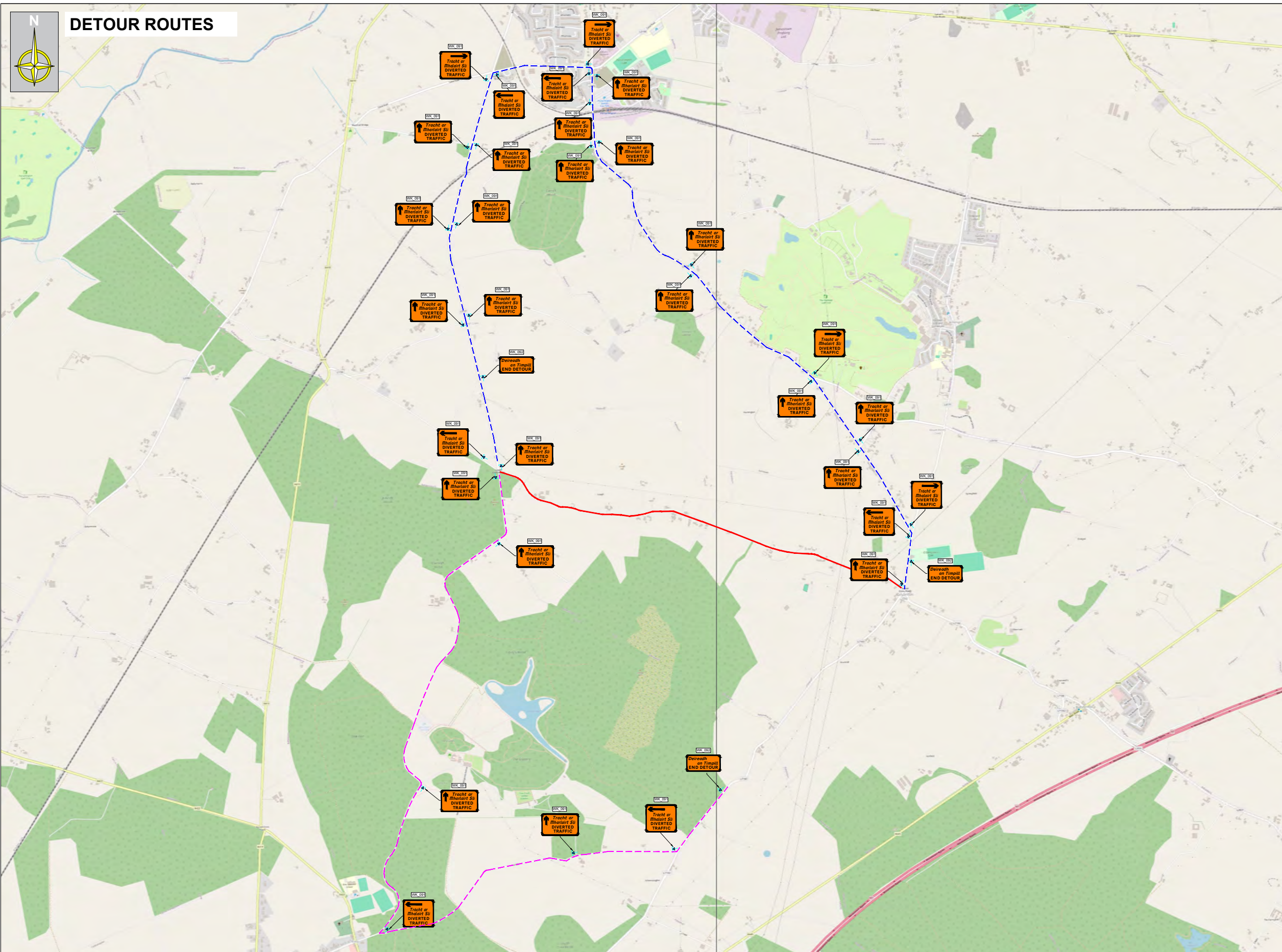

CHAPTER 8 - ROAD LEVEL 2(i) 80km/h			
Design Parameters	TYPE A >12 hours	TYPE B <12 hours	TYPE C <15 mins
Advance Warning Signs			
Sign Size (mm)	600	600	-
Sign Visibility (m)	90	90	90
No. of Signs	4	3	-
Cumulative Distance (m)	480	360	-
Distance between Advance Warning Signs (m)	120	120	-
Taper			
Lane Taper Rate	1 in 40	1 in 40	-
Hard Shoulder Taper Rate			
Cones			
Cone Height (mm)	750	750	-
Taper Spacing (m)	3	3	-
Longitudinal Spacing (m)	12	12	-
Lamps (unit areas only)			
Taper Spacing (m)	6	6	-
Longitudinal Spacing (m)	24	24	-
Safety Zones			
Longitudinal (m)	45	45	-
Lateral (m)	1.2	1.2	-
Lanes (minimum)			
Lane Width (m)	3	3	-

### TTM SYSTEM: ROAD CLOSURE & DETOUR

REV:      DESCRIPTION:      BY:      DATE:

#### KEY:

- SIGN MARKER
- CLOSED ROAD SECTION
- DETOUR ROUTE A
- DETOUR ROUTE B

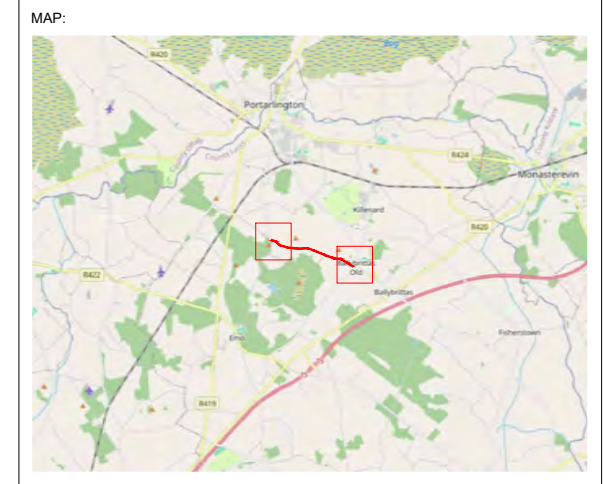

CLIENT:

PROJECT: **ROAD IMPROVEMENT**

TITLE: **GREENPARK ROAD CLOSURE & DETOUR WITH LOCAL ACCESS**

CATEGORY: **PLANNING**

SCALE AT A3:	DATE:	DRAWN:	CHECKED:
NTS	22/03/2024	NW	VS

DRAWING NO:	REVISION:
D007-164-001b	0

© Cinnte Safety Limited (2024)



#### NOTES:

- Unless categorised as 'Construction', this Temporary Traffic Management Layout Drawing (TTMLD) has been prepared without a Site-Specific Site Survey Risk Assessment (SSRA) and must not be used for construction purposes until such time as a SSRA has been conducted to ensure all hazards have been identified and accounted for.
- The Temporary Traffic Management Contractor is required to have carried out a Dynamic On-Site Risk Assessment prior to the installation of this TTMLD to ensure that the conditions reflect those considered for the design
- This TTMLD has been prepared in accordance with the Traffic Signs Manual (2019), the Construction Regulations (2013), and any prevailing Road Authority Bye-Laws and Regulations
- If this TTMLD is categorised as 'Construction', it applies only to the Project and Location covered by a SSRA and detailed in the Title Block
- Construction drawings and SOP's are only to be installed when Traffic Flow Counts have been taken and the results are within the parameters set out in the Traffic Signs Manual (2019), DTTAS TTM Design Guidance, and DTTAS TTM Operations Manual
- The TTM Designer accepts no responsibility for the results where the Traffic Signs Manual (2019), DTTAS TTM Design Guidance and DTTAS TTM Operations Manual have not been adhered to in their entirety
- Any alteration other than by the TM Designer renders this TTMLD and any information herein void
- Any Reproduction or Copying of this TTMLD is strictly prohibited unless written permission is given by the TM Designer
- Where a site-specific survey has not been carried out by Cinnte Safety Ltd, the Company does not accept the appointment as TTM Designer for the project. Any TTMLD produced by Cinnte Safety Ltd is for the Preliminary Safety Plan only and must be developed by a TM Designer appointed by the Main Contractor