

LAOIS COUNTY COUNCIL COMPULSORY PURCHASE ORDER

Lands Proposed to be Compulsorily Acquired by Laois County Council shown outlined in Red (not registered with the Land Registry)

No. 33 Sarsfield Street, Mountmellick, Co. Laois. R32 C586 (Site SS 33)
 Area Within Red Boundary Line = 870.21 Sq.M. (0.087 Hectares) approx
 X = 6453311 Y = 707427

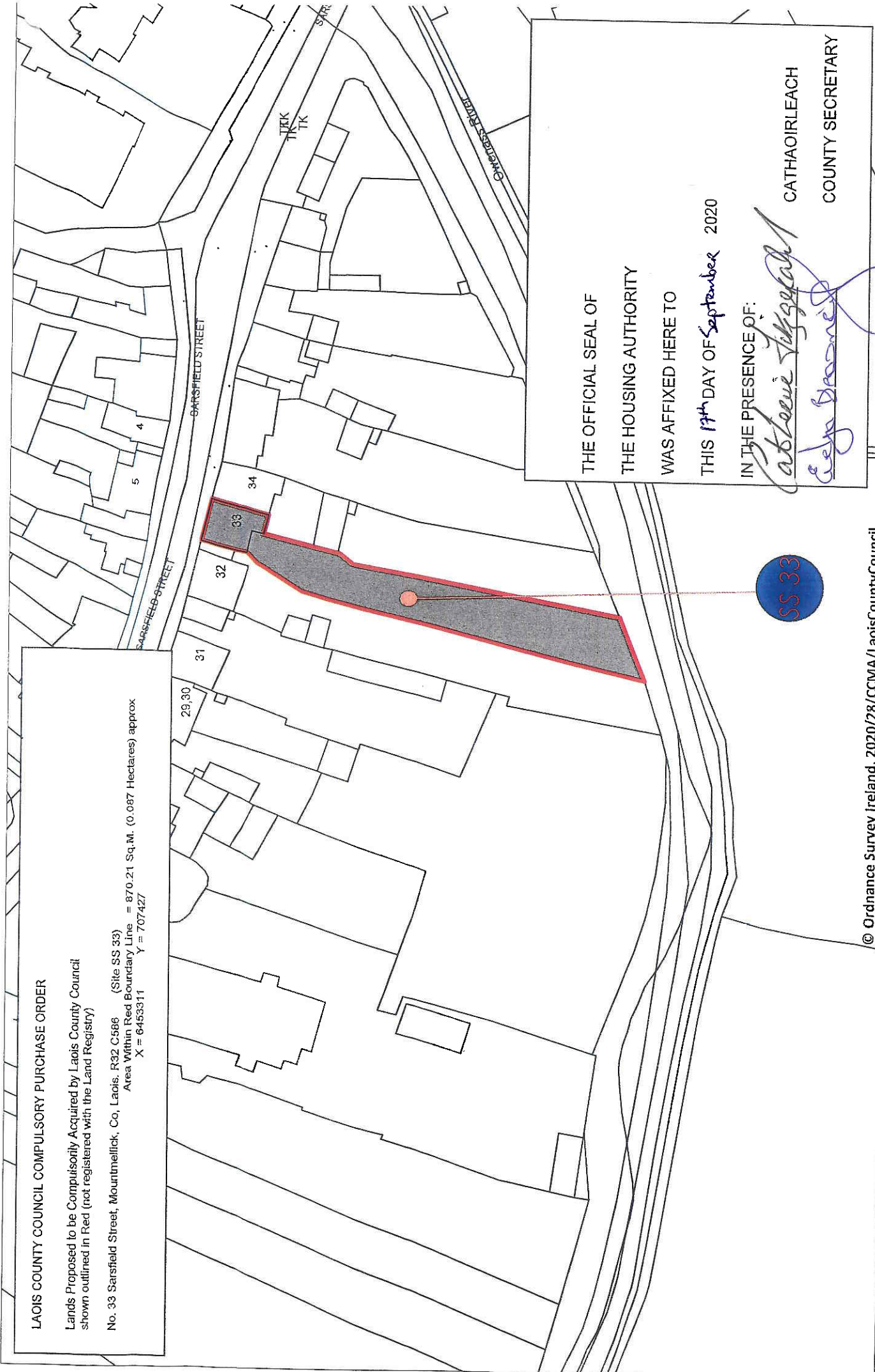

THE OFFICIAL SEAL OF
 THE HOUSING AUTHORITY
 WAS AFFIXED HERE TO

THIS 19th DAY OF September 2020

IN THE PRESENCE OF:

Caroline Fitzgerald

Seán Brennan

CATHAOIRLEACH
 COUNTY SECRETARY

© Ordnance Survey Ireland, 2020/28/CCMA/LaoisCountyCouncil

LAOIS COUNTY COUNCIL

HOUSING SECTION,
 COUNTY HALL,
 PORTLACISE,
 CO. LAOIS.
 PHONE: (057) 864000

REVISION:	DESCRIPTION:	DATE:

DRAWING TITLE:
 No. 33 Sarsfield Street,
 Mountmellick,
 Co. Laois.
 R32 C586

Scale: 1:1000
 Drawn By: CK
 Date: 08/09/2020
 Checked By: PL
 Ref: 2020-01
 Sheet Size: A4
 Drawing No.:
 Ref. File: CPO-LS-SS33

