

L-3817-4 Cappakeel, Co. Laois
ROAD CLOSED

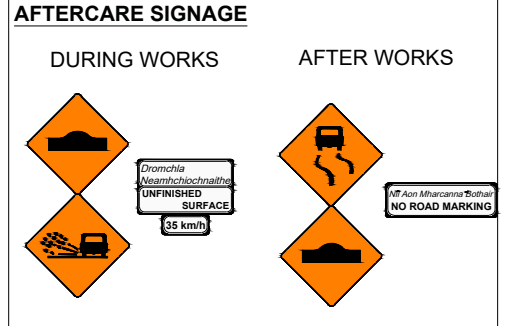
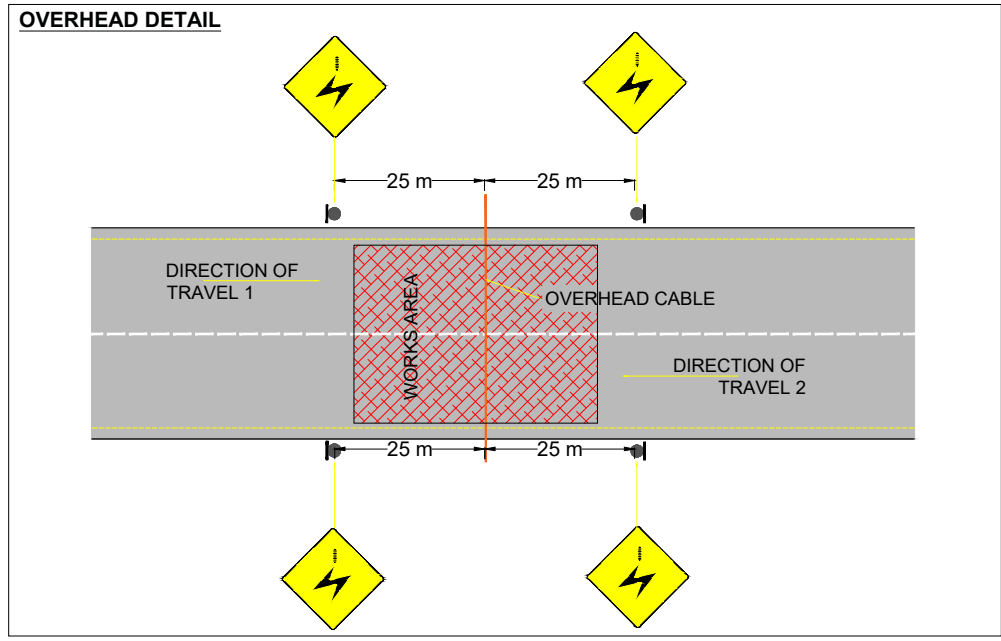

NO TIP ZONE MINIMUM CLEARANCE

Nominal phase-to-phase voltage of overhead line	Minimum lateral clearance in metres
LV conductors	1.0
10kV, 20kV and 38kV	3.0
110kV	4.5
220kV	6.0
400kV	8.0

ROAD CONTROL

Copyright Notes:
 This drawing is the property of Road Control Services Ltd. The design information contained herein is strictly confidential. This document is not to be used, reproduced, disclosed or circulated in whole or in part without prior written consent.

CLIENT

CARROLL QUARRY LTD

DESIGN PARAMETERS

Advance Warning Signage	
Sign size	600mm
Sign Visibility	50m
Number of Signs	2
Cumulative Distance	40m
Distance between Advance Warning Signs	20m
Taper	
Lane Taper Rate	N/A
Hard Shoulder Taper Rate	N/A

Speed Limit		Road Classification	Type B 1(iii)
			<12hours
Cones		Cone Height	750mm
		Taper Spacing	3m
		Longitudinal Spacing	3m
Safety Zones		Longitudinal	5m
		Lateral	0.5m
Lanes		Lane Width	3.0m

LEGEND

- Works Area
- Traffic sign
- Traffic cones

GENERAL NOTES

- All information contained in this drawing (including digital data) should be checked and verified prior to any stage of construction;
- All works are to be carried out in accordance with local authority requirements and are to be included in the site-specific safety & health plan;
- Site inspections and maintenance of the traffic management layout is to be agreed with local authority to ensure the safety and integrity of the design;
- Contractor to carry out a site risk assessment prior to the installation of any traffic management plan to ensure that conditions reflect those considered for design post submission;
- Contractor shall be responsible for the provision of ramp access at any change in road surface level where traffic runs on a temporary surface, and for pedestrian/cycle ramps where footpath/bicycle-ways have a level discontinuity as per result of the works.

Rev	Date	Details	Drn	Chk	App	Drn	DJ
						Chk	MA
						App	DH
						Date	13-06-2024
						Scale	NTS @A3
						Stage	CONSTRUCTION

Project

L-3817-4 Cappakeel, Co. Laois

Title

TEMPORARY TRAFFIC MANAGEMENT PLAN ROAD CLOSED

Drawing No C24028_37_001 Rev 0