



Date: 17/11/2023 **Author:** THM/JC **Project:** KLS5491

Comments:

Traffic Management Plan to enable KLS with works at Towleron in Co. Laois. Stop & Go

Legend

- Cone
- Lat. Safety Zone
- Long. Safety Zone
- Taper
- Works Area

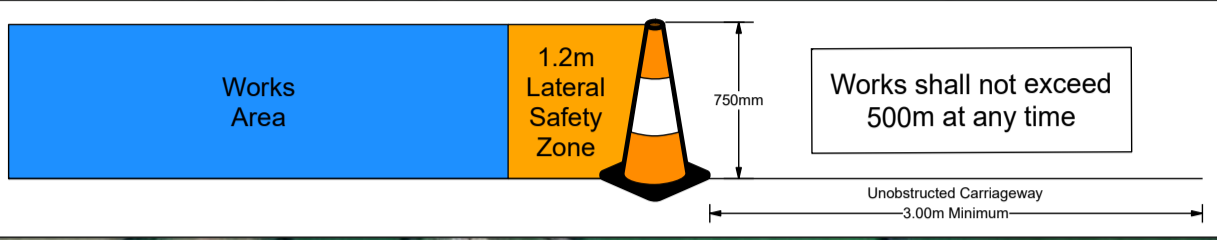

Table 2.2.2.1: Minimum Design Parameters for Level 2(i) Roads Single Carriageway 80km/h

| Design Parameter | Type A > 12 hours | Type B < 12 hours | Type C < 15 mins |
|--|----------------------|----------------------|---------------------|
| Advance Warning Signage | | | |
| Sign Size (mm) | 600 | 600 | - |
| Sign Visibility (m) | 90 | 90 | 90 |
| Number of Signs | 4 | 3 | - |
| Cumulative Distance (m) | 480 | 360 | - |
| Distance between advance warning signs (m) | 120 | 120 | - |
| Taper | | | |
| Lane Taper Rate ^A | 1 in 40 | 1 in 40 | - |
| Hard Shoulder Taper Rate ^A | - | - | - |
| Cones | | | |
| Cone Height (mm) | 750 | 750 | - |
| Taper Spacing (m) ^B | 3 | 3 | - |
| Longitudinal Spacing (m) ^B | 12 | 12 | - |
| Lamps (unlit areas only) | | | |
| Taper Spacing (m) | 6 | 6 | - |
| Longitudinal Spacing (m) | 24 | 24 | - |
| Safety Zones | | | |
| Longitudinal (m) | 45 | 45 | - |
| Lateral (m) | 1.2 | 1.2 | - |
| Lanes | | | |
| Lane Width (m) ^C | 3 | 3 | - |

Notes:
 A. 45° taper is required at shuttle traffic controlled layouts with cones at 1m centres
 B. Cone spacing is the maximum permitted. Where geometry or any other site-specific reason dictates the spacing shall be reduced accordingly.
 C. The optimum lane width for all classes of vehicles is 3.3m. This may be reduced to a minimum of 3m. Below this, HGVs and buses must be marshalled past the works. The absolute minimum lane width, if only cars and light vehicles are present, is 2.5m. See Section 0.4.3.4.

Note 1: Written dimensions are preferred, do not scale dimensions. All dimensions to be checked before work commences and any discrepancies reported. All traffic Management to be carried out in accordance with Chapter 8 of the Traffic Signs Manual in force at time of construction.
Note 2: All signage to be erected outside visibility plays at junctions and site access.
Note 3: Traffic Management will be audited and monitored in order to ensure safety and adequate traffic manoeuvrability. Should changes be required, drawings will be revised accordingly.
Note 4: Interaction with local residents and landowners will be carried out by the main contractor.
Note 5: All lighting requirements within the works area will be the responsibility of the main contractor.

NB. When flagmen are used, and subject to a risk assessment, the lateral safety zone may be reduced from 1.2m to 0.5m

Roadworks End signage shall be placed 20m-50m after works

Use reduced signage/sign spacing on narrow cul-de-sac

Use reduced signage/sign spacing on narrow approach road

Works Area Detail

Manifest

- 27 x Cone
- 10 x WK 001 Roadworks Ahead
- 9 x WK 061 Flagman Ahead
- 6 x RUS 001 Keep Left
- 5 x P 010 End
- 4 x P 003L Direction
- 4 x WK 095 Stop Here on Red
- 3 x RUS 060 Stop and Go Disk - STOP
- 3 x RUS 061 Stop and Go Disk - GO
- 3 x RUS014 No Overtaking
- 2 x RUS 002 Keep Right
- 1 x W 185 Barrier Board

