

# Kyle, Rathdowney, County Laois - Road Closure and Diversion

## Designs Parameters:

Type B Works, Single Carriageway  
Level 3, Speed Limit 80km/h

Design Parameters	Roadworks Type A (Full-Time)	Roadworks Type B (Part-Time)	Roadworks Type C (Short Duration)
Speed Limit	80 km/h or 100 km/h	80 km/h or 100 km/h	80 km/h or 100 km/h
Temporary Signs			
Sign Visibility (m)	120	120	120
Number of Signs	4	3	3
Cumulative Distance (m)	800	600	600
Distance between advance signs (m)	200	200	200
Minimum Rate of Taper			
Taper at Lane (m)	1 in 55	1 in 40	1 in 40
Taper at Hard Shoulder (m)	1 in 30	1 in 20	1 in 20
Maximum Lamp Spacing			
At Taper (m)	6	6	6
Longitudinal (m)	12	12	12
Maximum Cone Spacing			
At Tapers (m)	3	3	3
Longitudinal (m)	12	12	12
Cone Height (mm)	750	750	750
Safety Zone			
Longitudinal (m)	80	45	45
Lateral (m)	1.2	1.2	1.2
Minimum Lane Width			
Min Lane Width (m)	3.0	3.0	3.0

## General Notes:

- All signs to be in accordance with Chapter 8 of TSM Guidance Document.
- Signs to be placed so as not to cause obstruction to road users and pedestrians.
- Safety Zones to be in accordance with Chapter 8 and maintained at all times.
- An Garda Síochána to be notified prior to works commencing.
- Any changes to TM Plan undertaken on site must be communicated to and approved by PSCS and PSDP.

## Site Specific Notes:

## Legend:

- Diversion Route
- Road Closed
- Sign Symbol

Ordnance Survey Ireland Licence No. EN 0063609  
 i AUI: a) & AUI: i c^ a^ AUI: a) a) a) ( c^ a) ( c^ a) ( c^ a) a) a)

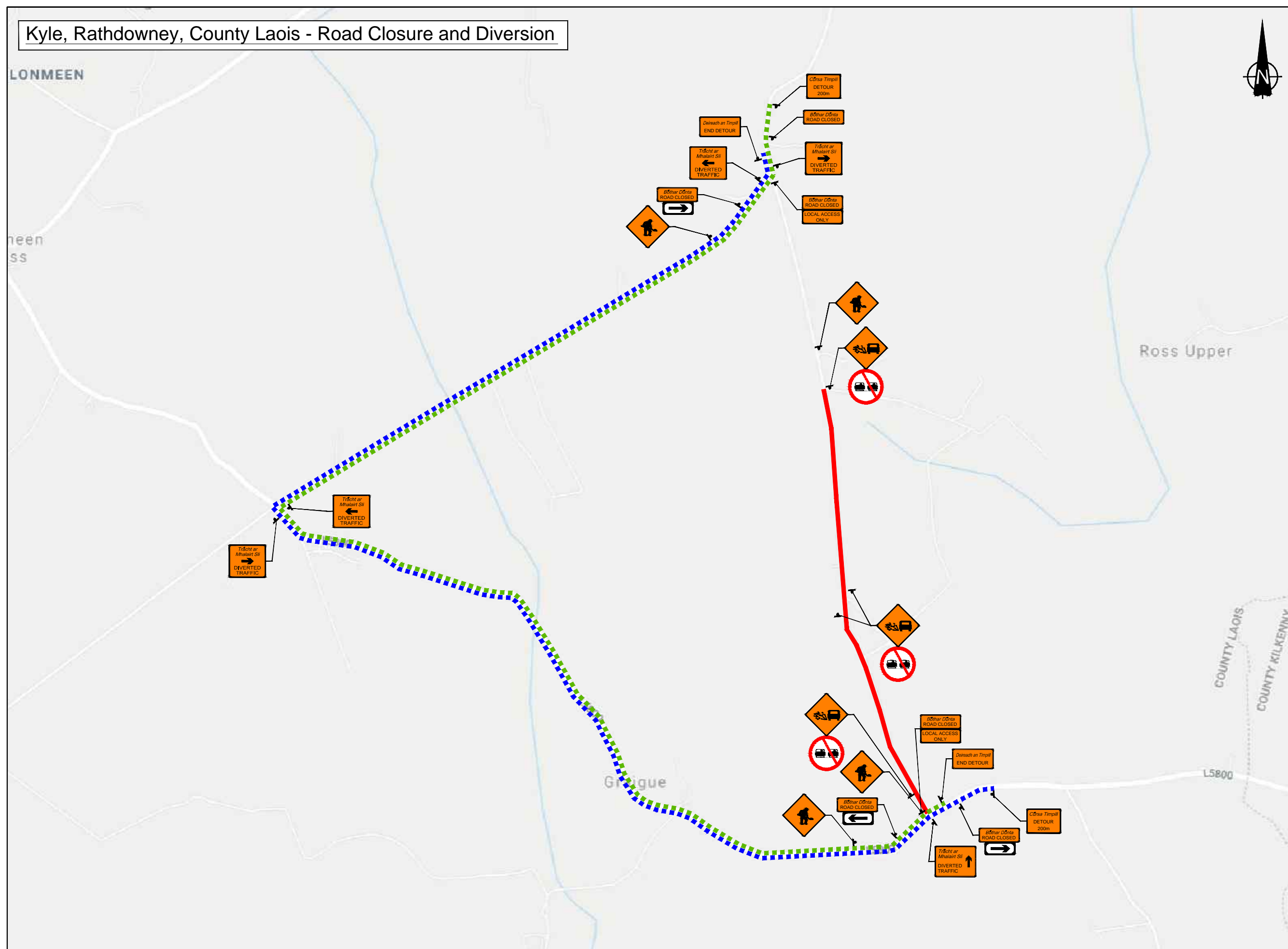

**VIAE LTD**  
 Dolcain House, Monastery Road  
 Clondalkin, Dublin 22  
 T: +353 (1) 4033248  
 Email: info@viae.ie  
 Web: www.viae.ie



Project Title:  
**Micro-Surfacing Works  
 County Laois**

Drawing Title:  
**Temporary Traffic Management Layout  
 For Road Closure and Diversion  
 Kyle, Rathdowney**

Revision Details Box

Rev. No.	Comments

Detail Box

Drawn:	Scale:	Drawing no.:
PB	not to scale	TMD/2019/2158/BX001
Approved:	Date:	Rev:
SS	06.09.2019	0

# Kyle, Rathdowney, County Laois - Road Closure and Diversion

## Designs Parameters:

Type B Works, Single Carriageway  
Level 3, Speed Limit 80km/h

Design Parameters	Roadworks Type A (Full-Time)	Roadworks Type B (Part-Time)	Roadworks Type C (Short Duration)
Speed Limit	80 km/h or 100 km/h		80 km/h or 100 km/h
Temporary Signs			
Sign Visibility (m)	120		120
Number of Signs	4		3
Cumulative Distance (m)	800		600
Distance between advance signs (m)	200		200
Minimum Rate of Taper			
Taper at Lane (m)	1 in 55		1 in 40
Taper at Hard Shoulder (m)	1 in 30		1 in 20
Maximum Lamp Spacing			
At Taper (m)	6		6
Longitudinal (m)	12		12
Maximum Cone Spacing			
At Tapers (m)	3		3
Longitudinal (m)	12		12
Cone Height (mm)	750		750
Safety Zone			
Longitudinal (m)	80		45
Lateral (m)	1.2		1.2
Minimum Lane Width			
Min Lane Width (m)	3.0		3.0

## General Notes:

- All signs to be in accordance with Chapter 8 of TSM Guidance Document.
- Signs to be placed so as not to cause obstruction to road users and pedestrians.
- Safety Zones to be in accordance with Chapter 8 and maintained at all times.
- An Garda Síochána to be notified prior to works commencing.
- Any changes to TM Plan undertaken on site must be communicated to and approved by PSCS and PSDP.

## Site Specific Notes:

## Legend:

- Diversion Route
- Road Closed
- Sign Symbol

Ordnance Survey Ireland Licence No. EN 0063609  
 T: AUI: a) & AUI: r^\* AUI: a) a) a) ( r^\* ) ( ^ ) a) a) a) a)

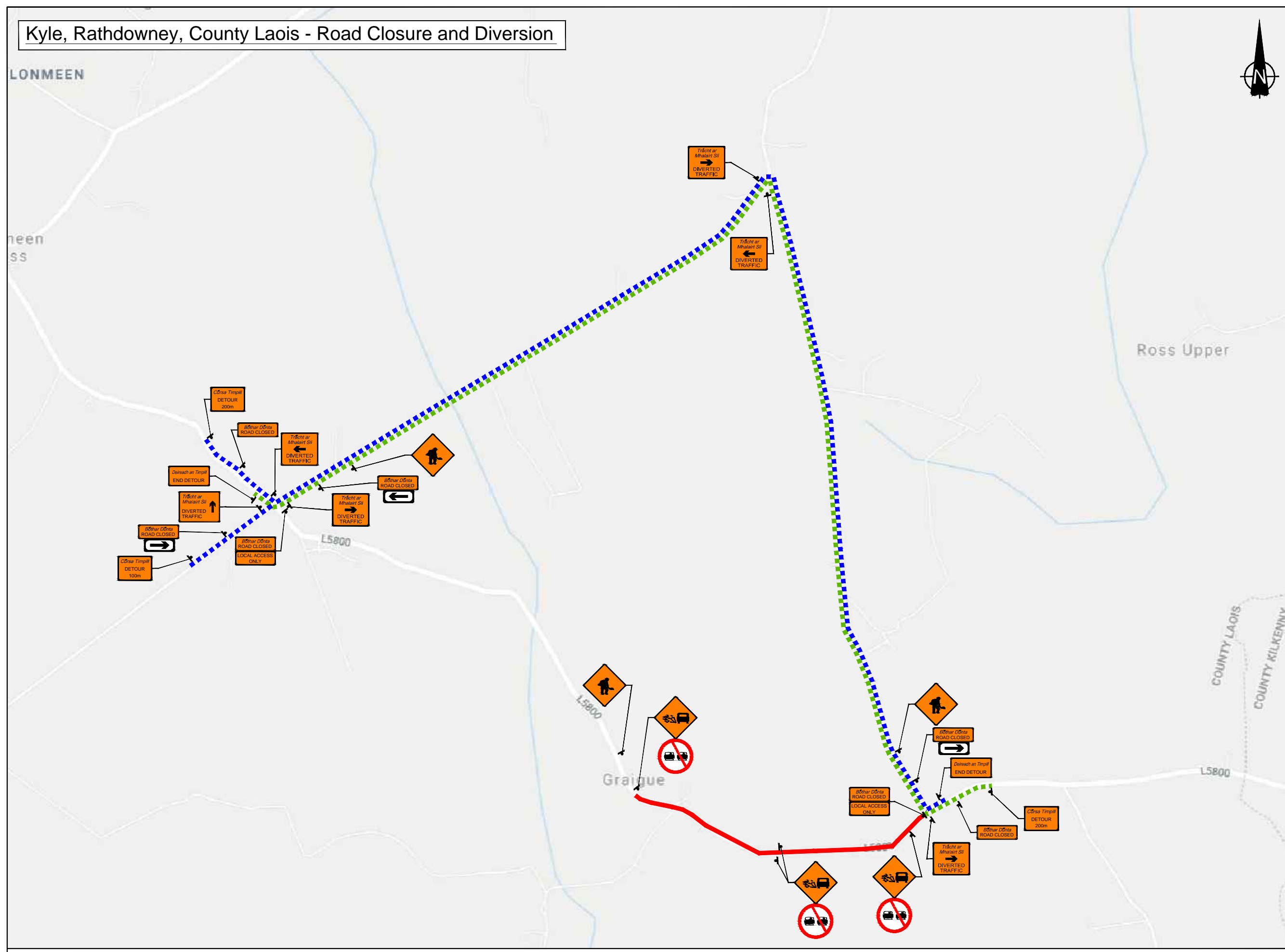

**VIAE LTD**  
 Dolcain House, Monastery Road  
 Clondalkin, Dublin 22  
 T: +353 (1) 4033248  
 Email: info@viae.ie  
 Web: www.viae.ie



Client:  
 Project Title:  
**Micro-Surfacing Works  
 County Laois**

Drawing Title:  
**Temporary Traffic Management Layout  
 For Road Closure and Diversion  
 Kyle, Rathdowney**

Revision Details Box	
Rev. No.	Comments

Detail Box		
Drawn:	Scale:	Drawing no.:
PB	not to scale	TMD/2019/2158/BX002
Approved:	Date:	Rev:
SS	06.09.2019	0