

07

Lesson Plan

Score your school for bees

Suitable for Junior Infants to 6th Class

Use our School Resources at www.pollinators.ie/schools including the Junior Pollinator Plan (also available in Irish) and the 'How-to-guide: Develop a Pollinator Plan for your School'

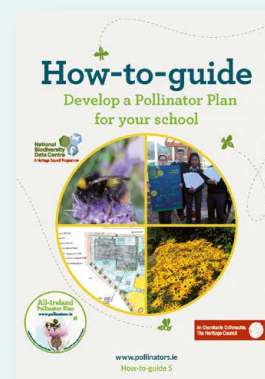

Objectives

In this lesson, students will:

- ✓ Learn to assess and score areas of the school yard or a local park in terms of providing food, shelter or safety for pollinators.
- ✓ Fill in score charts.
- ✓ Design charts and tables to show their results.
- ✓ Learn to use data to produce a pollinator-friendly score for their school.

Background:

- ✓ In Lesson Plan 4, the students learned what pollinators need to survive: food shelter and safety.
- ✓ In lesson 5, they used that knowledge to map the school grounds.
- ✓ (Not all schools will have a school garden, so this activity can also be done in a local park, on a field trip, or in their own gardens at home).



Activity:

Using your map, work in groups to score your school grounds according to how pollinator-friendly it is.

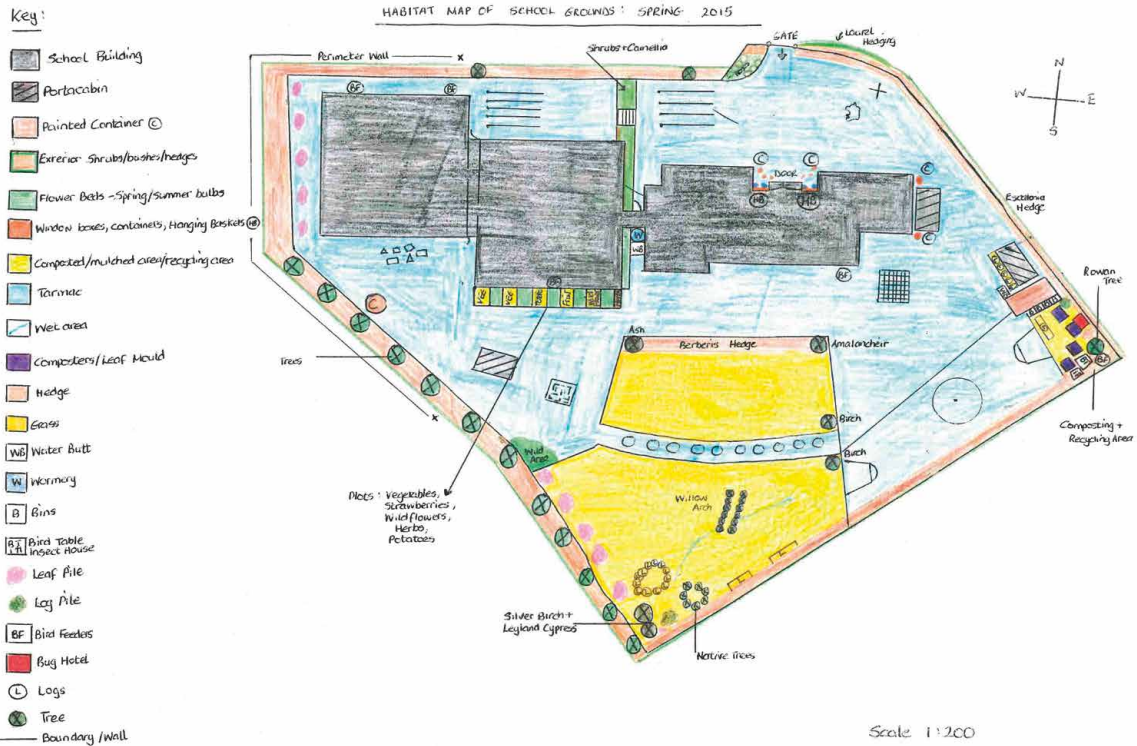

Your School's Pollinator Score (out of 100):

	Food total	<input type="text"/>
	Shelter total	<input type="text"/>
	Safety total	<input type="text"/>
	Your school's overall pollinator-friendly score	<input type="text"/>

Use your map to Rate your school for pollinators!





🌻 Food (60 points)		Score
Are there areas with wildflowers, such as Dandelions or Clover?	(out of 10 points)	
Do you have native hedgerows around your school that provide flowers (food) for pollinators	(out of 10 points)	
Areas with bramble	(out of 5 points)	
Areas with Ivy	(out of 5 points)	
Pollinator-friendly trees, e.g. apple tree	(out of 10 points)	
Pollinator-friendly flower bed, windowboxes, hanging baskets or planters.	(out of 10 points)	
Herb garden	(out of 5 points)	
fruit/vegetable garden	(out of 5 points)	
Total Food score =		

🏠 Shelter (20 points)		Score
Bumblebees	Areas with long grass	(out of 10 points)
Solitary mining bees	south/east-facing banks of bare soil	(out of 5 points)
Solitary cavity-nesting bees	bug hotels or holes in wood, or stone walls for cavity-nesting bees	(out of 5 points)
Total Shelter score =		

🛡️ Safety (20 points)		Score
Are pesticides used?	No pesticides used	Score 10 points
	Herbicide is used but no insecticides	Score 5 points
	Both insecticides and herbicides are used	Score 0 points
Total Safety score =		



Your School's Pollinator Score (out of 100):

	Food total	<input type="text"/>
	Shelter total	<input type="text"/>
	Safety total	<input type="text"/>
	Your school's overall pollinator-friendly score	<input type="text"/>

Create a graph to show your results

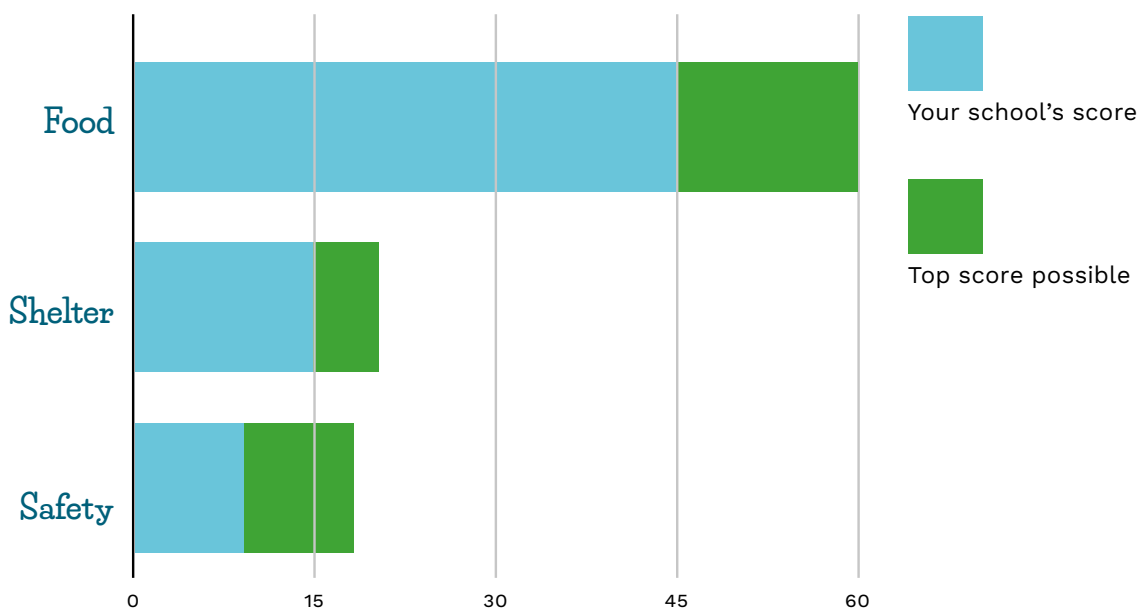

Create a scale illustration to show your results

Poor

Good

Excellent!

