

APPENDIX 1: MAP OF MOUNTMELICK CANAL, 1837-39

Ordnance Survey 1:10,560 maps, Co Laois sheets 4, 5 and 9 (rescaled)
Co Kildare section not shown

The maps are arranged from west to east

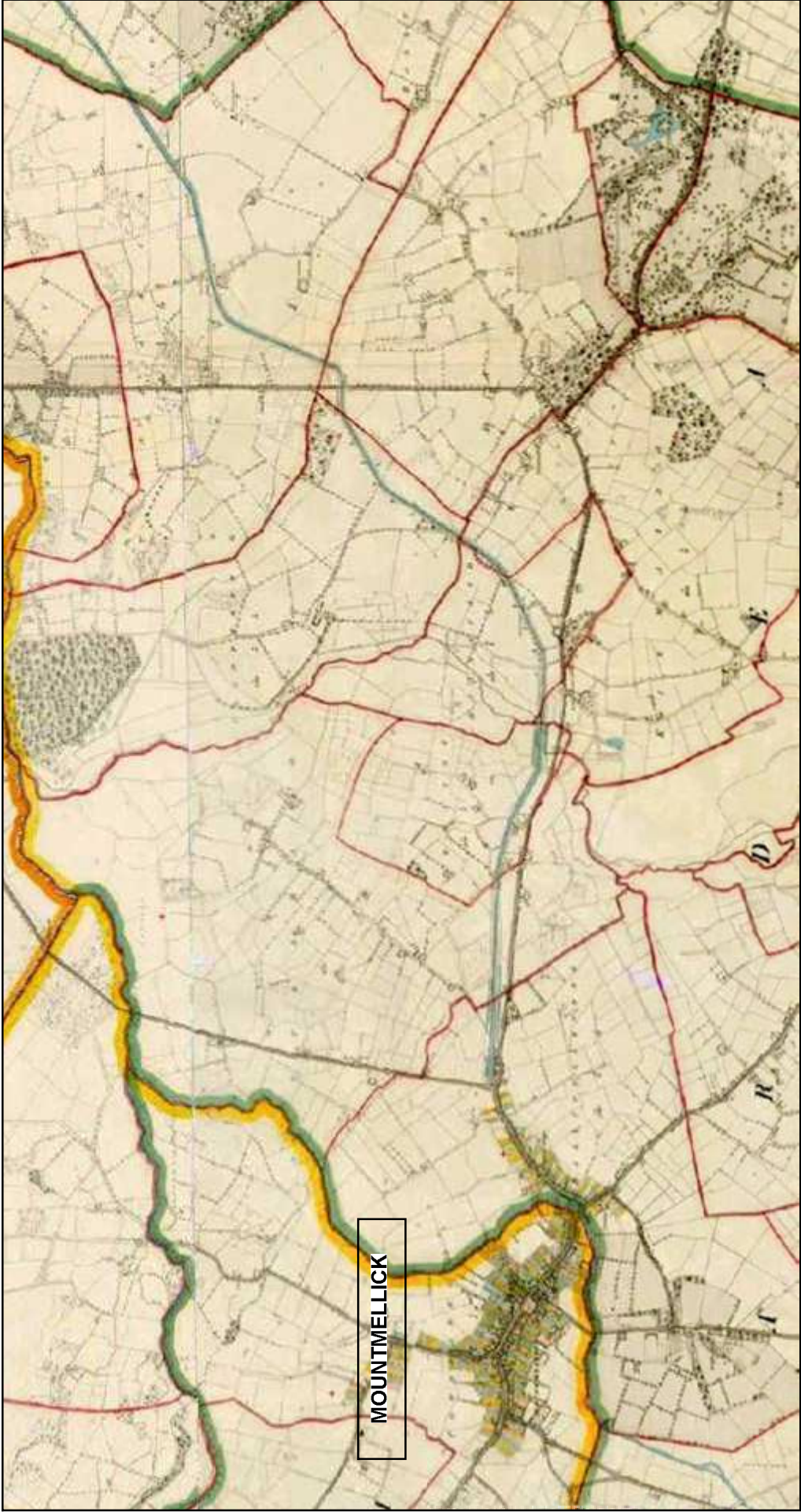

MOUNTMELICK

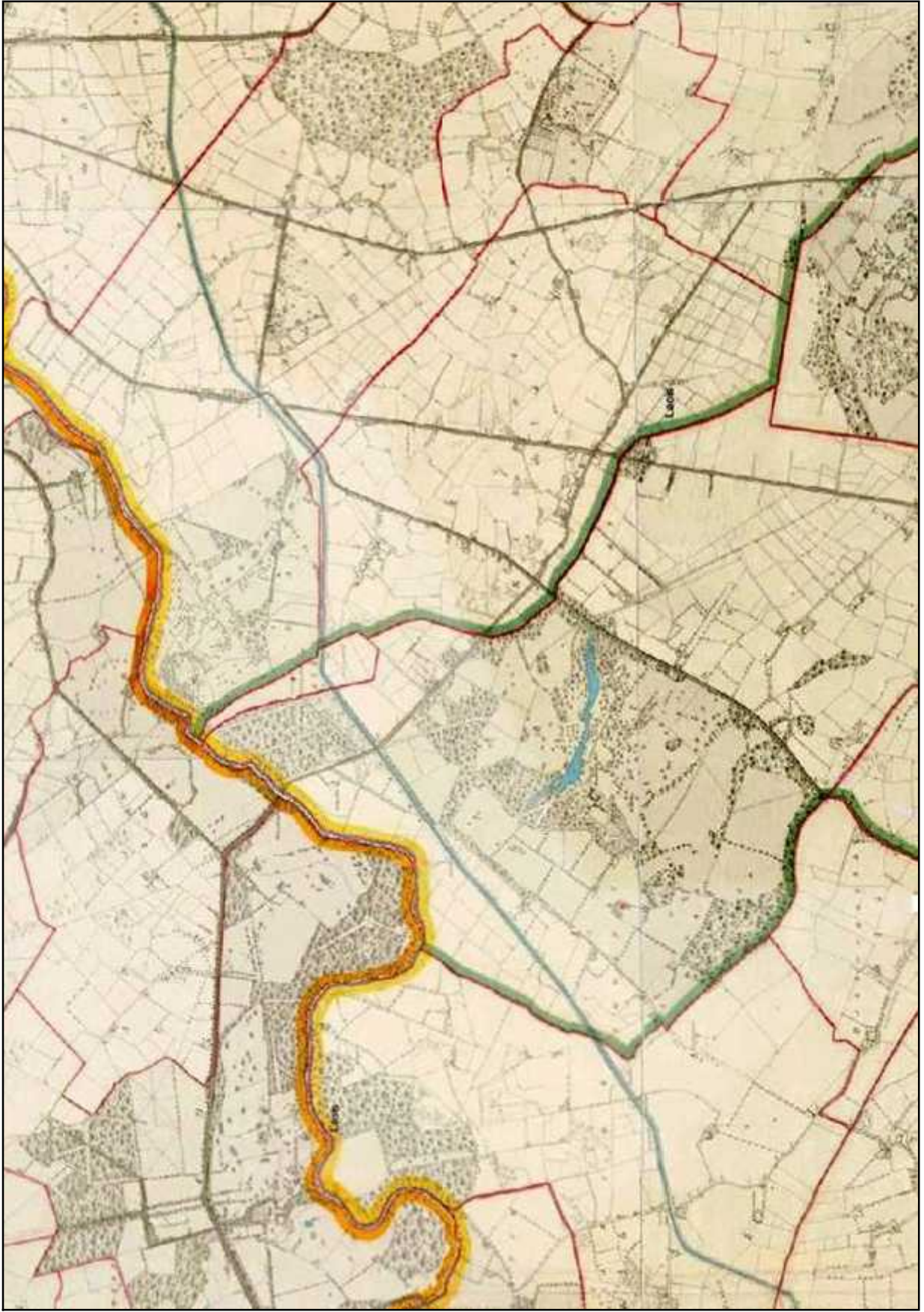

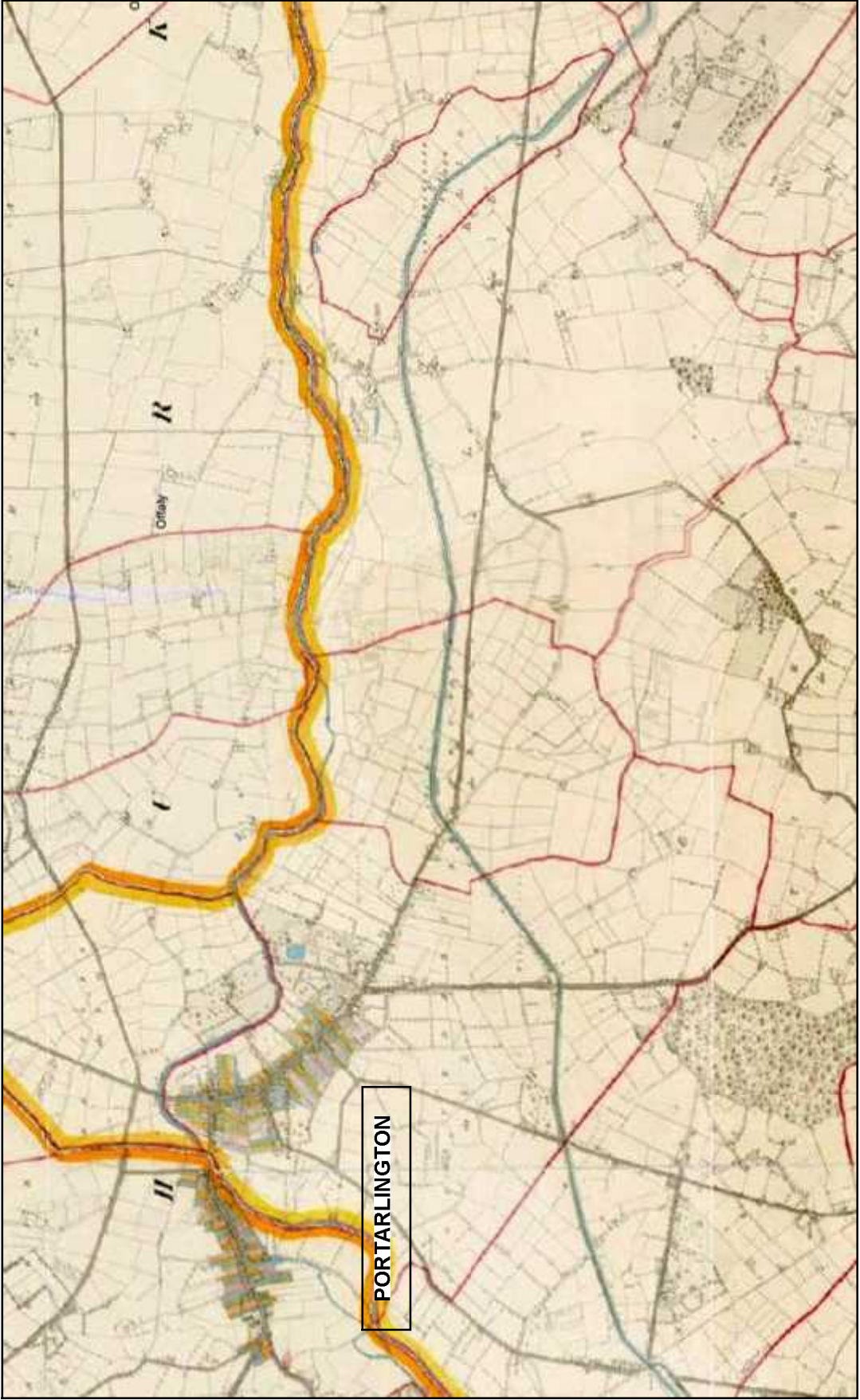

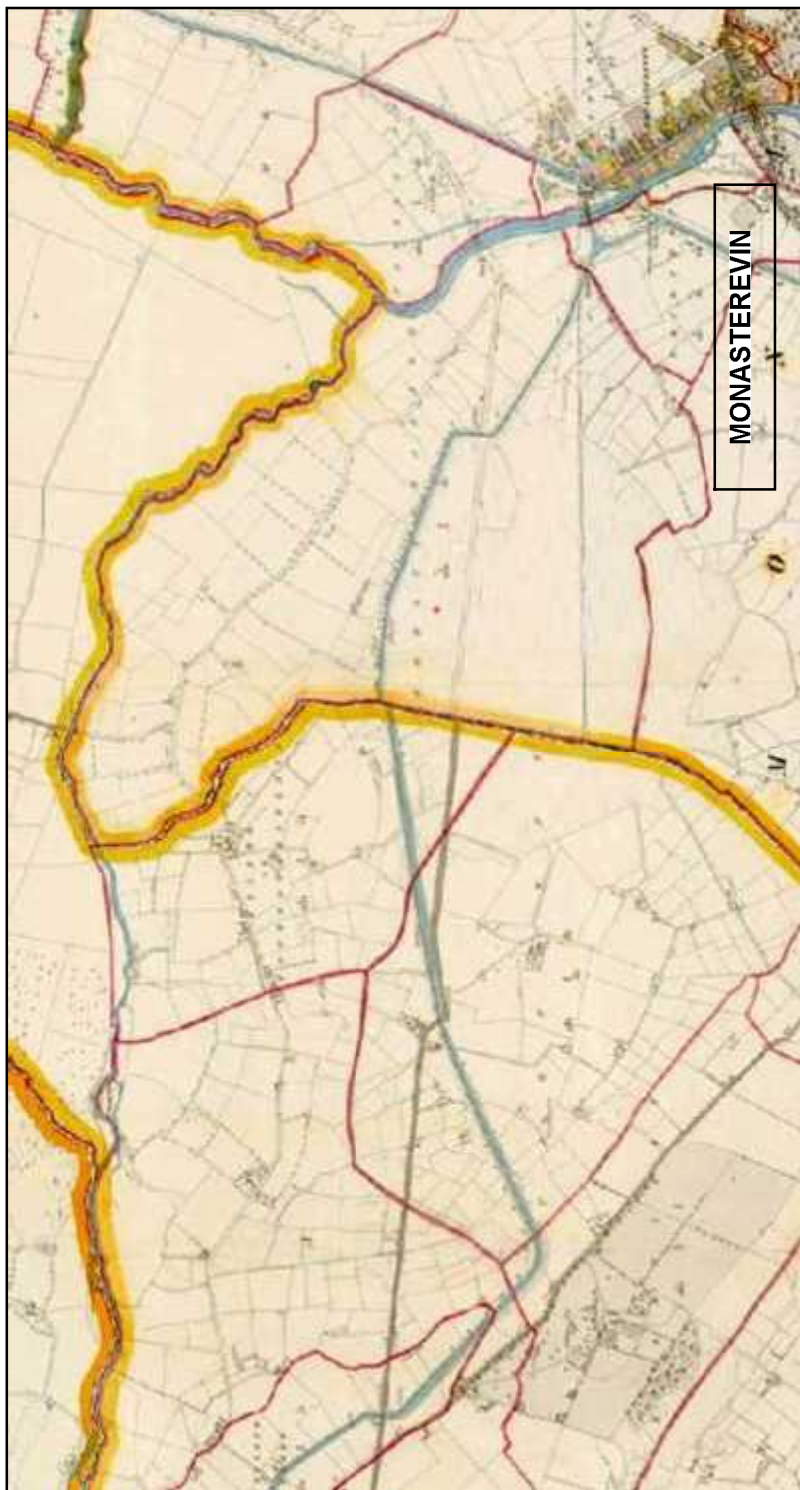

APPENDIX 2: REACH DESCRIPTIONS

Each reach has been divided into sections according to their state at the time of survey (summer 2006). It should be noted that some open/dewatered sections may become temporarily watered during the winter months and at times of high rainfall. Each section is numbered from east to west within its reach. Thus S107 is section 07 within reach 1, S312 is section 12 within reach 3 etc.

The canal sections are superimposed on the 1909 OS 1:10,560 (six-inch) maps, rescaled to 1:20,000.

The colours of each section represent:

- Red – Infilled
- Green – Open, dewatered
- Blue – Open, watered

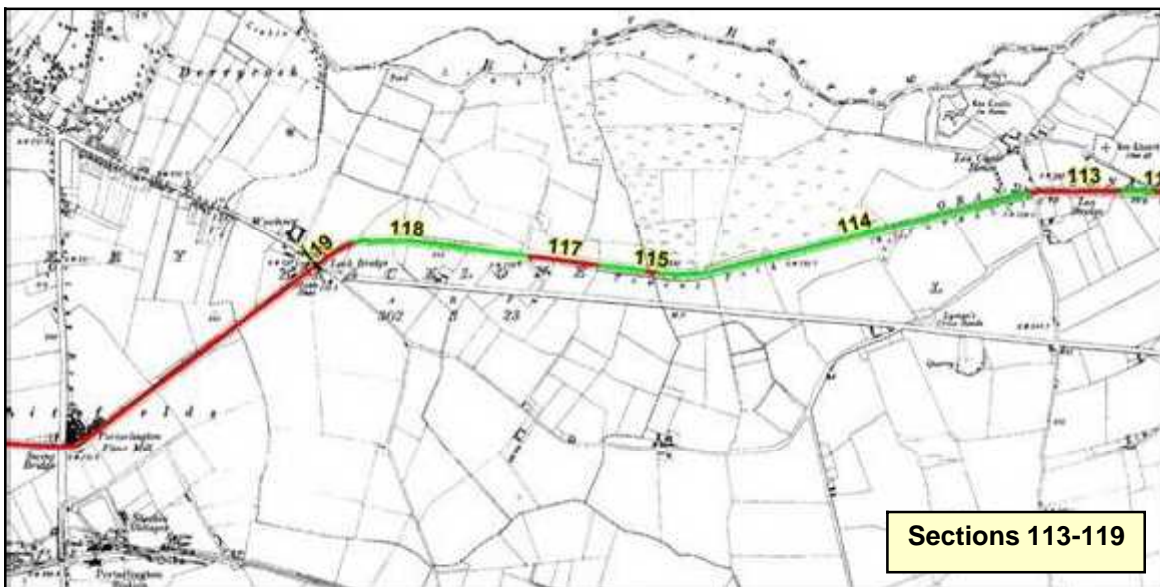
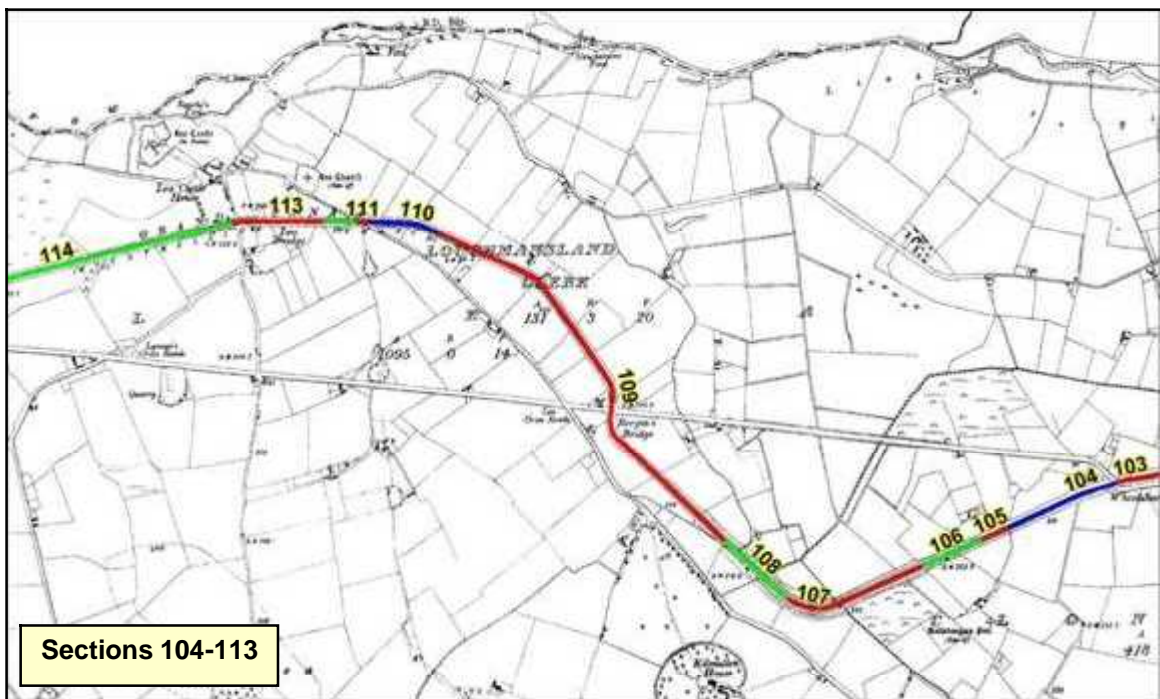
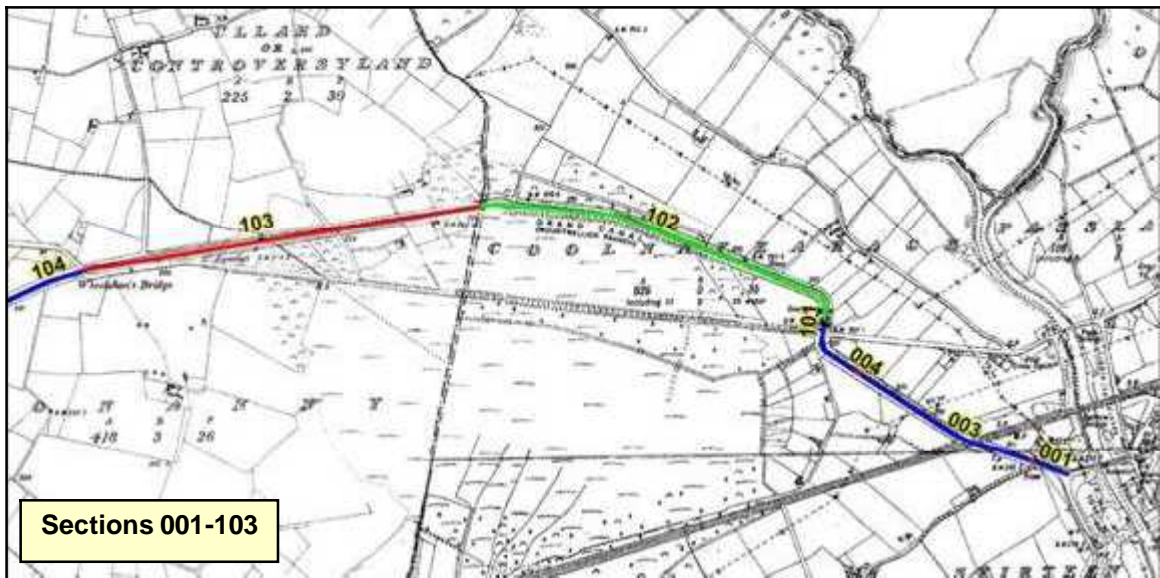

Section 201

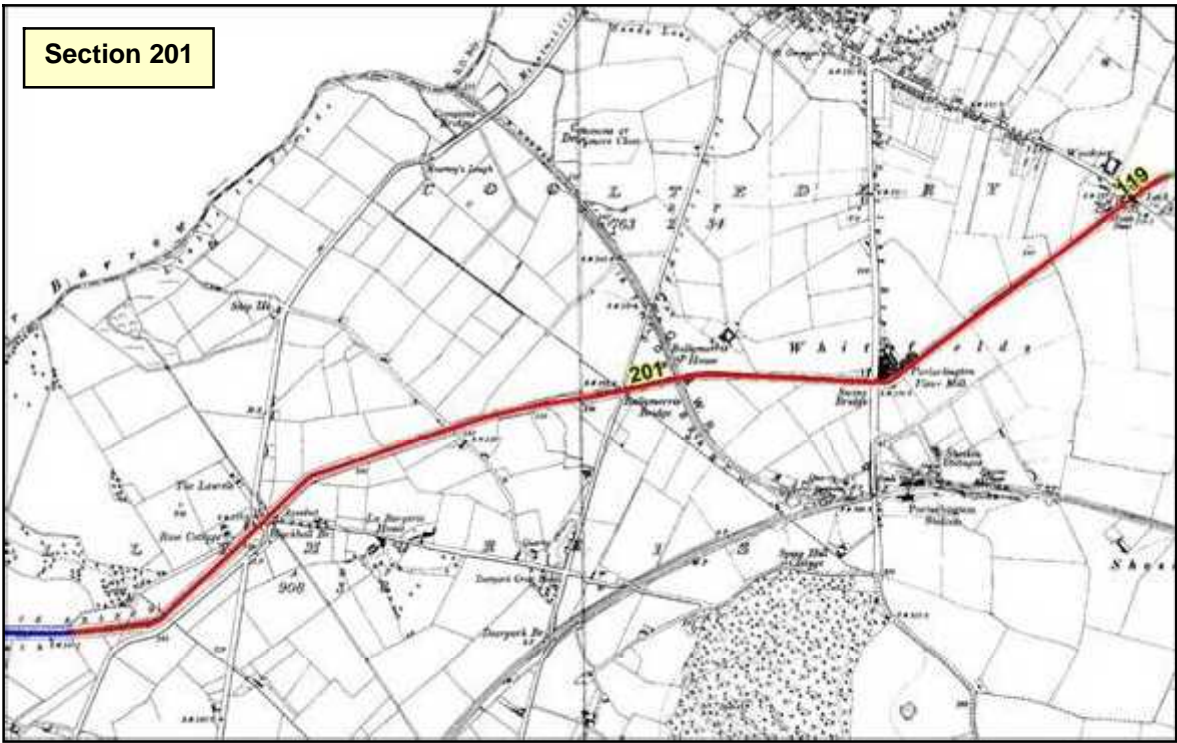

Sections 202-203

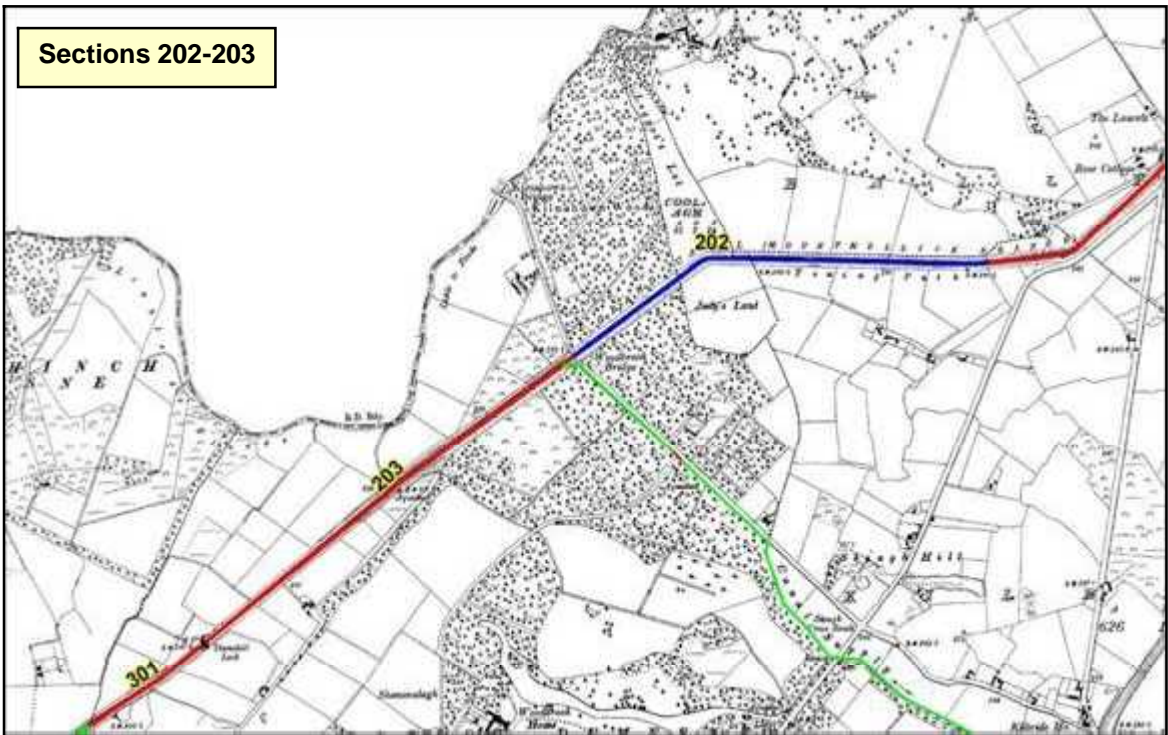

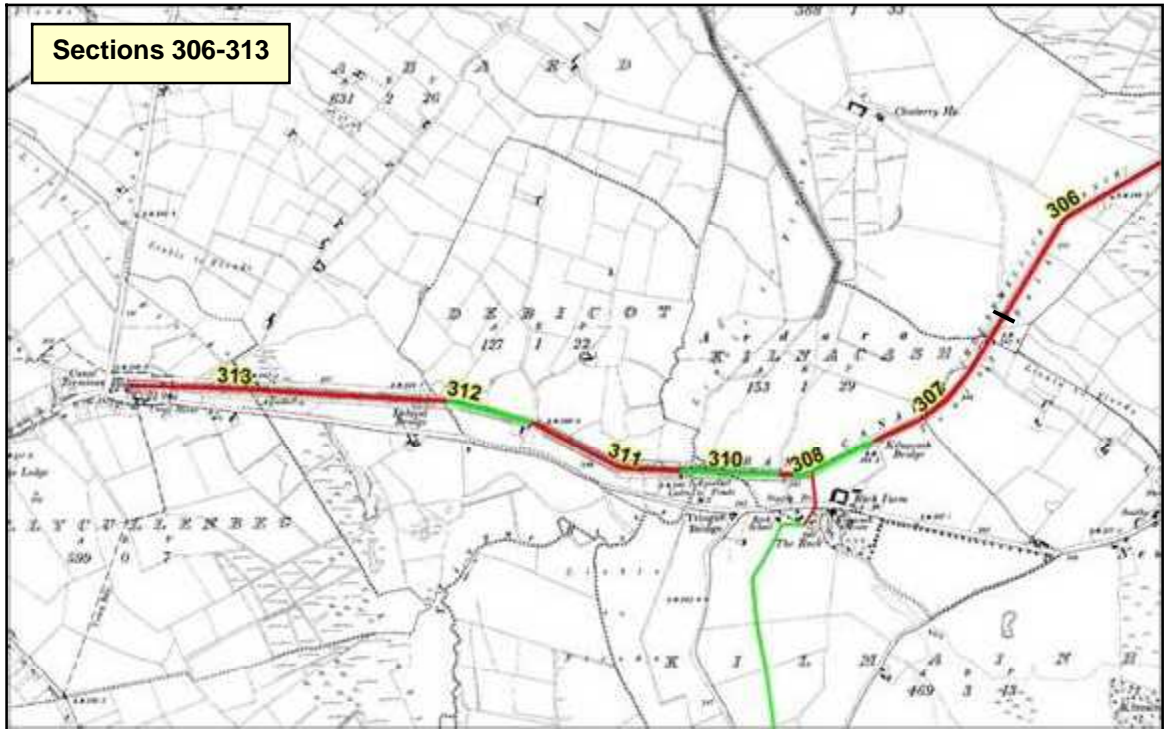
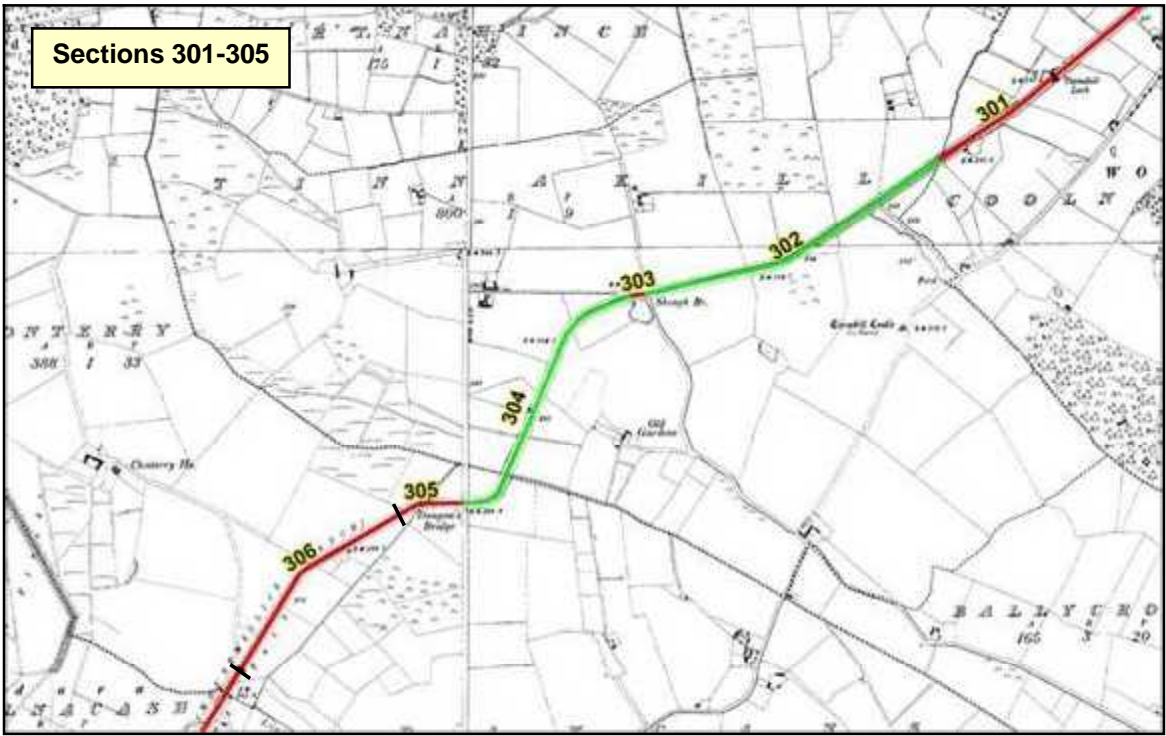

Section	Survival	Length (m)	Description
---------	----------	------------	-------------

REACH 0			
S001	Open, watered	98	Metalled track along west side; walkable grassy bank along east side.



S001_01 Looking north-west across canal junction to first section of Mountmellick Canal.

S002	Infilled	7	Earth impounding dam.
S003	Open, watered	514	Walkable grassy bank along both sides.



S003_01 Looking north-west from road bridge (feature 001).



S003_02 Looking south-east from impounding dam at NW end.

S004	Infilled	8	Earth impounding dam.
S005	Open, watered	173	Walkable grassy bank along both sides.



S005_01 Looking NW along section 005 from impounding dam at SE end.

REACH 1			
S101	Infilled	15	Top section of lock infilled.
S102	Open, dewatered	1002	Line cuts across bog. Some slumping of banks has occurred.



S102_01 Looking north-west along dewatered canal from just north of lock 1 (feature 101a).



S102_02 Looking north-west along dewatered canal from just north of lock 1 (feature 101a).

S103	Infilled	1076	Main road realigned across west end of section to avoid Wheelahan's Bridge.
------	----------	------	---



S103_01 Looking west along infilled section from just east of feature 102.



S103_02 Looking east from Wheelahan's Bridge (feature 103) along infilled section.

S104	Open, watered	301	Very overgrown.
S105	Infilled	75	
S106	Open, dewatered	180	Overgrown channel.



S106_01 Looking north-east from south-west end of dewatered section.

S107	Infilled	390	Mostly reclaimed for agriculture
------	----------	-----	----------------------------------



S107_01 Looking south-west from east end. Hedge marks infilled line of canal.

S108	Open, dewatered	223	Very overgrown.
S109	Infilled	1167	The last 200m of this section (at west) has been quarried away.



S109_01 Looking north along infilled section from Bergin's Bridge (feature 105).



S109_02 Looking south-east across quarry at west end of section. The hedge at left marks the canal's former line.

S110	Open, watered	190	Used as settlement tank for water pumped up from adjoining quarry.
------	---------------	-----	--



S110_01 Water pump at east end of watered section.



S110_02 Looking west along watered section from just west of bend in canal.

S111	Infilled	36	Recent infill to impound water in section 108.
S112	Open, dewatered	86	Overgrown channel.
S113	Infilled	231	Partly reclaimed for agriculture to east of relatively recent road across line.
S114	Open, dewatered	1025	Open, dewatered



S114_01 Looking west from east end of section (road crossing at Lea Castle House).



S114_02 Looking east from near west end of section (access track to sewage works).

S115	Infilled	32	Road into sewage works crosses line.
S116	Open, dewatered	117	Overgrown channel.
S117	Infilled	194	Infilled behind small industrial enterprise along road.
S118	Open, dewatered	466	Overgrown channel.



S118-01 Looking west along overgrown channel from feature 108.

S119	Infilled	102	Reclaimed as gardens for adjoining houses.
------	----------	-----	--

Reach 2			
S201	Infilled	3135	Public road runs along infilled line from 2nd lock to Blackhall Bridge. Infilling continues to west thereof.



S201_01 Looking south-west from lock (feature 201a).



S201_02 Looking north-east from Odlum's Mill (feature 914).



S201_03 Looking west from Odlum's Mill (feature 914).



S201_04 Looking west from site of Ballymorris Bridge (feature 204).



Left: S201_05 Looking north-east along infilled canal from Blackhall Bridge (feature 206).



Right: S201_06 Looking south-west along infilled canal from Blackhall Bridge (feature 206).



S201_07 Looking north-east along infilled canal towards Blackhall Bridge (feature 206).

S202	Open, watered	1168	Stagnant open water. Wide towpath on south side. Shrubby trees along corridor.
------	---------------	------	--



S202_01 Looking west from just east of junction with section 201. Note demolished bank.



S202_02 Looking east at bend in canal east of Woodbrook Bridge (feature 207).



S202_03 Looking south-west at bend in canal east of Woodbrook Bridge (feature 207). Note trees along bank edge.

S203	Infilled	1246	Drainage ditch survives in part on south side. Accommodation road runs along former towpath SW of Woodbrook Bridge.
------	----------	------	---



S203_01 Looking north-east along line of road towards Woodbrook Bridge (feature 207).



S203_02 Looking south-west along infilled canal from culvert (feature 209). The trees at foreground left and right mark the ends of the culvert; the canal has been obliterated.



S203_03 Looking south-west along infilled canal toward Tinnakill lock (feature 301a).

Reach 3			
S301	Infilled	375	Part of north bank survives.
S302	Open, dewatered	865	Metalled road runs along north side. Ornamental trees planted along side of road on north bank.



S302_01 Looking south-west from aqueduct (feature 302).



S302_02 Looking west to Skeagh Bridge (feature 303) from bend in towpath to east of bridge.



S302_03 View east from Skeagh Bridge (feature 303).

S303	Infilled	41	Metalled road to west of Skeagh Bridge.
------	----------	----	---



S303_01 'No dumping' sign just west of Skeagh Bridge (feature 303).

S304	Open, dewatered	755	Wide banks; towpath on south side.
------	-----------------	-----	------------------------------------



S304_01 General view to south-west to east of Dangans Bridge (feature 305).



S304_02 Fly tipping east of Dangans Bridge (feature 305).



S304_03 Looking east from Dangans Bridge (feature 305).

S305	Infilled	167	Banks demolished and bed infilled.
S306	Infilled	616	North-west bank bulldozed into bed but south-east bank survives intact.
S307	Infilled	493	Banks demolished and bed infilled.
S308	Open, dewatered	235	Very overgrown.



S308_01 Looking south-west from Kilnacash Bridge (feature 307).

S309	Infilled	43	Banks demolished and bed infilled.
S310	Open, dewatered	254	Very overgrown.



S310_01 Looking west from east end of section.

S311	Infilled	425	Banks demolished and bed infilled.
S312	Open, dewatered	233	Overgrown.



S312_01 Looking east from half-way along open/dewatered section.

S313	Infilled	855	Banks demolished and bed infilled.
------	----------	-----	------------------------------------



S313_01 Looking west along infilled canal from Debicot Bridge (feature 310).



S313_02 Looking east along infilled canal from site of former aqueduct (feature 311).



S313_03 Looking west towards terminus along infilled canal from site of former aqueduct (feature 311).

APPENDIX 3: NAMES OF PLANT SPECIES RECORDED

Agrimony	<i>Agrimonia eupatoria</i>
Agrimony, hemp	<i>Eupatorium cannabinum</i>
Alder	<i>Alnus glutinosa</i>
Angelica	<i>Angelica sylvestris</i>
Apple, crab	<i>Malus sylvestris</i>
Arum, wild	<i>Malus domestica</i>
Ash	<i>Fraxinus excelsior</i>
Aspen	<i>Populus tremula</i>
Asphodel, bog	<i>Narthecium ossifragum</i>
Avens, wood	<i>Geum urbanum</i>
Bedstraw, lady's	<i>Galium verum</i>
Bedstraw, marsh	<i>Galium palustre</i>
Beech	<i>Fagus sylvatica</i>
Bennet, herb	<i>Geum urbanum</i>
Bent, common	<i>Agrostis canina</i>
Bent, creeping	<i>Agrostis stolonifera</i>
Bindweed, large	<i>Calystegia sepium</i>
Bindweed, small	<i>Convolvulus arvensis</i>
Bird's-foot trefoil	<i>Lotus corniculatus</i>
Bittersweet	<i>Solanum dulcamara</i>
Black bog-rush	<i>Schoenus nigricans</i>
Black knapweed	<i>Centaurea nigra</i>
Blackthorn	<i>Prunus spinosa</i>
Bladderwort	<i>Utricularia minor</i>
Bogbean	<i>Menyanthes trifoliata</i>
Bramble	<i>Rubus fruticosus</i>
Bridewort	<i>Spiraea</i> sp.
Broomrape, ivy	<i>Orobanche hederaceae</i>
Bur-reed, branched	<i>Sparganium erectum</i>
Bur-reed, least	<i>Sparganium natans</i>
Buttercup, creeping	<i>Ranunculus repens</i>
Buttercup, meadow	<i>Ranunculus arvensis</i>
Butterfly orchid	<i>Platanthera bifolia</i>
Butterwort, common	<i>Pinguicula vulgaris</i>
Butterwort, pale	<i>Pinguicula lusitanica</i>
Campion, bladder	<i>Silene vulgaris</i>
Carrot, wild	<i>Daucus carota</i>

Cat's-ear	<i>Hypochaeris radicata</i>
Centaury, yellow	<i>Blackstonia perfoliata</i>
Chickweed, mouse-ear	<i>Cerastium fontanum</i>
Chickweed, small	<i>Stellaria media</i>
Cinquefoil	<i>Potentilla reptans</i>
Cleavers	<i>Galium aparine</i>
Clover, red	<i>Trifolium pratense</i>
Clover, white	<i>Trifolium repens</i>
Cock's-foot	<i>Dactylis glomerata</i>
Common cotton-grass	<i>Eriophorum vaginatum</i>
Common reed	<i>Phragmites australis</i>
Cowslip	<i>Primula veris</i>
Cross-leaved heath	<i>Erica tetralix</i>
Crowfoot, water	<i>Ranunculus aquatilis</i>
Daisy	<i>Bellis perennis</i>
Daisy, ox-eye	<i>Leucanthemum vulgare</i>
Damson	<i>Prunus insititia</i>
Dandelion	<i>Taraxacum officinale</i>
Deer-sedge	<i>Trichophorum caespitosum</i>
Destroying angel	<i>Amanita virosa</i> var. <i>Alba</i>
Devil's-bit scabious	<i>Succisa pratensis</i>
Dock, broad-leaved	<i>Rumex obtusifolius</i>
Dock, water	<i>Rumex hydrolapathum</i>
Dock, wood	<i>Rumex sanguineus</i>
Downy birch	<i>Betula pubescens</i>
Dryad's saddle	<i>Polyporus squamosus</i>
Elm	<i>Ulmus procera</i>
Eyebright	<i>Euphrasia</i> sp.
False-brome	<i>Brachypodium sylvaticum</i>
Fern, hart's-tongue	<i>Phyllitis scolopendrium</i>
Fern, male	<i>Dryopteris filix-mas</i>
Fescue, meadow	<i>Festuca arvensis</i>
Fescue, red	<i>Festuca rubra</i>
Fescue, tall	<i>Festuca arundinacea</i>
Figwort	<i>Scrophularia nodosa</i>
Flag, yellow	<i>Iris pseudacorus</i>
Flax, fairy	<i>Linum catharticum</i>
Fleabane	<i>Pulicaria dysenterica</i>
Fog, Yorkshire	<i>Holcus lanatus</i>

Forget-me-not, water	<i>Myosotis scorpioides</i>
Furze	<i>Ulex europaeus</i>
Gipsywort	<i>Lycopus europaeus</i>
Goutweed	<i>Aegopodium podagraria</i>
Grass, flote	<i>Glyceria fluitans</i>
Grass, quaking	<i>Briza media</i>
Grass, reed	<i>Phalaris arundinacea</i>
Grass, scutch	<i>Agropyron repens</i>
Grass, tussock	<i>Deschampsia caespitosa</i>
Grass-reed sweet	<i>Glyceria maxima</i>
Hawk's-beard, smooth	<i>Crepis capillaris</i>
Hawkbit, autumnal	<i>Leontodon autumnalis</i>
Hawkbit, greater	<i>Leontodon hispidus</i>
Hawkbit, lesser	<i>Leontodon saxatilis</i>
Hawkweed, mouse-ear	<i>Hieracium pilosella</i>
Hawthorn	<i>Crataegus monogyna</i>
Hazel	<i>Coryllus avellana</i>
Heather	<i>Calluna vulgaris</i>
Helleborine, marsh	<i>Epipactis palustris</i>
Hogweed	<i>Heracleum sphondylium</i>
Holly	<i>Ilex aquifolium</i>
Honeysuckle	<i>Lonicera periclymenum</i>
Hop, wild	<i>Humulus lupulus</i>
Horsetail, water	<i>Equisetum fluviatile</i>
Horsetail, field	<i>Equisetum arvense</i>
Horsetail, hybrid	<i>Equisetum x littorale</i>
Horsetail, marsh	<i>Equisetum palustre</i>
Ivy	<i>Hedera helix</i>
Knapweed, black	<i>Centaurea nigra</i>
Knotweed, Japanese	<i>Reynoutria japonica</i>
Lilac	<i>Syringa vulgaris</i>
Loosestrife, purple	<i>Lythrum salicaria</i>
Marigold, French	<i>Kerria japonica</i>
Meadow-grass, rough-stalked	<i>Poa trivialis</i>
Meadow-rue	<i>Thalictrum flavum</i>
Meadowsweet	<i>Filipendula ulmaria</i>
Milkwort, common	<i>Polygala vulgaris</i>
Milkwort, heath	<i>Polygala serpyllifolia</i>
Mint, water	<i>Mentha aquatica</i>

Mountain everlasting	<i>Antennaria dioica</i>
Mullein	<i>Verbascum thapsus</i>
Nettle	<i>Urtica dioica</i>
Nightshade, woody	<i>Solanum dulcamara</i>
Nipplewort	<i>Lapsana communis</i>
Oak	<i>Quercus robur</i>
Oat, false	<i>Arrhenaterum elatius</i>
Oat, golden	<i>Avenula pubescens</i>
Oat, yellow	<i>Trisetum flavescens</i>
Orchid, common spotted	<i>Dactylorhiza maculata</i>
Orchid, pyramidal	<i>Anacamptis pyramidalis</i>
Parsley, cow	<i>Anthriscus sylvestris</i>
Parsley, hedge	<i>Torilis japonica</i>
Pennywort, marsh	<i>Hydrocotyle vulgaris</i>
Pignut	<i>Conopodium majus</i>
Plantain, ribwort	<i>Plantago lanceolata</i>
Pondweed	<i>Potamogeton</i> sp.
Pondweed, Canadian	<i>Elodea</i> sp.
Poplar, white	<i>Populus alba</i>
Primrose	<i>Primula vulgaris</i>
Privet	<i>Ligustrum</i> sp.
Purple moor grass	<i>Molinia caerulea</i>
Ragwort	<i>Senecio vulgaris</i>
Ragwort, marsh	<i>Senecio aquaticus</i>
Rattle, yellow	<i>Rhinanthus minor</i>
Redshank	<i>Polygonum persicaria</i>
Reed, common	<i>Phragmites australis</i>
Robert, herb	<i>Geranium robertianum</i>
Rose, Guelder	<i>Viburnum opulus</i>
Rose, dog	<i>Rosa canina</i>
Rose, wild	<i>Rosa arvensis</i>
Rowan	<i>Sorbus aucuparia</i>
Rush, hard	<i>Juncus inflexus</i>
Rush, heath	<i>Juncus squarrosus</i>
Ryegrass, perennial	<i>Lolium perenne</i>
Scabious, devil's-bit	<i>Succisa pratensis</i>
Scabious, field	<i>Knautia arvensis</i>
Sedge, bottle	<i>Carex rostrata</i>
Sedge, carnation	<i>Carex panicea</i>

Sedge, glaucous	<i>Carex flacca</i>
Sedge, great fen	<i>Cladium mariscus</i>
Sedge, lesser fox	<i>Carex otrubae</i>
Sedge, wood	<i>Carex sylvatica</i>
Sedges	<i>Carex</i> spp.
Self-heal	<i>Prunella vulgaris</i>
Silverweed	<i>Potentilla anserina</i>
Snowberry	<i>Symphoricarpus albus</i>
Speedwell, germander	<i>Veronica chamaedrys</i>
Spike rush, few-flowered	<i>Eliocharis</i> sp.
St. John's wort, perforated	<i>Hypericum perforatum</i>
St. John's wort, slender	<i>Hypericum pulchrum</i>
Starwort, water	<i>Callitriche stagnalis</i>
Stonecrop, white	<i>Sedum album</i>
Sundew, intermediate	<i>Drosera intermedia</i>
Sundew, long-leaved	<i>Drosera longifolia</i>
Sundew, round-leaved	<i>Drosera rotundifolia</i>
Sweet-grass, reed	<i>Glyceria maxima</i>
Sycamore	<i>Acer pseudoplatanus</i>
Tar spot fungus	<i>Rhytisma acerina</i>
Teaplant, Duke of Argyll's	<i>Lycium barbarum</i>
Thistle, bog (meadow)	<i>Cirsium dissectum</i>
Thistle, creeping	<i>Cirsium arvense</i>
Thistle, marsh	<i>Cirsium palustre</i>
Thistle, spear	<i>Cirsium vulgare</i>
Timothy	<i>Phleum pratense</i>
Tormentil	<i>Potentilla erecta</i>
Trefoil, bird's-foot	<i>Lotus corniculatus</i>
Twayblade	<i>Listera ovata</i>
Valerian, common	<i>Valeriana officinalis</i>
Vernal grass, sweet	<i>Anthoxanthum odoratum</i>
Vetch, bush	<i>Vicia sepium</i>
Vetch, tufted	<i>Vicia cracca</i>
Vetchling, meadow	<i>Lathyrus pratensis</i>
Violet, common dog	<i>Viola riviniana</i>
Watercress	<i>Nasturtium officinale</i>
Water-milfoil, alternate	<i>Myriophyllum alterniflorum</i>
Water-parsnip, lesser	<i>Berula erecta</i>
Water-plantain, lesser	<i>Baldellia ranunculoides</i>

White beak sedge	<i>Rhynchospora alba</i>
Whitebeam, Irish	<i>Sorbus hibernica</i>
Willow, crack	<i>Salix fragilis</i>
Willow, eared	<i>Salix aurita</i>
Willow, goat	<i>Salix capraea</i>
Willow, grey	<i>Salix cinerea</i>
Willow, white	<i>Salix alba</i>
Willowherb, broad-leaved	<i>Epilobium montanum</i>
Willowherb, great hairy	<i>Epilobium hirsutum</i>
Willowherb, hoary	<i>Epilobium parviflorum</i>
Willowherb, rosebay	<i>Epilobium angustifolium</i>
Woody nightshade:	See bittersweet
Woundwort, marsh	<i>Stachys palustris</i>
Yarrow	<i>Achillea millefolium</i>
Yew	<i>Taxus baccata</i>

APPENDIX 4: VASCULAR PLANTS IN COOLNAFEARAGH BOG

Angelica	<i>Angelica sylvestris</i>
Asphodel, bog	<i>Narthecium ossifragum</i>
Beak-sedge, white	<i>Rhynchospora alba</i>
Birch, downy	<i>Betula pubescens</i>
Black Knapweed	<i>Centaurea nigra</i>
Bladderwort	<i>Utricularia minor</i>
Bogbean	<i>Menyanthes trifoliata</i>
Bog-rush, black	<i>Schoenus nigricans</i>
Bur-reed, least	<i>Sparganium minimum</i>
Butterwort, common	<i>Pinguicula vulgaris</i>
Butterwort, pale	<i>Pinguicula lusitanica</i>
Cotton, bog	<i>Eriophorum angustifolium</i>
Deer-grass	<i>Scirpus caespitosus</i>
False oat	<i>Arrhenatherum elatius</i>
Fescue species	<i>Festuca sp.</i>
Grass, purple moor	<i>Molinia caerulea</i>
Grass, sweet vernal	<i>Anthoxanthum odoratum</i>
Heath, cross-leaved	<i>Erica tetralix</i>
Heather, ling	<i>Calluna vulgaris</i>
Helleborine, marsh	<i>Epipactis palustris</i>
Hemp-agrimony	<i>Eupatorium cannabinum</i>
Horsetail, common	<i>Equisetum arvense</i>
Horsetail, marsh	<i>Equisetum palustre</i>
Horsetail, water	<i>Equisetum fluviatile</i>
Lousewort	<i>Pedicularis sylvatica</i>
Meadowsweet	<i>Filipendula ulmaria</i>
Milkwort, heath	<i>Polygala serpyllifolia</i>
Mountain everlasting	<i>Antennaria dioica</i>
Orchid, common spotted	<i>Dactylorhiza fuchsii</i>
Orchid, lesser butterfly	<i>Platanthera bifolia</i>
Orchid, marsh	<i>Dactylorhiza incarnata</i>
Pennywort, marsh	<i>Hydrocotyle vulgaris</i>
Pondweed	<i>Potamogeton natans</i>
Reed, common	<i>Phragmites australis</i>
Rush, heath	<i>Juncus squarrosus</i>
Saint John's wort, perforate	<i>Hypericum perforatum</i>

Saint John's wort, square-stemmed	<i>Hypericum tetrapterum</i>
Saint John's wort, slender	<i>Hypericum pulchrum</i>
Scabious, devil's-bit	<i>Succisa pratensis</i>
Sedge , great fen	<i>Cladium mariscus</i>
Sedge, bottle	<i>Carex rostrata</i>
Sedge, carnation	<i>Carex panicea</i>
Sedge, glaucous	<i>Carex flacca</i>
Sedge, lesser tussock (locally extensive stands)	<i>Carex diandra</i>
Spearwort, lesser	<i>Ranunculus flammula</i>
Spike rush, few-flowered	<i>Eliocharis</i> sp.
Stonewort	<i>Chara</i> sp.
Sundew, intermediate	<i>Drosera intermedia</i>
Sundew, long-leaved	<i>Drosera longifolia</i>
Sundew, round-leaved	<i>Drosera rotundifolia</i>
Thistle, bog	<i>Cirsium dissectum</i>
Tormentil	<i>Potentilla erecta</i>
Trefoil, bird's-foot	<i>Lotus corniculatus</i>
Twayblade	<i>Listera ovata</i>
Valerian, marsh	<i>Valeriana officinalis</i>
Vetch, bush	<i>Vicia sepium</i>
Vetch, tufted	<i>Vicia cracca</i>
Water plantain, lesser	<i>Baldellia ranunculoides</i>
Water-milfoil, alternate	<i>Myriophyllum alterniflorum</i>
Willow , crack	<i>Salix fragilis</i>
Willow, eared	<i>Salix aurita</i>
Willow, grey	<i>Salix cinerea</i>
Woodrush, greater	<i>Luzula sylvatica</i>
Yorkshire fog	<i>Holcus lanatus</i>

APPENDIX 5:
CANAL-RELATED BUILT HERITAGE FEATURES

Feature F001 Mountmellick Junction

Site type	Canal junction		
County	Co Kildare	Townland	Skirteen
Town	Monasterevin	Address	
Grid	262252 210610	OS six-inch sheet	KL 026
History	Associated with Mountmellick Branch of Grand Canal (opened 1831; closed 1960). Shown, but not captioned on all editions of the OS six-inch map from 1838 onwards (Kildare sheet 26).		
Survey date	22/08/2006	Surveyor	Fred Hamond
Ownership	Public (Waterways Ireland)		
Completeness	Complete	Condition	Excellent
		Current use	Canal junction
Description	Junction of Mountmellick Canal with Athy Branch of Grand Canal. From this junction, the Barrow line runs east to the Barrow Aqueduct, and south towards 25th lock. The Mountmellick section is watered as far as the first road bridge (feature 002).		
Evaluation	Regional industrial heritage significance. Merits inclusion in Kildare CC Record of Protected Structures.		
Significance	Regional		
Statutory protection		Action	Include in RPS
Other databases	IWAI MMC 005		

Feature F002 Johnny Dunne's Bridge

Site type Bridge (road/canal)
 County Co Kildare Townland Coolnafearagh; Skirteen
 Town Monasterevin Address
 Grid 262167 210644 OS six-inch sheet KL 026

History Shown on 1838 OS six-inch map (Kildare sheet 26) and subsequent editions.

Survey date 22/08/2006 Surveyor Fred Hamond

Ownership Public (Kildare CC)

Completeness Complete Condition Good Current use Road bridge

Description Masonry arch bridge carries public road over watered section of Mountmellick Branch of Grand Canal. Of randomly coursed squared limestone rubble except for the parapet, which is of random rubble throughout. The arch is of semicircular profile and spans 6.70m (the actual channel is 4.97m wide and the towpath 1.73m wide). Its soffit is of squared limestone blocks and its voussoirs of finely dressed stone. A towpath runs through the north-east side. Both faces of the bridge curve outwards and are embellished with a finely dressed string course under each parapet. The parapets are spaced at 4.28m and are coped with finely dressed limestone blocks. Pronounced hump to deck. No datestones. A pipe is carried across the outside face of the north-west parapet. Ivy overgrowth.

Evaluation Regional industrial heritage significance. Merits inclusion in Kildare CC Record of Protected Structures.

Significance Regional

Statutory protection Action Include in RPS

Other databases IWAI MMC 010; NIAH 11816005

Photographs
 F002_01 22/08/2006 South-east elevation of road bridge.





Feature F003

Site type Bridge (rail/canal)
County Co Kildare Townland Coolnafearagh
Town Monasterevin Address
Grid 261994 210696 OS six-inch sheet KL 021

History This line was opened as far as Portlaoise by the Great Southern & Western Railway in 1847 (it reached Cork in 1849). The stonework is original, but the deck is a mid/late 20th century replacement. The 1871 OS six-inch map (Kildare sheet 21) captions it as "wooden bridge", indicating that the original was a timber truss span.

Survey date 22/08/2006 Surveyor Fred Hamond
Ownership Public (Iarnród Éireann)
Completeness Complete Condition Good Current use Rail bridge

Description A highly skewed triple-span bridge carries the twin-track Dublin-Cork railway over the Mountmellick Canal, here watered. The abutments and piers are original, but the deck has been replaced. The former are of quarry-faced limestone blocks, laid to regular courses and with tooled arrises. The wing walls, which curve outwards and downwards, are of random squared limestone rubble and are coped with limestone blocks. The main span over the canal is 9.82m wide (measured orthogonally) and comprises two reinforced-concrete beams, between which are set eight RSJs, all running parallel with one another. The two end sections span the grassed canal banks and are of pre-cast reinforced concrete slabs. The east span is 3.61m wide (again measured orthogonally); the west span is probably similar. All the spans are laid on concrete pillow blocks over the string courses. Steel railings to either side of the lines.

Evaluation The stonework on this bridge is of high quality. However, the replacement of the deck has diminished the historical interest. It is a prominent local landmark. Overall, of local heritage significance.

Significance Local

Statutory protection Action

Other databases IWAI MMC 020; NIAH 11816105

Photographs

F003_01 22/08/2006 South-east elevation of rail bridge.



F003_02 22/08/2006 South-east elevation of rail bridge.



F003_03 22/08/2006 North-west elevation of rail bridge.



F003_04 22/08/2006 Underside of main span showing RSJs.



Feature F101a Coughlan's Lock; 1st lock

Site type Lock
County Co Kildare Townland Coolnafearagh
Town Address
Grid 261604 211007 OS six-inch sheet KL 021

History Associated with Mountmellick Branch of Grand Canal (opened 1831; closed 1960). Captioned as "25th lock" on the 1837 and 1871 OS six-inch maps (Kildare sheet 21). This is also the number of the lock on the Athy Branch of the Grand Canal, just south of Mountmellick Junction, so this caption may be an error.

Survey date 22/08/2006 Surveyor Fred Hamond
Ownership Private
Completeness Substantial remains Condition Fair Current use Disused

Description Single lock chamber, open except for infilled top section (at cill). Side walls constructed of finely dressed limestone blocks, laid to courses and coped with large granite blocks. Vestiges of timber gates at south end. This end is also crossed by a road bridge (feature 101b). The chamber is 4.48m wide. Some vegetation growth on walls.

Evaluation Regional industrial heritage significance. Merits inclusion in Kildare CC Record of Protected Structures.

Significance Regional
Statutory protection Action Include in RPS

Other databases IWAI MMC 040

Photographs
F101_01 22/08/2006 Road bridge and lock house, from south.



F101_02 22/08/2006 Lock and lock house from road bridge.



F101a_01 22/08/2006 Looking north along chamber from road bridge (feature 101b).



F101a_02 22/08/2006 Looking south along chamber from infilled north end.



F101a_03 22/08/2006 Gate detail at south-west end of lock chamber.



Feature F101b Coughlan's Bridge

Site type Bridge (road/canal)
 County Co Kildare Townland Coolnafearagh
 Town Address
 Grid 261601 210986 OS six-inch sheet KL 021

History Associated with Mountmellick Branch of Grand Canal (opened 1831; closed 1960). Shown on the 1837 OS six-inch map and subsequent editions (Kildare sheet 21).

Survey date 22/08/2006 Surveyor Fred Hamond

Ownership Public (Kildare CC)

Completeness Complete Condition Good Current use Road bridge

Description Masonry arch bridge carries public road over watered section of Mountmellick Branch of Grand Canal at south end of first lock (feature 101a). The abutments are a continuation of the lock chamber and are of finely dressed limestone blocks, laid to courses. The voussoirs and spandrels are likewise constructed. The arch is of segmental profile and spans 4.48m (the same as the lock). Its soffit is of squared limestone blocks. Both faces of the bridge curve outwards and are embellished with a finely dressed string course along the base of each parapet. The outsides of the parapets are of dressed stonework, whereas their road faces are of random rubble; they are spaced at 6.50m and are coped with limestone blocks. There is no towpath through the arch. The deck is humped. No datestones. Ivy overgrowth.

Evaluation Regional industrial heritage significance. Merits inclusion in Kildare CC Record of Protected Structures.

Significance Regional

Statutory protection Action Include in RPS

Other databases IWAI MMC 030

Photographs
 F101b_01 22/08/2006 North elevation.



F101b_02 22/08/2006 South elevation.



Feature F101c Coughlan's Lock House

Site type	Lock keeper's house		
County	Co Kildare	Townland	Coolnafearagh
Town	Address		
Grid	261622 211025	OS six-inch sheet	KL 021
History	Associated with Mountmellick Branch of Grand Canal (opened 1831; closed 1960). Shown on the 1837 OS six-inch map and subsequent editions (Kildare sheet 21).		
Survey date	22/08/2006	Surveyor	Fred Hamond
Ownership	Private		
Completeness	Complete	Condition	Good
		Current use	Dwelling
Description	<p>Detached four-bay, single-storey former lock keeper's house aligned north-south at east end of lock 1 on Mountmellick Branch of Grand Canal. The building was possibly three bays wide originally, but was extended by a single bay to its north end (there is a join mark on the rear wall). Hipped natural slate roof with off-centre brick chimney. No rainwater goods. Lime rendered random rubble walls (painted to front and sides) with advanced eaves course. The principal elevation faces west to the lock. Square-headed openings. The doorway and window to each side thereof are set in segmental-headed recesses. The door is a modern replacement, as are the uPVC windows. Concrete supporting abutment at north end of this elevation. There is a square-headed replacement window set in a segmental-headed recess on the south gable. There is a semi-basement to the rear elevation, accessed by a door on the north gable. Two square-headed window openings to the rear elevation, again with replacement windows. The house is still inhabited. To its north is a derelict single-storey shed with monopitched corrugated metal roof and random rubble walls.</p>		
Evaluation	This is one of three lock houses on the Mountmellick Canal and the only inhabited at the time of this survey. Although its character is diminished by the modern windows, these are reversible. Overall, the building is of regional industrial heritage significance. Merits inclusion in Kildare CC Record of Protected Structures.		
Significance	Regional		
Statutory protection		Action	Include in RPS
Other databases	IWAI MMC 040		

Photographs

F101c_01 22/08/2006 Lock house from south-west.



F101c_02 22/08/2006 Lock house from north-west.



Feature	F101d				
Site type	Canal overflow				
County	Co Kildare	Townland	Coolnafearagh		
Town	Address				
Grid	261596	211042	OS six-inch sheet	KL 021	
History	Not shown on the 1837 or 1871 OS six-inch maps (Kildare sheet 21). Captioned 'overflow' on the 1939 edition.				
Survey date	22/08/2006	Surveyor	Fred Hamond		
Ownership					
Completeness	No visible remains	Condition	N/A	Current use	N/A
Description	There are no obvious traces of this overflow. It may still survive, buried under infill and vegetation overgrowth.				
Evaluation	No industrial heritage significance.				
Significance	Record only				
Statutory protection	Action				
Other databases					

Feature F102

Site type Bridge (canal/river)

County Co Laois Townland Clonanny

Town Address

Grid 259973 211205 OS six-inch sheet LA 005

History Associated with Mountmellick Branch of Grand Canal (opened 1831; closed 1960). Cited as 'aqueduct' on 1838 OS six-inch map and subsequent editions (Laois sheet 5).

Survey date 22/08/2006 Surveyor Fred Hamond

Ownership

Completeness No visible remains Condition N/A Current use N/A

Description Site of culvert which formerly carried drainage channel under now-demolished section of canal.

Evaluation No industrial heritage significance.

Significance Record only

Statutory protection Action

Other databases LAIAR-005-018

Feature F103 Wheelahan's Bridge

Site type	Bridge (road/canal)		
County	Co Laois	Townland	Clonanny
Town	Address		
Grid	259638 211148	OS six-inch sheet	LA 005
History	Associated with Mountmellick Branch of Grand Canal (opened 1831; closed 1960). Cited as 'Wheelahan's Bridge' on 1838 OS six-inch map and subsequent editions (Laois sheet 5).		
Survey date	22/08/2006	Surveyor	Fred Hamond
Ownership	Private		
Completeness	Complete	Condition	Good
		Current use	Road bridge
Description	<p>Masonry arch bridge carries public road over now-infilled section of Mountmellick Branch of Grand Canal. Of randomly coursed squared limestone rubble. The slightly skew arch is of semicircular profile and spans 6.69m. Its soffit is of squared rubble (laid orthogonally) and its voussoirs are of finely dressed stone. A 1.74m wide towpath runs through its south side (the channel is 4.95m wide). There are towrope marks at both ends of the arch on this side. Both faces of the bridge curve outwards and are embellished with a finely dressed string course which continues under the outsides of the parapets. The parapets are coped with dressed limestone blocks and their inside faces are of random rubble; they are spaced at 6.37m. Humped deck. No datestones. Ivy overgrowth on south face. Dogleg approach roads. Now bypassed to north by new road and used for access only.</p>		
Evaluation	This unaltered bridge is of typical design for this section of canal and is of architectural and historical interest. Its current status as a Protected Structure (LA 547) is merited because of its regional heritage significance.		
Significance	Regional		
Statutory protection	RPS LA 547	Action	
Other databases	IWAI MMC 050; LAIAR-005-017; NIAH 12800551		

Photographs

F103_01 22/08/2006 North elevation of Wheelahan's Bridge.



F103_02 22/08/2006 North elevation of Wheelahan's Bridge.



References Survey of the Architectural Heritage of County Laois (Dublin: NIAH, 2002).

Feature F104

Site type Canal overflow

County Co Laois Townland Loughmansland Glebe

Town Address

Grid 258333 211276 OS six-inch sheet LA 005

History Associated with Mountmellick Branch of Grand Canal (opened 1831; closed 1960). Cited as 'overflow' on 1838 and 1888 OS six-inch maps (Laois sheet 5).

Survey date 22/08/2006 Surveyor Fred Hamond

Ownership

Completeness No visible remains Condition N/A Current use N/A

Description Site of canal overflow. Canal cleared hereabouts.

Evaluation No industrial heritage significance.

Significance Record only

Statutory protection Action

Other databases LAIAR-005-012

Feature F105 Bergin's Bridge

Site type Bridge (road/canal)
 County Co Laois Townland Loughmansland Glebe
 Town Address
 Grid 258303 211345 OS six-inch sheet LA 005

History Associated with Mountmellick Branch of Grand Canal (opened 1831; closed 1960). Cited as 'Bergin's Bridge' on 1838 OS six-inch map and subsequent editions (Laois sheet 5).

Survey date 22/08/2006 Surveyor Fred Hamond
 Ownership Public (Laois CC)
 Completeness Complete Condition Good Current use Road bridge

Description Masonry arch bridge carries public road over now-infilled section of Mountmellick Branch of Grand Canal. Of randomly coursed squared limestone rubble. The arch is of semicircular profile and spans 6.68m. Its soffit is of squared rubble and its voussoirs are of finely dressed stone. A 1.70m wide towpath runs through its west side (the channel is 4.98m wide). Both faces of the bridge curve outwards and are embellished with a finely dressed string course which continues under the outsides of the parapets. The parapets are coped with dressed limestone blocks and their inside faces are of random rubble; they are spaced at 6.42m. Humped deck. No datestones. Ivy overgrowth.

Evaluation This unaltered bridge is of architectural and historical interest, being typical of the bridges along this branch of the Grand Canal. It also has group value in the context of the overall canal. It is of regional heritage significance and merits inclusion in the Record of Protected Structures.

Significance Regional
 Statutory protection Action Include in RPS

Other databases IWAI MMC 060; LAIAR-005-016

Photographs
 F105_01 22/08/2006 North face of Bergin's Bridge.





Feature F106 **Lea Bridge**

Site type Bridge (road/canal)

County Co Laois Townland Lea

Town Address

Grid 257419 211843 OS six-inch sheet LA 005

History Associated with Mountmellick Branch of Grand Canal (opened 1831; closed 1960). Cited as 'Lea Bridge' on 1838 OS six-inch map and subsequent editions (Laois sheet 5).

Survey date 22/08/2006 Surveyor Fred Hamond

Ownership

Completeness No visible remains Condition N/A Current use N/A

Description Site of bridge carrying public road over canal. Demolished c.20 years ago and canal infilled hereabouts for agricultural use. Superseded by road over the infilled bed a short distance west of this former bridge.

Evaluation No industrial heritage significance.

Significance Record only

Statutory protection Action

Other databases IWAI MMC 070; LAIAR-005-014

Feature F107

Site type Bridge (canal/river)

County Co Laois Townland Bracklone

Town Address

Grid 256152 211648 OS six-inch sheet LA 005

History Associated with Mountmellick Branch of Grand Canal (opened 1831; closed 1960). Cited as 'aqueduct' on 1838 and 1888 OS six-inch maps (Laois sheet 5).

Survey date 22/08/2006 Surveyor Fred Hamond

Ownership

Completeness No visible remains Condition N/A Current use N/A

Description Site of culvert carrying drainage channel under canal.

Evaluation No industrial heritage significance.

Significance Record only

Statutory protection Action

Other databases LAIAR-005-041

Feature F108

Site type Bridge (canal/river)

County Co Laois Townland Bridge (canal/river)

Town Address

Grid 255609 211713 OS six-inch sheet LA 005

History Associated with Mountmellick Branch of Grand Canal (opened 1831; closed 1960). Cited as 'aqueduct' on 1838 and 1888 OS six-inch maps (Laois sheet 5).

Survey date 22/08/2006 Surveyor Fred Hamond

Ownership Private

Completeness Complete Condition Fair Current use Culvert

Description Culvert carries drainage channel under canal, here dewatered. Arch is of segmental-headed profile and c.1.2m wide. It and the spandrels are of dressed limestone blocks laid to courses. The wing walls are of similarly dressed stone, but laid randomly. No parapet. Drainage channel heavily silted but still functioning.

Evaluation Group association with canal. Of local industrial heritage significance.

Significance Local

Statutory protection Action

Other databases LAIAR-005-040

Photographs
F108_01 22/08/2006 South elevation of culvert.



Feature F201a Portarlington Lock; 2nd lock

Site type Lock
 County Co Laois Townland Bracklone
 Town Portarlington Address
 Grid 255395 211642 OS six-inch sheet LA 005

History Associated with Mountmellick Branch of Grand Canal (opened 1831; closed 1960). Shown on 1838 OS six-inch map and subsequent editions (Laois sheet 5).

Survey date 22/08/2006 Surveyor Fred Hamond

Ownership Private

Completeness Some remains Condition Fair Current use Disused

Description Only part of the north-west side wall of this single chamber lock, the 2nd on this branch line, now survives. Three courses of dressed limestone blocks are visible above the footpath which runs alongside the main road down the infilled canal bed. At the SW end of this wall is the recess for the upper gate. Recessed into this recess is an emplacement for a vertical sluice gate; this was presumably to drain the upper reach.

Evaluation On its own, this feature would be of local industrial heritage significance. However, the juxtaposition of quay, lock house and goods store gives it a group value which raises its significance to regional level. Merits inclusion in the Record of Protected Structures.

Significance Regional

Statutory protection Action Include in RPS

Other databases IWAI MMC 090; LAIAR-005-011

Photographs
 F201_01 22/08/2006 General view of complex from north-east.



F201_02 22/08/2006 General view of complex from south.



F201a_01 22/08/2006 Lock wall.



Feature	F201b			Lock Bridge
Site type	Bridge (road/canal)			
County	Co Laois	Townland	Bracklone	
Town	Portarlinton	Address		
Grid	255411 211652	OS six-inch sheet	LA 005	
History	Associated with Mountmellick Branch of Grand Canal (opened 1831; closed 1960). Cited as 'bridge' on 1838 and 1888 OS six-inch maps and as 'Lock Bridge' on 1907 edition (Laois sheet 5).			
Survey date	22/08/2006	Surveyor	Fred Hamond	
Ownership				
Completeness	No visible remains	Condition	N/A	Current use N/A
Description	This bridge carried a public road over the north-east end of the 2nd lock (201a). Demolished to make way for a new road running directly across the infilled canal bed.			
Evaluation	No industrial heritage significance.			
Significance	Record only			
Statutory protection	Action			
Other databases	IWAI MMC 080; LAIAR-005-011			

Feature F201c Portarlington Lock House

Site type	Lock keeper's house		
County	Co Laois	Townland	Bracklone
Town	Portarlington	Address	
Grid	255381 211652	OS six-inch sheet	LA 005
History	Associated with Mountmellick Branch of Grand Canal (opened 1831; closed 1960). Shown on 1838 OS six-inch map (Laois sheet 5) and explicitly cited as 'Lock house' on 1888 edition.		
Survey date	22/08/2006	Surveyor	Fred Hamond
Ownership	Private		
Completeness	Complete	Condition	Fair
		Current use	Disused
Description	Detached double-pile, three-bay, single-storey over semi-basement former lock keeper's house. Aligned NE-SW with its principal elevation facing towards the lock (feature 201a). Hipped natural slate roof with rendered chimney to each pile, boxed eaves and plastic gutters. Painted cement-rendered walls over random rubble. Principal façade is symmetrical, with semicircular-headed doorway to centre. Flanked by semicircular-headed windows to each end bay, set in segmental-headed recesses. All openings now sheeted over' the windows have sandstone cills. The SW elevation has two semicircular-headed window openings; the right-hand one is set in a segmental-headed recess. The NW and NE elevations are abutted by a modern flat-roofed extensions.		
Evaluation	Although the modern extension and refurbishment detract from the architectural character of this house, it is essentially complete and still of historical interest. It also has ground value with the adjoining lock, quay and goods store and is of regional heritage significance. Merits inclusion in the Record of Protected Structures.		
Significance	Regional		
Statutory protection		Action	Include in RPS
Other databases	LAIAR-005-011		

Photographs

F201c_01 22/08/2006 SE façade of lock house.



F201c_02 22/08/2006 NW elevation of lock house, from south-west.



Feature F201d

Site type Quay
County Co Laois Townland Bracklone
Town Portarlinton Address
Grid 255361 211628 OS six-inch sheet LA 005

History Associated with Mountmellick Branch of Grand Canal (opened 1831; closed 1960).

Survey date 22/08/2006 Surveyor Fred Hamond

Ownership Private

Completeness Complete Condition Fair Current use Disused

Description Quay at south-west end of 2nd lock. The bed has been infilled, but upper section of wall still visible. The top two courses are of dressed limestone blocks, regularly laid; the lower courses are of squared rubble, laid randomly. Small sections of brick admixture denote later repairs. Goods store (feature 204) is located directly on SW end of quay wall.

Evaluation Although the canal basin has been infilled, this quay is a reminder of the canal's former commercial importance. It has group value with the lock, lock house and canal store and merits inclusion in the Record of Protected Structures because of its regional heritage significance.

Significance Regional

Statutory protection Action Include in RPS

Other databases IWAI MMC 095; LAIAR-005-011

Photographs
F201d_01 22/08/2006 Quay from south.



Feature F201e

Site type Canal store

County Co Laois Townland Bracklone

Town Portarlinton Address

Grid 255345 211620 OS six-inch sheet LA 005

History Associated with Mountmellick Branch of Grand Canal (opened 1831; closed 1960). Not shown on 1838 OS six-inch map (Laois sheet 5). Cited as 'goods store' on 1888 and 1907 editions.

Survey date 22/08/2006 Surveyor Fred Hamond

Ownership Private

Completeness Complete Condition Fair Current use Disused

Description Detached three-bay, two-storey former goods store aligned NE-SW at south end of quay, just above 2nd lock. Pitched natural slate roof with raised dressed limestone verges. Chimney pot to NE gable. Vestiges of metal gutters. Random rubble walls with dressed limestone eaves and dressed quoins. The principal façade faces SE on to the former canal, here infilled. This elevation has a large segmental headed loading door to the middle of the ground floor; dressed jambs and head. Between the ground and first floors are the timber socket holes for a canopy which formerly ran across the façade. The SW gable is devoid of openings. The NW elevation has a segmental-headed door to ground floor centre (dressed jambs and head) and a square-headed loading door above (dressed jambs). Both doors are flanked by single square-headed windows, all with brick heads and jambs, and stone cills. The ground floor openings have metal-framed casement windows. The first floor openings have timber shutters and vertical metal security bars. The NE gable is abutted by a three-bay, single-storey shed. There is an original square-headed internal doorway between the two buildings. The latter has a pitched corrugated metal roof and similarly-clad timber framed walls (but with concrete blockwork to the road elevation). Doors to front and rear elevations. No internal access to main building.

Evaluation Although disused, this building is complete and the only surviving goods store on this branch canal. Although architecturally plain, it is nevertheless typical of the design of such utilitarian buildings. It also has historical interest in its association with the canal, and streetscape value. It also has group value with the adjoining lock, lock house and quay. It merits inclusion in the Record of Protected Structures on account of its regional heritage interest.

Significance Regional

Statutory protection Action Include in RPS

Other databases IWAI MMC 097; LAIAR-005-011

Photographs

F201e_01 22/08/2006 Goods store from north-east.



F201e_02 22/08/2006 Goods store from south.



F201e_03 22/08/2006 Goods store from north.



F201e_04 22/08/2006 Goods store from north.



Feature	F202	Swing Bridge
----------------	-------------	---------------------

Site type Bridge (road/canal)

County Co Laois Townland Cooltedery

Town Portarlinton Address Station Road, Portarlinton

Grid 254733 211165 OS six-inch sheet LA 005

History Associated with Mountmellick Branch of Grand Canal (opened 1831; closed 1960). Cited as 'Draw bridge' on 1838 and 1888 OS six-inch maps (Laois sheet 5), and as 'Swing bridge' on 1907 edition. Removed c.1970 when the Portarlinton Relief Road was built. According to Mr Ronnie Mathews, a Portarlinton-based local historian, it swung horizontally on a pivot mounted on the town side of the canal bank to let the barges through. It was manually operated.

Survey date 29/06/2006 Surveyor Fred Hamond

Ownership

Completeness No visible remains Condition N/A Current use N/A

Description Bridge carrying public road over canal has been completely cleared to make way for a wider road over the infilled canal.

Evaluation No industrial heritage significance.

Significance Record only

Statutory protection Action

Other databases IWAI MMC 100; LAIAR-005-009

Feature F203

Site type Bridge (rail/canal); Bridge (rail/road)

County Co Laois Townland Cooltedery

Town Portarlinton Address

Grid 254218 211175 OS six-inch sheet LA 005

History Portarlinton to Tullamore section of line opened 1854 (extended to Athlone 1859). First shown on 1888 OS six-inch map (Laois sheet 5). Now in use as the Dublin-Galway line. Deck probably replaced in 20th century (but before 1953 as shown in present form in photograph of this date).

Survey date 29/06/2006 Surveyor Fred Hamond

Ownership Public (Iarnród Éireann)

Completeness Complete Condition Excellent Current use Railway bridge

Description A slightly skew triple-span girder bridge carries a single-track railway from Portarlinton to Tullamore over the former canal, now infilled to create a by-pass road around Portarlinton. The abutments and piers are of rock-faced limestone blocks laid to courses and embellished with tooled arrises. The towpath which formerly ran through the south side of the middle span has been removed and the pier faced with cement. Tow rope marks are still visible at both ends. The decks comprise plate girders along each side, with metal troughing between. The north span runs over a field accommodation track. The south span is partly infilled with soil. The north, middle and south spans measure 9.91m, 3.66m and 3.65m respectively (all measured orthogonally). Although the deck is only 4.30m in depth, the abutments are 9.45m (on the skew); in other words, the bridge was built to accommodate two tracks, but only one was laid. Curved wing walls of squared random rubble coped with dressed stones and terminating in square piers. Iarnród Éireann bridge number 551.

Evaluation Only the abutments and piers are original, the deck having been replaced. The bridge is of some interest in being the only example of a railway bridge over this branch of the Grand Canal. This is now only evident in the rope marks on the quoins. It is also a prominent landscape feature along the infilled canal. Of local industrial heritage significance.

Significance Local

Statutory protection Action IHAI photos

Other databases IWAI MMC 110; LAIAR-005-006

References Orford, D. Those Were the Days: Memories of Portarlinton, 1900 to 1999, p.99. Portarlinton: Portarlinton Historical Society. N.D.

Photographs

F203_01 29/06/2006 General view from west.



F203_02 29/06/2006 General view from east.



F203_03 29/06/2006 Tow rope marks on south-east pier of middle span.



F203_04 29/06/2006 Deck underside. Note transverse metal troughing.



Feature F204 Ballymorris Bridge

Site type	Bridge (road/canal)		
County	Co Laois	Townland	Ballymorris; Cooltedery
Town	Portarlinton	Address	
Grid	254076 211145	OS six-inch sheet	LA 005
History	Associated with Mountmellick Branch of Grand Canal (opened 1831; closed 1960). Shown on 1838 and 1888 OS six-inch maps (Laois sheet 5), but explicitly named until 1907 edition.		
Survey date	29/06/2006	Surveyor	Fred Hamond
Ownership			
Completeness	No visible remains	Condition	N/A
		Current use	N/A
Description	Bridge carrying public road over canal demolished when canal infilled to create road by-pass around Portarlinton.		
Evaluation	No industrial heritage significance.		
Significance	Record only		
Statutory protection	Action		
Other databases	IWAI MMC 120; LAIAR-005-008		

Feature F205

Site type Bridge (canal/river)

County Co Laois Townland Ballymorris

Town Address

Grid 253152 210818 OS six-inch sheet LA 004

History Associated with Mountmellick Branch of Grand Canal (opened 1831; closed 1960). Cited as 'aqueduct' on 1839 OS six-inch map and subsequent editions (Laois sheet 4).

Survey date 29/06/2006 Surveyor Fred Hamond

Ownership Public (Laois CC)

Completeness Complete Condition Poor Current use Culvert

Description A twin-arched culvert carries a stream under the now-demolished bed of the Mountmellick Canal. Of squared random limestone construction. Arches are of segment profile with dressed voussoirs; each spans 90cm. Cutwaters are squared, not angled. Most of south-east face has collapsed. Channels now heavily choked with silt and heavily overgrown.

Evaluation Primarily of historical interest due to canal association. Local industrial heritage significance.

Significance Local

Statutory protection Action

Other databases LAIAR-004-011

Photographs

F205_01 29/06/2006 Decayed south-east face of culvert.



Feature	F206	Blackhall Bridge; {Moore's Bridge}			
Site type	Bridge (road/canal)				
County	Co Laois	Townland	Ballymorris		
Town	Address				
Grid	253129 210796	OS six-inch sheet	LA 004		
History	Associated with Mountmellick Branch of Grand Canal (opened 1831; closed 1960). Cited as 'Moore's Bridge' on 1839 and 1888 OS six-inch maps, and as 'Blackhall Bridge' on 1907 edition (Laois sheet 4). Attempts to demolish the bridge after the canal closed in 1960 were abandoned and what remained was restored by a local community committee as a millennium project in 2000.				
Survey date	29/06/2006	Surveyor	Fred Hamond		
Ownership	Public (Laois CC)				
Completeness	Substantial remains	Condition	Good	Current use	Ornamental feature
Description	Masonry arch bridge formerly carried public road over now-infilled section of Mountmellick Branch of Grand Canal. Now by-passed by a new section of road to its south-west. Although the bed of the canal under the bridge has been infilled to within 30cm of the tops of the side walls, the bridge was restored in 2000 and is now a distinctive landmark on the way into Portarlinton from the south. Of randomly coursed squared limestone rubble. The arch is slightly skew and of semicircular profile, with finely dressed voussoirs. It spans 6.69m (22ft) measured orthogonally, and 7.00m (23ft) on the skew. Although skew, the squared soffit blocks are laid orthogonally. A 1.71m wide (5ft 7in) towpath runs through its south-east side; the channel is 4.98m wide (16ft 4in) at this point; its edge is coped with large blocks of limestone. Both spandrels and the curved wing walls have been largely rebuilt in squared limestone rubble (of slightly darker colour than the original). The tops of the out-stepped terminal piers have been removed along with the decorative string course which originally ran under the parapets; much of the north wing and pier have been removed entirely. The parapets have been rebuilt in concrete blockwork, faced with stone, and coped with concrete; they are 6.16m (20ft 3in) apart. Humped deck. No datestones. The approach road has been removed at the north end.				
Evaluation	The architectural interest of this bridge is diminished somewhat by the introduced stone (necessitated by its partial demolition in 1970) and use of concrete blockwork in its refurbishment. Nevertheless it is still of historical interest and a well-known landmark hereabouts. It is of regional industrial heritage significance and its current inclusion in the Record of Protected Structures is justified (RPS LA 542).				
Significance	Regional				
Statutory protection	RPS LA 542	Action			
Other databases	IWAI MMC 130; LAIAR-004-010; NIAH 12800401				

Photographs

F206_01 29/06/2006 Plaque commemorating restoration of bridge.



F206_02 29/06/2006 Blackhall Bridge from south-west.



F206_03 29/06/2006 Blackhall Bridge from north.



F206_04 29/06/2006 Blackhall Bridge from east.



F206_05 29/06/2006 Soffit detail.



F206_06 29/06/2006 Tow rope marks on east quoin.



- References
- Orford, D. Those Were the Days: Memories of Portarlinton, 1900 to 1999, p.249. Portarlinton: Portarlinton Historical Society. N.D.
 - Orford, D. Those Were the Days: Memories of Portarlinton, 1900 to 1999, p.76. Portarlinton: Portarlinton Historical Society. N.D.
 - Somers, P. 'Major initiative planned for former Portarlinton canal bridge'. In The Leinster Express, 3 July 1999.
 - Survey of the Architectural Heritage of County Laois (Dublin: NIAH, 2002).

Feature F207 Woodbrook Bridge

Site type	Bridge (road/canal)		
County	Co Laois	Townland	Coolnavarnoge and Coolaghy
Town	Address		
Grid	251545 210266	OS six-inch sheet	LA 004
History	Associated with Mountmellick Branch of Grand Canal (opened 1831; closed 1960). Although shown on the 1839 and 1888 OS six-inch maps, not explicitly named until 1907 edition (Laois sheet 4). Old photographs show it to have been a standard masonry arch bridge, similar to those elsewhere on the canal.		
Survey date	29/06/2006	Surveyor	Fred Hamond
Ownership			
Completeness	No visible remains	Condition	N/A
		Current use	N/A
Description	The bridge carrying a public road over the canal has been demolished and a wider road constructed across this now-infilled section of canal.		
Evaluation	No industrial heritage significance.		
Significance	Record only		
Statutory protection	Action		
Other databases	IWAI MMC 140; LAIAR-004-009		
References	Orford, D. Those Were the Days: Memories of Portarlinton, 1900 to 1999, p.244. Portarlinton: Portarlinton Historical Society. N.D.		

Feature F208

Site type Canal feeder

County Co Laois Townland Various

Town Address

Grid 253033 208757 OS six-inch sheet LA 004; LA 008

History Associated with Mountmellick Branch of Grand Canal (opened 1831; closed 1960). Cited as "Canal supply" on 1839 OS six-inch map and subsequent editions (Laois sheets 4 and 8).

Survey date 29/06/2006 Surveyor Fred Hamond

Ownership Private

Completeness Substantial remains Condition Poor Current use Disused

Description Now-dry feeder channel, runs along south-west side of road. Approximately 2m wide and up to 2m deep. Heavily overgrown. Infilled where crossed by track into Woodbrook Forest and again between railway embankment and new line of road. Although not inspected in detail outside the study area, presumed to be open on basis of aerial photographs.

Evaluation Local industrial heritage significance.

Significance Local

Statutory protection Action

Other databases LAIAR-004-018; LAIAR-008-006

Photographs

F208_01 29/06/2006 Looking south from north end inside overgrown channel.





Map of feeder showing associated features.

Feature F208a

Site type Bridge (canal feeder/river)

County Co Laois Townland Coolnavarnoge and Coolaghy

Grid 251889 209924 OS six-inch sheet LA 004

History Associated with Mountmellick Branch of Grand Canal (opened 1831; closed 1960). Shown on 1839 and 1888 OS six-inch maps and cited as 'aqueduct on 1907 edition (Laois sheet 4).

Survey date 29/06/2006 Surveyor Fred Hamond

Ownership Private

Completeness Substantial remains Condition Poor Current use Culvert

Description An arched culvert carries a stream under a now-dry canal feed immediately SW of a minor road. Of random rubble construction. Arch is of semicircular profile, with brick voussoirs; 76cm span. The soffit directly under the feeder has been breached so that any water in the latter now drains into the stream. The stream is carried under the road north-east of the aqueduct as a 30cm wide random rubble culvert; its north-east end has been removed.

Evaluation Local industrial heritage significance.

Significance Local

Statutory protection Action

Other databases LAIAR-004-024

Photographs
F208a_01 29/06/2006 South-west elevation of canal culvert.



Feature F208b

Site type Bridge (road/canal feeder)
County Co Laois Townland Coolnavarnoge and Coolaghy
Town Address
Grid 252236 209468 OS six-inch sheet LA 004

History Associated with Mountmellick Branch of Grand Canal (opened 1831; closed 1960). Shown on 1839 OS six-inch map and subsequent editions (Laois sheet 4).

Survey date 29/06/2006 Surveyor Fred Hamond
Ownership Public (Laois CC)
Completeness Complete Condition Fair Current use Road bridge

Description A highly skew two-arch culvert carries a public road over a canal feeder south-west of Skeagh Crossroads. Of random rubble construction. Arches are of segmental profile and have finely dressed voussoirs. Pier is square-cut, not angled. Each arch is 90cm wide (measured orthogonally). Parapet is coped with limestone blocks; some mass-concrete repairs. The intake at the upstream end of the south-west arch has been infilled during landscaping of the garden of an adjoining house. Heavily vegetated on upstream face.

Evaluation Primarily of historical interest due to canal association. Local industrial heritage significance.

Significance Local

Statutory protection Action

Other databases

Photographs
F208b_01 29/06/2006 Downstream (north-west) elevation.





Feature F208c

Site type Bridge (rail/canal feeder)
County Co Laois Townland Coolaghy; Kilbride
Town Address
Grid 252855 209161 OS six-inch sheet LA 004

History Shown on 1838 OS six-inch map (Laois sheet 4) as a culvert under a road. When the Portarlinton-Portlaoise line was built by the Great Southern & Western Railway Cot in 1847, the road was realigned and a culvert constructed under the new embankment.

Survey date 30/08/2006 Surveyor Fred Hamond
Ownership Private
Completeness Complete Condition Fair Current use Culvert

Description A culvert conveys the canal feed under the railway embankment. Arch is of segmental profile and spans 1.52m. Voussoirs are of dressed masonry but otherwise of random rubble throughout. Dressed string course runs across the crown. No parapet. Slightly curved as it runs under the embankment.

Evaluation Local industrial heritage significance.

Significance Local

Statutory protection Action

Other databases

Photographs
F208c_01 30/08/2006 South-east face of culvert under railway embankment.



Feature	F208d				
Site type	Bridge (road/canal feeder)				
County	Co Laois	Townland	Coolaghy; Kilbride		
Town	Address				
Grid	252878	209148	OS six-inch sheet	LA 004	
History	This culvert was not built until the railway was constructed in 1847 and the road realigned.				
Survey date	30/08/2006	Surveyor	Fred Hamond		
Ownership					
Completeness	No visible remains	Condition	N/A	Current use	N/A
Description	The road has been realigned and the earlier stretch removed along with this culvert.				
Evaluation	No industrial heritage significance.				
Significance	Record only				
Statutory protection	Action				
Other databases					

Feature F208e

Site type Bridge (road/canal feeder)
County Co Laois Townland Coolaghy; Kilbride
Town Address
Grid 252920 209101 OS six-inch sheet LA 004

History Constructed in connection with a late 1900s realignment of the road.

Survey date 30/08/2006 Surveyor Fred Hamond
Ownership Public (Laois CC)
Completeness Complete Condition Good Current use Culvert
Description A concrete pipe conveys a new line of road over the canal feeder.

Evaluation No special industrial heritage significance.

Significance Record only

Statutory protection Action

Other databases

Photographs
F208e_01 30/08/2006 South-west face of pipe culvert under road.



Feature F209

Site type Bridge (canal/river)

County Co Laois Townland Coolnavarnoge and Coolaghy

Town Address

Grid 251065 209914 OS six-inch sheet LA 004

History Associated with Mountmellick Branch of Grand Canal (opened 1831; closed 1960). Cited as 'aqueduct' on 1839 OS six-inch map and subsequent editions (Laois sheet 4).

Survey date 29/06/2006 Surveyor Fred Hamond

Ownership Private

Completeness Complete Condition Good Current use Culvert

Description Arched culvert carries stream under bed of now-filled canal. Constructed in squared limestone rubble brought to courses. Arch is of segmental profile and has dressed voussoirs; 90cm span. Heavily vegetated at SE end.

Evaluation Still serves original purpose and marks line of now-gone section of canal. Local industrial heritage significance.

Significance Local

Statutory protection Action

Other databases LAIAR-004-008

Photographs

F209_01 29/06/2006 General view of culvert from north-west.





Feature F301a Tinnakill Lock; 3rd lock

Site type Lock
 County Co Laois Townland Coolnavarnoge and Coolaghy
 Town Address
 Grid 250570 209508 OS six-inch sheet LA 004

History Associated with Mountmellick Branch of Grand Canal (opened 1831; closed 1960). Shown on 1839 and 1888 OS six-inch maps (Laois sheet 4) and explicitly named as 'Tinnakill Lock' on 1907 edition.

Survey date 29/06/2006 Surveyor Fred Hamond

Ownership Private

Completeness Substantial remains Condition Poor Current use Disused

Description Lock chamber infilled to near ground level and vestiges of squared limestone rubble side walls now only visible at north-east end. Copings have been removed along with north-east end of walling. The walls are spaced at 4.57m (15ft).

Evaluation Primarily of historical interest. Also has group value in context of adjacent lock house and canal in general. Regional industrial heritage significance, meriting inclusion in Record of Protected Structures.

Significance Regional

Statutory protection Action Include in RPS

Other databases IWAI MMC 150; LAIAR-004-007

Photographs

F301_01 29/06/2006 Lock house and lock remains, from north-east.



F301a_01 29/06/2006 Lock remains, from south-west.



Feature F301b Tinnakill Lock Bridge

Site type Bridge (foot/canal)

County Co Laois Townland Coolnavarnoge and Coolaghy

Town Address

Grid 250587 209521 OS six-inch sheet LA 004

History Associated with Mountmellick Branch of Grand Canal (opened 1831; closed 1960). Cited as 'bridge' on 1839 and 1888 OS six-inch maps; not named on any edition (Laois sheet 4).

Survey date 29/06/2006 Surveyor Fred Hamond

Ownership

Completeness No visible remains Condition N/A Current use N/A

Description All traces of this bridge, at the NE end of the lock chamber, have been removed.

Evaluation No industrial heritage significance.

Significance Record only

Statutory protection Action

Other databases LAIAR-004-007

Feature	F301c	Tinnakill Lock House			
Site type	Lock keeper's house				
County	Co Laois	Townland	Coolnavarnoge and Coolaghy		
Town	Address				
Grid	250567 209524	OS six-inch sheet	LA 004		
History	Associated with Mountmellick Branch of Grand Canal (opened 1831; closed 1960). Cited as 'lock house' on 1839 and 1888 OS six-inch maps (Laois sheet 4).				
Survey date	29/06/2006	Surveyor	Fred Hamond		
Ownership	Private				
Completeness	Complete	Condition	Poor	Current use	Disused
Description	<p>Detached three-bay, two-storey disused lock keeper's house. Aligned NE-SW on NW side of now-infilled lock chamber. Hipped natural slate roof with central brick chimney. Rainwater goods missing. Lime-rendered random rubble walls with projecting dressed masonry eaves and dressed quoins. Square-headed openings. Principal façade faces SE towards lock chamber. Doorway to centre of this façade with replacement partly glazed timber door. Flanked by window opening to each side, both set in segment-headed recesses. The windows are 2/2 sliding sashes with stone cills. Small window to SW gable and rear elevation of NE bay. NE gable abutted by single-bay annexe over semi-basement. This section has monopitched natural slate roof and walls detailed as main block. Possibly contemporary with same, even though distinct wall break. Two-over-two window on façade elevation and on NE gable. Internally, the floor is of timber, stone flags and concrete and the walls are painted and plastered. Original tongue-and-groove doors survive. NE bay contains kitchen. Replacement suspended ceiling. Cast-iron stove in party wall with SW bay. Door leads through to (bedroom) annexe on NE gable. SW bay contains former bedroom. Original plaster-and-lathe ceiling. Fireplace on party wall with NE bay, complete with timber surround and bracketed timber mantelpiece. Annex has remains of stove (pipe runs up outside of wall) on ground floor and storeroom in semi-basement. Despite distance from public road, has been electrified.</p>				
Evaluation	Of architectural interest as an example of a former lock house. Also of historical interest due to association with canal. Group value with adjoining lock and the canal in general. Of regional industrial heritage significance. Merits inclusion in Record of Protected Structures.				
Significance	Regional				
Statutory protection			Action	Include in RPS	
Other databases	IWAI MMC 150; LAIAR-004-007				

Photographs

F301c_01 29/06/2006 Lock house from east.



F301c_02 29/06/2006 Lock house from north.



F301c_03 29/06/2006 NE bay of house (kitchen), looking south.



F301c_04 29/06/2006 SW bay of house (bedroom), looking east.



Feature F302

Site type Bridge (canal/river)

County Co Laois Townland Tinnakill (Po. By.)

Town Address

Grid 250062 209149 OS six-inch sheet LA 004

History Associated with Mountmellick Branch of Grand Canal (opened 1831; closed 1960). Cited as 'aqueduct' on 1839 and 1888 OS six-inch maps (Laois sheet 4).

Survey date 30/08/2006 Surveyor Fred Hamond

Ownership Private

Completeness Complete Condition Fair Current use Culvert

Description Culvert carries drainage channel under canal. Measures 60cm wide by c.90cm high. Comprises flat stone lintels over abutments. The first two metres at the SE end comprise a slightly higher shallow segmental arch. Spandrels and wing walls are of regularly coursed squared limestone rubble.

Evaluation Local industrial heritage significance.

Significance Local

Statutory protection Action

Other databases LAIAR-004-023

Photographs
F302_01 30/08/2006 South-east face of culvert under canal.



Feature F303 Skeagh Bridge

Site type	Bridge (road/canal)		
County	Co Laois	Townland	Tinnakill (Po. By.)
Town	Address		
Grid	249488 208931	OS six-inch sheet	LA 008
History	Associated with Mountmellick Branch of Grand Canal (opened 1831; closed 1960). Cited as 'Skeagh Bridge' on 1839 OS six-inch map and subsequent editions (Laois sheet 8).		
Survey date	29/06/2006	Surveyor	Fred Hamond
Ownership	Private		
Completeness	Complete	Condition	Fair
		Current use	Disused
Description	<p>Masonry arch bridge formerly carried accommodation road over now-disused section of Mountmellick Branch of Grand Canal. Of randomly coursed squared limestone rubble. The arch is of semicircular profile but has been largely buried under later infill, along with most of the west face from beneath the arch crown. The arch's soffit is of squared rubble and its voussoirs are of finely dressed stone. A now-buried towpath runs through its south side. Both faces of the bridge curve outwards to terminate in out-projecting piers embellished with finely dressed string course which continues around outside base of parapets. Some stone has been illegally removed from the south-west pier. The parapets are coped with finely dressed limestone blocks and their inside faces are spaced at 3.32m. Humped deck. No datestones. Heavy ivy overgrowth on east face. The approach roads have been removed at both ends and the bridge has been superseded to its west by a metalled road across an infilled section of the canal.</p>		
Evaluation	Of architectural and historical merit. Also enhances local landscape. Regional industrial heritage significance. Merits inclusion in record of Protected Structures.		
Significance	Regional		
Statutory protection		Action	Include in RPS
Other databases	IWAI MMC 160; LAIAR-008-030		

Photographs

F303_01 29/06/2006 Skeagh Bridge from south-east. Note damaged pier at right and removed approach road.



F303_02 29/06/2006 West elevation of Skeagh Bridge.



F303_03 29/06/2006 Skeagh Bridge from north-west.



F303_04 29/06/2006 South-west terminal pier detail.



Feature F304

Site type Bridge (canal/river)
County Co Laois Townland Dangans; Tinnakill (Po. By.)
Town Address
Grid 249120 208452 OS six-inch sheet LA 008

History Associated with Mountmellick Branch of Grand Canal (opened 1831; closed 1960). Shown on 1839 OS six-inch map and subsequent editions (Laois sheet 8).

Survey date 29/06/2006 Surveyor Fred Hamond
Ownership Private
Completeness Complete Condition Fair Current use Culvert

Description Pipe culvert carries stream under canal bed. North-west elevation inspected. Metal pipe, c.60cm diameter (2ft). Mass concrete spandrel without parapet. Channel now very silted up.

Evaluation The north-west end at least is undoubtedly a replacement of the original culvert (parts of which may still survive under the canal). Group value in context of canal, but of local industrial heritage significance only.

Significance Local

Statutory protection Action

Other databases

Photographs
F304_01 29/06/2006 North-west elevation of culvert.



Feature F305 Dangans Bridge

Site type Bridge (road/canal)
 County Co Laois Townland Dangans
 Town Address
 Grid 249013 208376 OS six-inch sheet LA 008

History Associated with Mountmellick Branch of Grand Canal (opened 1831; closed 1960). Cited as 'Dangans Bridge' on 1839 OS six-inch map and subsequent editions (Laois sheet 8).

Survey date 14/06/2006 Surveyor Fred Hamond
 Ownership Public (Laois CC)
 Completeness Complete Condition Good Current use Road bridge

Description Masonry arch bridge carries public road over now-disused section of Mountmellick Branch of Grand Canal. Of randomly coursed squared limestone rubble. The arch is of semicircular profile measures 6.70m in span by 7.26m in depth. Its soffit is of squared rubble and the voussoirs and quoins are of finely dressed stone. A 1.74m wide towpath runs through the south side (the channel is 4.96m wide). Both faces of the bridge curve outwards to terminate in out-projecting piers embellished with finely dressed string course which continues around outside base of parapets. The inside faces of the parapets are of random rubble and are spaced at 6.50m; they are coped with finely dressed limestone blocks. Humped deck. No datestones. Heavy ivy overgrowth.

Evaluation Of architectural and historical merit. Regional industrial heritage significance. Merits inclusion in Record of Protected Structures.

Significance Regional

Statutory protection Action Include in RPS

Other databases IWAI MMC 170; LAIAR-008-029

Photographs
 F305_01 14/06/2006 Dangans Bridge: east elevation.



F305_02 14/06/2006 Dangans Bridge: inside of arch, from west.



F305_03 14/06/2006 Towpath underneath Dangans Bridge.



Feature F306

Site type Bridge (canal/river)
County Co Laois Townland Clonterry; Kilnacash
Town Address
Grid 248379 207876 OS six-inch sheet LA 008

History Associated with Mountmellick Branch of Grand Canal (opened 1831; closed 1960).
Shown on 1839 OS six-inch map and subsequent editions (Laois sheet 8).

Survey date 14/06/2006 Surveyor Fred Hamond
Ownership Private
Completeness Complete Condition Fair Current use Culvert

Description Culvert carries 1.2m wide drainage channel under now-disused Mountmellick Branch of Grand Canal. North-west face inspected - only squared random rubble spandrel now visible; probably a flat head. Overgrown.

Evaluation Local industrial heritage significance.

Significance Local

Statutory protection Action

Other databases LAIAR-008-028

Photographs
F306_01 14/06/2006 North-west elevation of culvert.



Feature F307 Kilnacash Bridge

Site type Bridge (road/canal)
 County Co Laois Townland Kilnacash
 Town Address
 Grid 248071 207602 OS six-inch sheet LA 008

History Associated with Mountmellick Branch of Grand Canal (opened 1831; closed 1960). Cited as 'Kilnacash Bridge' on 1839 OS six-inch map and subsequent editions (Laois sheet 8).

Survey date 14/06/2006 Surveyor Fred Hamond
 Ownership Private
 Completeness Complete Condition Fair Current use Disused

Description Masonry arch bridge carries now-abandoned accommodation road over defunct Mountmellick Branch of Grand Canal. Of randomly coursed squared limestone rubble. The arch is of semicircular profile measures 6.75m in span by 4.12m in depth. Its soffit is of squared rubble and the voussoirs and quoins are of finely dressed stone. A 2.01m wide towpath runs through the south side (the channel is 4.74m wide). Towrope marks visible on south-west quoin. Both faces of the bridge curve outwards to terminate in out-projecting piers embellished with finely dressed string course which continues around outside base of parapets. The inside faces of the parapets are of random rubble. Parapet on west side now partly missing. Surviving sections are coped with finely dressed limestone blocks. Humped deck. No datestones. Now bypassed to east by a road across the infilled bed. Heavy ivy overgrowth.

Evaluation Of architectural and historical merit. Regional industrial heritage significance. Merits inclusion in Record of Protected Structures.

Significance Regional

Statutory protection Action Include in RPS

Other databases IWAI MMC 180; LAIAR-008-027

Photographs
 F307_01 14/06/2006 Kilnacash Bridge from west.



F307_02

14/06/2006

Quoin detail at south-west corner of Kilnacash Bridge. Note towrope marks.



Feature F308

Site type Canal feeder

County Co Laois Townland Kilnacash

Town Address

Grid 248274 205323 OS six-inch sheet LA 008

History Associated with Mountmellick Branch of Grand Canal (opened 1831; closed 1960). Captioned "Canal supply" on 1839 OS six-inch map and subsequent editions (Laois sheet 8).

Survey date 14/06/2006 Surveyor Fred Hamond

Ownership Private

Completeness Substantial remains Condition Poor Current use Disused

Description Canal feeder survives as dry ditch along field boundaries. Formerly fed off Triogue River. Measures 2-4m wide by 1-1.5m deep. Infilled on either side of Supply Bridge (MMC 12) and at intervals thereafter.

Evaluation Local industrial heritage significance.

Significance Local

Statutory protection Action

Other databases LAIAR-008-046

Photographs

F308_01 14/06/2006 Looking north along section of canal feeder to south of Rock School (follows hedge line).





Map of feeder showing associated features.

Feature F308a Supply Bridge

Site type Bridge (road/canal feeder)

County Co Laois Townland Kilnacash

Town Address

Grid 247914 207432 OS six-inch sheet LA 008

History Associated with Mountmellick Branch of Grand Canal (opened 1831; closed 1960). Shown on 1839 and 1888 OS six-inch maps (Laois sheet 8). Explicitly cited as "Supply Bridge" on 1907 edition.

Survey date 14/06/2006 Surveyor Fred Hamond

Ownership Public (Laois CC)

Completeness Some remains Condition Good Current use Road bridge

Description Single arch bridge carries main road over canal feeder. Now infilled and faces buried except for top of arch on north side. This appears to be of semicircular profile and 1.0-1.2m wide, with finely dressed limestone voussoirs. Random rubble parapet wall over. Otherwise marked by slight bump in road.

Evaluation Local industrial heritage significance.

Significance Local

Statutory protection Action

Other databases LAIAR-008-026

Photographs
 F308a_01 14/06/2006 North elevation of Supply Bridge.



Feature F308b

Site type Bridge (road/canal feeder)

County Co Laois Townland Kilmainham

Town Address

Grid 247821 206717 OS six-inch sheet LA 008

History Shown on 1839 OS six-inch map and subsequent editions (Laois sheet 8).

Survey date 30/08/2006 Surveyor Fred Hamond

Ownership

Completeness No visible remains Condition N/A Current use N/A

Description Line of feeder infilled to both sides. No visible traces of culvert which formerly carried the canal feeder under a minor road. May possibly be buried.

Evaluation No industrial heritage significance.

Significance Record only

Statutory protection Action

Other databases

Feature F308c

Site type Bridge (road/canal feeder)

County Co Laois Townland Brittas

Town Address

Grid 248004 205904 OS six-inch sheet LA 008

History Shown on 1839 OS six-inch map and subsequent editions (Laois sheet 8).

Survey date 30/08/2006 Surveyor Fred Hamond

Ownership

Completeness No visible remains Condition N/A Current use N/A

Description The original culvert which carried the canal feeder under a minor road has been replaced in the relatively recent past by a concrete pipe.

Evaluation No industrial heritage significance.

Significance Record only

Statutory protection Action

Other databases

Feature	F308d				
Site type	Weir (canal feeder)				
County	Co Laois	Townland	Eyne		
Town	Address				
Grid	247574	204433	OS six-inch sheet	LA 008	
History	Shown on 1839 OS six-inch map (Laois sheet 8). Explicitly cited as 'dam' on 1907 edition.				
Survey date	30/08/2006	Surveyor	Fred Hamond		
Ownership					
Completeness	No visible remains	Condition	N/A	Current use	N/A
Description	The weir which formerly diverted water off the Triogue River has been removed and the river dredged.				
Evaluation	No industrial heritage significance.				
Significance	Record only				
Statutory protection	Action				
Other databases					

Feature F309 Mountmellick Aqueduct

Site type Bridge (canal/river)
 County Co Laois Townland Debicot; Kilmainham
 Town Address
 Grid 247585 207521 OS six-inch sheet LA 008

History Associated with Mountmellick Branch of Grand Canal (opened 1831; closed 1960). Shown on 1839 OS six-inch map and cited as 'aqueduct' on 1888 and 1907 editions (Laois sheet 8).

Survey date 14/06/2006 Surveyor Fred Hamond
 Ownership Private
 Completeness Complete Condition Fair Current use Culvert

Description Triple-arch bridge carries former Mountmellick Branch of Grand Canal over Triogue River. Ashlar limestone abutments and piers. Equi-sized spans (each about 2.5-3m across) are of segmental profile and embellished with vee-jointed voussoirs (not limestone). Rounded cutwaters at both ends, embellished with finely dressed limestone string courses. Random rubble spandrels. Ashlar string course over crowns, surmounted by ashlar limestone parapet. Approximately 20m deep. Heavy ivy overgrown. Tree roots now dislodging facing stones.

Evaluation Of architectural and historical merit. Regional industrial heritage significance. Current inclusion in Record of Protected Structures merited (RPS LA 531).

Significance Regional
 Statutory protection RPS LA 531 Action

Other databases IWAI MMC 190; LAIAR-008-023; NIAH 12800839

Photographs
 F309_01 14/06/2006 Mountmellick Aqueduct from south.



F309_02 14/06/2006 Mountmellick Aqueduct from upstream (south) side.



F309_03 14/06/2006 Mountmellick Aqueduct from downstream (north) side.



F309_04 14/06/2006 Looking east across Mountmellick Aqueduct.



References Survey of the Architectural Heritage of County Laois (Dublin: NIAH, 2002).

Feature	F310	Debicot Bridge
----------------	-------------	-----------------------

Site type Bridge (road/canal)

County Co Laois Townland Strahard

Town Address

Grid 246876 207715 OS six-inch sheet LA 008

History Associated with Mountmellick Branch of Grand Canal (opened 1831; closed 1960). Cited as 'Debicot Bridge' on 1839 OS six-inch map and subsequent editions (Laois sheet 8).

Survey date 14/06/2006 Surveyor Fred Hamond

Ownership Private

Completeness Complete Condition Fair Current use Disused

Description Masonry arch bridge formerly carried accommodation road over now-infilled section of Mountmellick Branch of Grand Canal. Of randomly coursed squared limestone rubble. The arch is of semicircular profile and spans c.6.74m. Its soffit is of squared rubble and the voussoirs and quoins are of finely dressed stone. A towpath runs through the south side (now buried along with bed of canal). Both faces of the bridge curve outwards to terminate in out-projecting piers embellished with finely dressed string course which continues around outside base of parapets. The inside faces of the parapets are of random rubble and are spaced at 3.46m; they are coped with finely dressed limestone blocks. Humped deck. No datestones. The approach roads have been removed at both ends and the bridge is now bypassed to east by a track across the infilled bed. Heavy ivy overgrowth.

Evaluation Of architectural and historical merit. Regional industrial heritage significance. Merits inclusion in Record of Protected Structures.

Significance Regional

Statutory protection Action Include in RPS

Other databases IWAI MMC 200; LAIAR-008-022

Photographs

F310_01 14/06/2006 Debicot Bridge, from south-west.



F310_02 14/06/2006 Debicot Bridge, from north-east.



F310_03 14/06/2006 Debicot Bridge: north-east terminal pier detail.



Feature F311

Site type Bridge (canal/river)

County Co Laois Townland Strahard

Town Address

Grid 246436 207739 OS six-inch sheet LA 008

History Associated with Mountmellick Branch of Grand Canal (opened 1831; closed 1960). Cited as 'aqueduct' on 1839 OS six-inch map and subsequent editions (Laois sheet 8). Still extant in 1976.

Survey date 14/06/2006 Surveyor Fred Hamond

Ownership

Completeness No visible remains Condition N/A Current use N/A

Description The canal banks have been demolished and its bed infilled. No visible traces of former aqueduct which carried canal over drainage ditch.

Evaluation No industrial heritage significance.

Significance Record only

Statutory protection Action

Other databases LAIAR-008-021

Feature F312a

Site type Canal basin
County Co Laois Townland Ballycullenbeg
Town Mountmellick Address Harbour Street
Grid 246135 207751 OS six-inch sheet LA 008

History Terminus of Mountmellick Branch of Grand Canal (opened 1831; closed 1960). Shown on 1839 and 1888 OS six-inch maps (Laois sheet 8); cited as 'canal terminus' on 1907 edition. It was infilled prior to 1976.

Survey date 14/06/2006 Surveyor Fred Hamond

Ownership

Completeness No visible remains Condition N/A Current use N/A

Description Basin infilled. Site now used as scrap yard and waste recycling depot.

Evaluation No industrial heritage significance.

Significance Record only

Statutory protection Action

Other databases IWAI MMC 210; LAIAR-008-020

Photographs
F312_01 14/06/2006 Canal basin and stores (from D'Arcy book).



Feature	F312b				
Site type	Quay				
County	Co Laois	Townland	Ballycullenbeg		
Town	Mountmellick	Address	Harbour Street		
Grid	246183	207733	OS six-inch sheet	LA 008	
History	Associated with terminus of Mountmellick Branch of Grand Canal (opened 1831; closed 1960). Shown on 1839 and 1888 OS six-inch maps (Laois sheet 8); cited as 'quay' on 1907 edition.				
Survey date	14/06/2006	Surveyor	Fred Hamond		
Ownership					
Completeness	No visible remains	Condition	N/A	Current use	N/A
Description	Basin infilled and no visible remains of quay. Site now used as scrap yard and waste recycling depot.				
Evaluation	No industrial heritage significance.				
Significance	Record only				
Statutory protection	Action				
Other databases	IWAI MMC 210; LAIAR-008-020				

Feature F312c

Site type Canal store

County Co Laois Townland Ballycullenbeg

Town Mountmellick Address Harbour Street

Grid 246125 207733 OS six-inch sheet LA 008

History Associated with terminus of Mountmellick Branch of Grand Canal (opened 1831; closed 1960). Shown on 1839 and 1888 OS six-inch maps (Laois sheet 8); cited as 'canal stores' in 1907 edition. Demolished sometime after 1985. Old photographs shows four buildings along the south edge of the basin (two-, three- and four-storeys high).

Survey date 14/06/2006 Surveyor Fred Hamond

Ownership Private (MSM Recycling Ltd).

Completeness Some remains Condition Good Current use Scrap yard

Description Remains of former canal stores along south side of canal basin. Demolished save for truncated remains of east, south and west walls. Random rubble limestone walls with ashlar limestone quoin (with string course) at south-west corner. The walls have been lowered and are now coped with concrete blocks. Segmental- and square-headed brick-trimmed doors and windows discernible, but all now infilled with concrete blocks; one of the window openings has a sandstone cill. A new vehicle entrance has been cut through the west wall. The walls have been extended in concrete blockwork to enclose the scarp yard which now occupies the site.

Evaluation The significance of this building is diminished by its incompleteness and it is now only of local industrial heritage significance. Already included in Record of Protected Structures (RPS LA 687).

Significance Local

Statutory protection RPS LA 687 Action

Other databases IWAI MMC 210; LAIAR-008-020; NIAH 12800801

Photographs
F312c_01 14/06/2006 Canal stores, from south-east.





Feature	F312d	Canal House
Site type	House (canal related)	
County	Co Laois	Townland Ballycullenbeg
Town	Mountmellick	Address Harbour Street
Grid	246075 207757	OS six-inch sheet LA 008
History	Associated with terminus of Mountmellick Branch of Grand Canal (opened 1831; closed 1960). Cited as 'Collector's Office' on 1839 and 1888 OS six-inch maps (Laois sheet 4) and as 'Harbour House' on 1907 edition. Its current owner, Mr Bill Lawlor, is the son of the last canal agent.	
Survey date	14/06/2006	Surveyor Fred Hamond
Ownership	Private (Mr Bill Lawlor)	
Completeness	Complete	Condition Excellent Current use Dwelling
Description	Detached three-bay, two-storey former Grand Canal agent's house, with single-bay, two-storey return, to which a matching three-bay, two-storey extension has been added in recent times. The construction of the latter entailed the demolition of a single-storey lean-to on the west gable of the return. Original section is aligned north-south at east end of block and formerly overlooked west end of canal basin. It is now separated from the basin by a modern concrete wall and is in different ownership. Hipped replacement artificial slate roof and over-sailing bracketed eaves to all sections. The original house has an ashlar limestone chimney, and the extension a concrete one. Half-round metal rainwater goods. Walls were originally lime washed, but all are now cement harled (over masonry in the case of the original sections). Smooth-rendered basal course and ashlar limestone string course at first floor level (replicated in concrete in the extension). Square-headed openings. The main doorway is in the corner of the return. Replacement uPVC windows. Stone cills to original section and concrete ones to extension. Ashlar gate piers at north end of house into rear yard.	
Evaluation	One of the most intact buildings on the Mountmellick Branch of the Grand Canal. Excepting the replacement windows, all modifications are sympathetic to the building's original character. Regional industrial heritage significance. Merits inclusion in Record of Protected Structures.	
Significance	Regional	
Statutory protection		Action Include in RPS
Other databases	LAIAR-008-020	

Photographs

F312d_01 14/06/2006 Canal House, from south-east. The right-hand block is original, that at left the modern extension.



F312d_02 14/06/2006 Canal House, from north-east. Note gate into yard.



F312d_03 14/06/2006 Canal House before extension (courtesy Mr Bill Lawlor).



APPENDIX 6:
OTHER BUILT HERITAGE FEATURES

Feature F901 Grand Canal (Athy Branch)

Site type Canal
 County Co Kildare Townland Monasterevin; Skirteen
 Town Monasterevin Address
 Grid 262252 210610 OS six-inch sheet KL 021; KL 026

History The Athy Branch (also called the Barrow Line) of the Grand Canal was constructed by the Grand Canal Company between 1783 and 1791 in order to link up the main Dublin-Shannon line with the River Barrow. The section from Lowtown, on the main line, to Monasterevin was opened in 1785. However, the Barrow was found to be too shallow for navigation, so the canal was continued on to Athy, from where the river was made navigable. At Monasterevin, barges descended through a lock to the river, crossed it and ascended up through another lock to the canal on the opposite bank. This system was made redundant with the opening of the Barrow Aqueduct in 1826.

Survey date 22/08/2006 Surveyor Fred Hamond
 Ownership Public (Waterways Ireland)
 Completeness Complete Condition Excellent Current use Canal

Description The Athy Branch of the Grand Canal runs from Lowtown, on the main Dublin-Shannon line, to Athy. The section in the vicinity of Mountmellick Junction is in recreational use, with towpaths on either side.

Evaluation Of national industrial heritage significance. Merits inclusion in Kildare CC Record of Protected Structures.

Significance National

Statutory protection Action Include in RPS

Other databases

Photographs
 F901_01 22/08/2006 Looking east along Grand Canal from Mountmellick Junction.



F901_02 22/08/2006 Looking south along Grand Canal from Mountmellick Junction.



F901_03 22/08/2006 Looking south-west along Grand Canal from bridge (feature 901d).



Feature	F901a	Draw Bridge
----------------	--------------	--------------------

Site type	Bridge (road/canal)		
County	Co Kildare	Townland	Monasterevin
Town	Monasterevin	Address	
Grid	262425 210656	OS six-inch sheet	KL 026
History	<p>According to Samuel Lewis (Topographical Dictionary of Ireland, 1837, vol.2, page 386), the original bridge was erected in 1829. He describes it as "an elegant cast-iron drawbridge over the canal". This cast iron bridge has evidently been replaced with a steel structure, probably in the mid 1900s. Marked on the 1838 OS six-inch map and subsequent editions (Kildare sheet 26).</p>		
Survey date	22/08/2006	Surveyor	Fred Hamond
Ownership	Public (Kildare CC)		
Completeness	Substantial remains	Condition	Good
		Current use	Road bridge
Description	<p>Metal girder bridge carries road over Athy Branch of Grand Canal immediately east of Barrow Aqueduct. Comprises a metal girder span which is raised by two electrically-operated pulleys running over steel uprights on north side. Originally the bridge was raised manually, with a hinged counterweight on top to facilitate its raising. This was removed on safety grounds when the bridge was electrified.</p>		
Evaluation	<p>Local industrial heritage significance. Interest has been diminished by removal of overhead counterbalance. Is included in the Monasterevin Record of Protected Structures (IP 22).</p>		
Significance	Local		
Statutory protection	RPS Monasterevin IP 22	Action	
Other databases	NIAH 11816003		

Photographs

F901a_01 22/08/2006 Draw bridge from east.



F901a_02 22/08/2006 Draw bridge, from west.



Feature F901b Barrow Aqueduct

Site type Bridge (canal/river)
 County Co Kildare Townland Monasterevin; Skirteen
 Town Monasterevin Address
 Grid 262359 210639 OS six-inch sheet KL 026

History Opened 1826. Superseded the locking system down to and up from the Barrow. Marked on the 1838 OS six-inch map and subsequent editions (Kildare sheet 26).

Survey date 22/08/2006 Surveyor Fred Hamond
 Ownership Public (Waterways Ireland)
 Completeness Complete Condition Good Current use Canal aqueduct

Description This three-arch aqueduct carries the Athy Branch of the Grand Canal over the River Barrow. Abutments, piers, spandrels and wing walls are of ashlar limestone. The arches are of shallow segmental profile and have vee-jointed dressed stone voussoirs. Rounded cutwaters. A platband runs across the crown of the arches and is surmounted by a cantilevered footpath on both sides of the canal. Wrought-iron railings.

Evaluation National industrial heritage significance. Merits its current inclusion in the Monasterevin Record of Protected Structures (IP 48).

Significance National

Statutory protection RPS Monasterevin IP 48 Action

Other databases NIAH 11816004

Photographs
 F901b_01 22/08/2006 Barrow Aqueduct, from south-east.



F901b_02 22/08/2006 Barrow Aqueduct, from south-west.



F901b_03 22/08/2006 Looking east across Barrow Aqueduct.



Feature F901c

Site type Lock
County Co Kildare Townland Skirteen
Town Monasterevin Address
Grid 262318 210430 OS six-inch sheet KL 026

History Built by the Grand Canal Company c.1785. Marked on the 1838 OS six-inch map and subsequent editions (Kildare sheet 26).

Survey date 22/08/2006 Surveyor Fred Hamond
Ownership Public (Waterways Ireland)
Completeness Complete Condition Good Current use Lock

Description This lock, no.25 on the system (as measured from Dublin), is a short distance downstream from Mountmellick Junction. It comprises a single chamber faced with regularly coursed ashlar limestone. Both pairs of gates are steel replacements, with a sluice and timber lever to each gate. An accommodation bridge crosses the south end of the chamber (feature 901d).

Evaluation Group value with bridge. Regional industrial heritage significance. Merits inclusion in Kildare CC Record of Protected Structures.

Significance Regional

Statutory protection Action Include in RPS

Other databases NIAH 11816102

Photographs
F901c_01 22/08/2006 Looking north along lock chamber.



Passage of barge through lock (photographs by John Feehan, 2006)



Feature F901d

Site type Bridge (foot/canal)

County Co Kildare Townland Skirteen

Town Monasterevin Address

Grid 262328 210413 OS six-inch sheet KL 026

History Built by the Grand Canal Company c.1785. Marked on the 1838 OS six-inch map and subsequent editions (Kildare sheet 26).

Survey date 22/08/2006 Surveyor Fred Hamond

Ownership Public (Waterways Ireland)

Completeness Complete Condition Good Current use Foot bridge

Description A single arch bridge carries an accommodation track over the south end of the lock (feature 901c). Its abutments are a continuation of the side of the lock chamber and are of regularly coursed ashlar limestone. The voussoirs of the arch, which is of segmental profile, spandrels, parapets and their copings are similarly constructed. A dressed stone string course runs across the outside faces of the parapets. The walls curve outwards to terminate in plain piers. Deck is humped.

Evaluation Group value with lock. Regional industrial heritage significance. Merits inclusion in Kildare CC Record of Protected Structures.

Significance Regional

Statutory protection Action Include in RPS

Other databases NIAH 11816101

Photographs

F901d_01 22/08/2006 Bridge at lock, from south-west. Note lock house at right.





Feature F901e

Site type Lock keeper's house

County Co Kildare Townland Skirteen

Town Monasterevin Address

Grid 262326 210433 OS six-inch sheet KL 026

History The lock house was originally built by the Grand Canal Company c.1785. It is marked on the 1838 OS six-inch map and subsequent editions (Kildare sheet 26). This is probably a later 20th century replacement.

Survey date 22/08/2006 Surveyor Fred Hamond

Ownership Public (Waterways Ireland)

Completeness Complete Condition Good Current use Dwelling

Description Four-bay, single-storey former lock keeper's house on east side of lock. Aligned north-south with principal elevation facing west to chamber. Replacement pitched tiled roof with two rendered chimneys. Cement-harled walls. Square-headed openings; replacement uPVC windows. At the time of survey a single-storey extension was being added to the rear elevation.

Evaluation No special industrial heritage significance.

Significance Record only

Statutory protection Action

Other databases

Photographs

F901e_01 22/08/2006 Lock-keeper's house, from south-west.



Feature F901f Moore's Bridge

Site type Bridge (road/canal)
 County Co Kildare Townland Monasterevin
 Town Monasterevin Address
 Grid 262444 210605 OS six-inch sheet KL 026

History Erected 1784. When the Barrow Aqueduct was opened in 1826, this section of canal down to the Barrow became redundant. However, the bridge was retained rather than demolished. Marked as "Moore's Br." on the 1838 OS six-inch map and subsequent editions (Kildare sheet 26).

Survey date 22/08/2006 Surveyor Fred Hamond
 Ownership Public (Kildare CC)
 Completeness Complete Condition Good Current use Road bridge

Description A single masonry span carries the road over a now-infilled section of the Athy Branch of the Grand Canal a short distance south-east of the Barrow Aqueduct. It is of random rubble construction. On the east side, only the top of the dressed stone arch is visible. Above the crown is an inscribed stone reading "Moore's Bridge 1784". The west side is partly open and used as a store by the occupant of the adjoining house. There is now no trace of the line of the canal and associated lock down to the Barrow.

Evaluation This survival is now the only tangible evidence of the line of the canal prior to the construction of the Barrow Aqueduct. It survives complete, albeit partly buried and has an attested date. It is of regional industrial heritage significance and merits inclusion in the Monasterevin Record of Protected Structures.

Significance Regional
 Statutory protection Action Include in RPS

Other databases NIAH 11816006

Photographs
 F901f_01 22/08/2006 East face of Moore's Bridge (canal infilled).



Feature F901g

Site type House (canal related)

County Co Kildare Townland Monasterevin

Town Monasterevin Address

Grid 262441 210741 OS six-inch sheet KL 021

History Built by the Grand Canal Company, probably in the 1780s. Marked on the 1837 OS six-inch map and subsequent editions (Kildare sheet 21).

Survey date 22/08/2006 Surveyor Fred Hamond

Ownership Private

Completeness Complete Condition Excellent Current use Apartments

Description A modern housing development on the west side of the Athy Branch of the Grand Canal incorporates a three-storey, three-bay building formerly belonging to the agent of the Grand Canal Company. This building is aligned north-south on the west side of the canal. Pitched slate roof with raised verges and cement-rendered chimneys. Random rubble walls. Square-headed openings. The principal elevation faces east on to the canal and is symmetrical with a semicircular-headed doorway to ground floor centre (with spoked overlight) and replacement 1/1 sliding sash windows to the two end bays and the floor above.

Evaluation Regional industrial heritage significance. Included in the Monasterevin Record of Protected Structures (IP 23).

Significance Regional

Statutory protection RPS Monasterevin IP 23 Action

Other databases NIAH 11816002

Photographs

F901g_01 22/08/2006 General view of canal-related house and quay, from south-east.





Feature F901h Monasterevin Quay

Site type Quay

County Co Kildare Townland Monasterevin

Town Monasterevin Address

Grid 262471 210727 OS six-inch sheet KL 021

History Built by the Grand Canal Company, probably in the 1780s. Marked on the 1837 OS six-inch map and subsequent editions (Kildare sheet 21).

Survey date 22/08/2006 Surveyor Fred Hamond

Ownership Private

Completeness Complete Condition Excellent Current use Quay

Description Random-rubble quay along west side of canal. There were originally two rubble stone warehouses, one at either end of the quay. They were demolished in 2000 to make way for new apartments.

Evaluation Of regional industrial heritage merit. Merits inclusion in Monasterevin RPS.

Significance Regional

Statutory protection Action Include in RPS

Other databases NIAH 11816002

Photographs

F901h_01 Warehouses. After Kevin Dwyer (2000), *Ireland - the Inner Island: a Journey through Ireland's Waterways*, p.48 (Cork: Collins Press).



Feature F902 Barrow Bridge

Site type Bridge (rail/river)
 County Co Kildare Townland Coolnafearagh; Passland
 Town Monasterevin Address
 Grid 262300 210789 OS six-inch sheet KL 021

History This line was opened as far as Portlaoise by the Great Southern & Western Railway in 1847 (it reached Cork in 1849). The stonework is original, but the deck is a mid/late 20th century replacement. Cited as "Iron Br." on the 1837 OS six-inch map and subsequent editions (Kildare sheet 21).

Survey date 22/08/2006 Surveyor Fred Hamond
 Ownership Public (Iarnród Éireann)
 Completeness Complete Condition Good Current use Rail bridge

Description A nine-span metal girder bridge carries the Dublin-Cork line over the River Barrow. The abutments and tapered piers are of rock-faced limestone blocks laid to regular courses and embellished with tooled arrises. The tops of the abutments and piers are embellished with a moulded string course over which concrete pillow blocks have been case to carry the ends of the spans. Both end sections span public roads; sections 6, 7 and 8 (as measured from the east end) span the river. Each section is made up of four RSJs with cantilevered footplates; these have replaced the original structure. The wing walls, which curve outwards and downwards, are of coursed finely dressed limestone blocks. Iarnród Éireann bridge number 398.

Evaluation This is a significant landmark hereabouts and of regional industrial heritage significance. Merits inclusion in the Monasterevin Record of Protected Structures.

Significance Regional
 Statutory protection Action Include in RPS

Other databases NIAH 11816001

Photographs
 F902_01 22/08/2006 Barrow Railway Bridge, from north (upstream elevation).



F902_02 22/08/2006 Pier detail at west end of Barrow Bridge.



F902_03 22/08/2006 Abutment detail at west end of Barrow Bridge.



Feature F903 Pass Bridge

Site type Bridge (road/river)

County Co Kildare Townland Coolnafearagh; Passland

Town Monasterevin Address

Grid 262243 210993 OS six-inch sheet KL 021

History Probably of 18th century construction. Cited as "Pass Br." on the 1837 OS six-inch map and subsequent editions (Kildare sheet 21).

Survey date 22/08/2006 Surveyor Fred Hamond

Ownership Public (Kildare CC)

Completeness Complete Condition Good Current use Road bridge

Description A five-arch bridge carries a road over the River Barrow. Of random rubble throughout, the arches are of semicircular profile. They have dressed voussoirs and rise in height to the middle of the bridge, thus creating a strongly humped deck. Angled cutwaters underpinned with concrete. The narrowness of the bridge and its blind hump have necessitated the introduction of traffic lights for safety reasons.

Evaluation A good example of an 18th or early 19th century road-over-river bridge and a prominent local landmark. Of regional industrial heritage significance. Merits current inclusion in Monasterevin Record of Protected Structures (IP 47).

Significance Regional

Statutory protection RPS Monasterevin IP 47 Action

Other databases NIAH 11816100

Photographs
 F903_01 22/08/2006 Pass Bridge from south-east (downstream elevation).



Feature F904

Site type Mile marker

County Co Laois Townland Clonanny

Town Address

Grid 260278 211122 OS six-inch sheet LA 005

History First cited on 1907 OS six-inch map (Laois sheet 5), but probably of 19th century date.

Survey date 22/08/2006 Surveyor Fred Hamond

Ownership

Completeness No visible remains Condition N/A Current use N/A

Description Site of milestone on Monasterevin-Portarlinton road.

Evaluation No industrial heritage significance.

Significance Record only

Statutory protection Action

Other databases LAIAR-005-019

Feature F905 Balladoogara Fort

Site type Earthwork
County Co Laois Townland Clonanny
Town Address
Grid 259307 210782 OS six-inch sheet LA 005

History Cited as 'Balladoogara Fort' on 1838 OS six-inch map (Laois sheet 5).

Survey date 22/08/2006 Surveyor Fred Hamond

Ownership

Completeness No visible remains Condition N/A Current use N/A

Description No upstanding remains of earthwork are now visible.

Evaluation A Recorded Monument (RMP LA005-008---)

Significance Regional

Statutory protection RMP LA005-008--- Action

Other databases SMR LA005-008---

References Sweetman, P.D., Alcock, O. and Moran, B. Archaeological Inventory of County Laois, p.63 (entry 611). Dublin: Stationery Office, 1995.

Feature F906**Kilmullen House**

Site type House
County Co Laois Townland Kilmullen
Town Address
Grid 258570 210622 OS six-inch sheet LA 005

History Cited as 'Kilmullen House' on 1838 OS six-inch map (Laois sheet 5).

Survey date 22/08/2006 Surveyor Fred Hamond

Ownership Private

Completeness Complete Condition Excellent Current use Dwelling

Description Detached two-storey house; five bays to ground floor and six to first floor. Aligned NW-SE with its principal elevation facing NW towards the road. Hipped natural slate roof with two rendered chimneys and half-round metal gutters. Painted cement-rendered walls. Square-headed openings (except main entrance). The front elevation is symmetrical. Entrance door to centre (four raised and fielded panels), set in semicircular opening with timber doorcase, aproned sidelights and overlight. The side- and overlights are embellished with decorative lead tracery. All windows to this elevation are 6/6 timber sliding sashes. There is a two-bay, two-storey return to the middle of the rear elevation. Farmyard to south-east of house. Set in landscaped grounds.

Evaluation An imposing, well-maintained house. Entrance doorway of particular note. Its status as a Protected Structure (LA 550) is merited.

Significance Regional

Statutory protection RPS LA 550 Action

Other databases NIAH 12800556

Photographs

F906_01 22/08/2006 Principal elevation of Kilmullen House.





Feature	F907					Lea Mill
Site type	Grain mill (water)					
County	Co Laois	Townland	Lea			
Town						Address
Grid	257655	212308	OS six-inch sheet		LA 005	
History	Cited as 'Corn mill' on 1838 OS six-inch map but not shown on 1888 or 1907 editions (Laois sheet 5).					
Survey date	28/07/2005	Surveyor	Fred Hamond			
Ownership						
Completeness	No visible remains	Condition	N/A	Current use	N/A	
Description	No traces of mill survive.					
Evaluation	No industrial heritage significance					
Significance	Record only					
Statutory protection						Action
Other databases	LAIAR-005-035					

Feature F908 **Lea Church**

Site type Church; Graveyard
 County Co Laois Townland Loughmansland Glebe
 Town Address
 Grid 257490 211957 OS six-inch sheet LA 005

History Cited as 'Lea Church (in ruins)' on 1838 OS six-inch map (Laois sheet 5).

Survey date 22/08/2006 Surveyor Fred Hamond

Ownership Unknown

Completeness Substantial remains Condition Poor Current use Disused

Description Disused graveyard of square plan, enclosed by low random rubble wall. Approached from west through semicircular masonry arch (with wrought-iron gate). Various 18th and 19th century grave slabs, laid horizontally and vertically. In middle of graveyard is random rubble fragment of building. Too little now survives to be certain that once part of the former church. Now neglected and overgrown.

Evaluation This site is included in the Record of Monuments and Places (RMP LA005-007---).

Significance Regional

Statutory protection RMP LA005-007--- Action

Other databases SMR LA005-007---

Photographs
 F908_01 22/08/2006 Entrance to Lea Graveyard.



F908_02 22/08/2006 Surviving fragment of Lea Church.



F908_03 22/08/2006 Gravestones In Lea Graveyard.



References Sweetman, P.D., Alcock, O. and Moran, B. Archaeological Inventory of County Laois, p.86 (entry 777). Dublin: Stationery Office, 1995.

Feature F909**Lea Castle House**

Site type House
County Co Laois Townland Lea
Town Address
Grid 257243 211955 OS six-inch sheet LA 005

History Shown on 1838 OS six-inch map (Laois sheet 5).

Survey date 22/08/2006 Surveyor Fred Hamond

Ownership Private

Completeness Complete Condition Poor Current use Disused

Description Detached three-bay, two-storey house aligned east-west, with principal façade facing south. Hipped natural slate roof, two rendered chimneys and vestiges of half-round metal gutters. Cement rendered random rubble walls with advanced eaves. Square-headed openings (except main doorway). Façade is symmetrical and has main entrance doorway to centre, set in a semicircular opening. The door is sheeted over. Flanked by a window to each end bay, with three windows to first floor; those which survive are 6/6 timber sliding sashes with internal shutters. All have stone cills. At centre of rear (north) elevation is a two-bay, two-storey return, similarly detailed and with rendered brick chimney to north gable. No internal access.

Evaluation Although derelict, this building is of local heritage significance.

Significance Local

Statutory protection RPS LA 549 Action

Other databases NIAH 12800555

Photographs

F909_01 22/08/2006 Lea Castle House, from south-west.





Feature F910 **Lea Castle**

Site type Castle
 County Co Laois Townland Lea
 Town Address
 Grid 257101 212041 OS six-inch sheet LA 005

History Cited as 'Lea Castle (in ruins)' on 1838 OS six-inch map (Laois sheet 5). According to Archaeological Survey, probably built in first quarter of 13th century. Samuel Lewis (Topographical Dictionary of Ireland, 1837) notes that it was the main administrative centre for this region prior to the inception of Portarlinton in the reign of Charles II.

Survey date 22/08/2006 Surveyor Fred Hamond
 Ownership Private
 Completeness Substantial remains Condition Poor Current use Disused

Description Ruinous remains of a once substantial castle. At west is a four-storey keep, now roofless. Random rubble walls, in excess of 1.7m thick. Two circular bastions to east elevation. The west and south walls have collapsed. Two barrel-vaulted rooms to ground floor. Upper floors have collapsed. Intramural staircase. Outer ward, to east, is three storeys high. Also roofless and with random rubble walls. Two circular bastions to south elevation flanking a high semicircular-arched entrance between (formerly with portcullis). East wall of this structure survives, but north and west walls have collapsed, as have internal floors. Now all heavily overgrown with ivy.

Evaluation This impressive site is both a Recorded Monument (LA005-006---) and Protected Structure (LA 403).

Significance Regional
 Statutory protection RMP LA005-006---; RPS LA 403 Action

Other databases SMR LA005-006---

Photographs
 F910_01 22/08/2006 General view of complex from south-east.



F910_02 22/08/2006 East section, from north-west.



F910_03 22/08/2006 East elevation of west section, from south-east.



F910_04 22/08/2006 West section, from north.



F910_05 22/08/2006 Barrel-vaulted ground floor room in west section.



References Sweetman, P.D., Alcock, O. and Moran, B. Archaeological Inventory of County Laois, pp 108-109 (entry 936). Dublin: Stationery Office, 1995.

Feature F911

Site type Quarry (limestone)

County Co Laois Townland Lea

Town Address

Grid 257139 211412 OS six-inch sheet LA 005

History Small quarry shown along side of road on 1838 OS six-inch map (Laois sheet 5). Not explicitly cited as a quarry until 1907 edition.

Survey date 22/08/2006 Surveyor Fred Hamond

Ownership Private

Completeness Complete Condition Fair Current use Disused

Description Small limestone quarry on south side of road. Exposed vertical quarry face c.8m high at south end. Some infilling at north-east corner.

Evaluation No special industrial heritage significance.

Significance Record only

Statutory protection Action

Other databases LAIAR-005-015

Photographs
F911_01 22/08/2006 Quarry face from north-west.



Feature F912

Site type Mile marker

County Co Laois Townland Lea

Town Address

Grid 256368 211531 OS six-inch sheet LA 005

History First cited on 1907 OS six-inch map (Laois sheet 5), but probably of 19th century date.

Survey date 22/08/2006 Surveyor Fred Hamond

Ownership

Completeness No visible remains Condition N/A Current use N/A

Description Site of milestone on south side of Monasterevin-Portarlinton road.

Evaluation No industrial heritage significance.

Significance Record only

Statutory protection Action

Other databases LAIAR-005-013

Feature F913

Site type Earthwork

County Co Laois Townland Cooltedery

Town Portarlinton Address

Grid 255331 212002 OS six-inch sheet LA 005

History Circular earthwork shown on 1838 OS six-inch map (Laois sheet 5).

Survey date 22/08/2006 Surveyor Fred Hamond

Ownership

Completeness No visible remains Condition N/A Current use N/A

Description No upstanding traces of earthwork survive. The field has been reclaimed for agricultural use.

Evaluation This site is of archaeological interest and a Recorded Monument (RMP LA005-005---)

Significance Regional

Statutory protection RMP LA005-005--- Action

Other databases SMR LA005-005---

References Sweetman, P.D., Alcock, O. and Moran, B. Archaeological Inventory of County Laois, p.43 (entry 374). Dublin: Stationery Office, 1995.

Feature F914 Odlum's Mill; Portarlington Mill

Site type Grain mill (steam)
 County Co Laois Townland Cooltedery
 Town Portarlington Address Station Road, Portarlington
 Grid 254763 211194 OS six-inch sheet LA 005

History In 1876, Messrs Odlum opened a large double-pile multi-storey flour mill on the north bank of the Mountmellick branch of the Grand Canal at Portarlington. Cited on 1888 OS six-inch map as 'flour mill', and on 1907 edition as 'Portarlington flour mill'. According to Mr Loftus Odlum, the 1870s mill was destroyed by fire in 1900 and rebuilt in 1903. The extent of this destruction is uncertain. Roller mills (by Messrs Turners) had replaced millstones by 1913, if not before. A sketch in Milling magazine of Oct 1924 shows a large chimney, indicating that it was steam powered. Superseded by a producer gas engine until connected to ESB mains electricity supply in 1934. Twenty-one riveted steel grain bins (by Miag) were erected in 1935-37. The mill stopped in June 1977, to be replaced by a concrete-framed flour mill which started in November 1978. The remains of the original mill were incorporated in a new ancillary building. The new mill contains 12 Simon roller mills and produces bagged flour for the retail trade and bulk soft flour to Jacobs (for biscuit making). Although the mill operates under the Odlum name, the family sold their interest in 1989. The Odlum empire is now owned by Greencore and IAWS.

Survey date 29/06/2006 Surveyor Fred Hamond
 Ownership Private
 Completeness Complete Condition Good Current use Grain mill

Description Remains of an 1876 steam-powered flour mill incorporated in buildings behind a working flour mill of 1978. Site also encompasses ancillary 19th century buildings and also mid/late 20th century buildings and structures associated with grain intake, screening and storage, and flour bulk out-loading. See file 005-010 in Laois Industrial Archaeology Record for further details.

Evaluation The flour mills and grain silos are of architectural interest on account of their scale and range of materials. The site is also of historical interest in illustrating over a century of flour milling from the 1860s to 1970s and range of associated structures (e.g. silos). The complex is of technical interest as the only working flour mill left in the county, and one of the few still at work in Ireland. The assemblage of buildings is also a significant feature of the landscape hereabouts. Overall, the complex is of national industrial heritage interest and merits inclusion in the Record of Protected Structures. A more detailed descriptive and photographic survey of its internal features would also be warranted.

Significance National
Statutory protection Action Include in RPS

Other databases LAIAR-005-010

Photographs

F914_01 29/06/2006 Odlum's Mill from south-west.



F914_02 29/06/2006 Odlum's Mill from south-east.



References

Feehan, J. Laois: an Environmental History, p.363-364. Stradbally: Ballykilcavan Press, 1983.

Feehan, J. Laois: an Environmental History, p.365. Stradbally: Ballykilcavan Press, 1983.

Meehan, P.F. The Laois Millennium Year Book, p.20. 2000.

Milling, Oct 1924. Reproduced in A. Bielenberg (ed), Irish Flour Milling, p.131. Dublin: Lilliput Press, 2003.

Orford, D. Those Were the Days: Memories of Portarlinton, 1900 to 1999, p.101. Portarlinton: Portarlinton Historical Society. N.D.

Orford, D. Those Were the Days: Memories of Portarlinton, 1900 to 1999, p.224. Portarlinton: Portarlinton Historical Society. N.D.

Orford, D. Those Were the Days: Memories of Portarlinton, 1900 to 1999, p.226. Portarlinton: Portarlinton Historical Society. N.D.

Orford, D. Those Were the Days: Memories of Portarlinton, 1900 to 1999, p.43. Portarlinton: Portarlinton Historical Society. N.D.

Portarlinton Heritage Foundation. 1996 Calendar (Making the Past Work for the Future).

Redmond Photographic Collection, Laois County Library (Local Studies Dept), Portlaoise.

Takei, A. 'The political economy of the Irish flour-milling industry 1922 -1945'. In A. Bielenberg (ed), Irish Flour Milling, p.145. Dublin: Lilliput Press, 2003.

Feature F915 Russell's Saw Mill

Site type Saw mill (steam)
 County Co Laois Townland Cooltedery
 Town Portarlinton Address Station Road, Portarlinton
 Grid 254785 211100 OS six-inch sheet LA 005

History Not cited on 1907 OS six-inch map or previous editions. Probably built in 1910s - a photograph shows mill in operation in early 1920s.

Survey date 29/06/2006 Surveyor Fred Hamond
 Ownership Private
 Completeness Some remains Condition Fair Current use Store

Description The only surviving trace of this complex is the two-bay, three-storey former mill manager's house fronting Station Road.

Evaluation No special industrial heritage significance.

Significance Record only

Statutory protection Action

Other databases LAIAR-005-046

Photographs
 F915_01 29/06/2006 McMahon premises from south-west.



F915_02 28/07/2005 Manager's house, from west.



References Orford, D. Those Were the Days: Memories of Portarlinton, 1900 to 1999, p.39.
Portarlinton: Portarlinton Historical Society. N.D.
Orford, D. Those Were the Days: Memories of Portarlinton, 1900 to 1999, p.73.
Portarlinton: Portarlinton Historical Society. N.D.

Feature F916a Portarlington Station

Site type Station building
 County Co Laois Townland Cooltedery
 Town Portarlington Address Station Road, Portarlington
 Grid 254812 210898 OS six-inch sheet LA 005

History Although the railway line opened in 1847, this building was not completed until c.1850. Built by the Great Southern & Western Railway Co to design by Sancton Wood. Refurbished by Iarnród Éireann in 1995.

Survey date 29/06/2006 Surveyor Fred Hamond
 Ownership Public (Iarnród Éireann)
 Completeness Complete Condition Good Current use Railway station

Description Multi-bay, one- and two-storey station building on north side of line, incorporating ticket office, waiting room and station master's former house. Pitched natural slate roofs, brick and limestone chimneys, and decorative bargeboards and over-sailing eaves. Walls of dressed limestone blocks laid randomly. Square- and two-centred headed openings. Windows are fixed, 1/1 and 3/3 sliding sashes. Ornamental tower on platform side at west end. Open-sided waiting area on platform side.

Evaluation Of architectural, historical and social merit and of regional industrial heritage significance. Merits current inclusion in Record of Protected Structures (RPS LA 143).

Significance Regional
 Statutory protection RPS LA 143 Action

Other databases LAIAR-005-028; NIAH 12800502

Photographs
 F916_01 29/06/2006 Station complex from west.



F916_02 29/06/2006 Station complex from west.



F916_03 29/06/2006 Structures on north side of platform, from south-east.



F916_04 29/06/2006 Structures on south side of platform, from north-east.



F916a_01 29/06/2006 Station building (north), from north-west.





Feature F916b Portarlington Station

Site type Bridge (foot/rail)
 County Co Laois Townland Cooltedery
 Town Portarlington Address Station Road, Portarlington
 Grid 254820 210881 OS six-inch sheet LA 005

History Probably of earlier 20th century date.

Survey date 29/06/2006 Surveyor Fred Hamond

Ownership Public (Iarnród Éireann)

Completeness Complete Condition Good Current use Disused

Description A single-span metal lattice footbridge over double-track railway line at Portarlington Station. Span comprises T-section top and bottom strings between which is lattice bracing. Metal plates are laid across the bottom members to form the deck. The girders curve downwards at both ends to platforms supported on cast-iron columns, from which cast-iron steps lead down to the platforms. No longer in use, having been superseded by a modern footbridge to its east.

Evaluation Primarily of technical interest as a typical example of a station footbridge. Group value with rest of complex. Merits present inclusion in Record of Protected Structures (RPS LA 143_A).

Significance Regional

Statutory protection RPS LA 143_A Action

Other databases LAIAR-005-028; NIAH 12800502

Photographs

F916b_01 29/06/2006 Foot bridge from south-west.



Feature F916c Portarlington Station

Site type Station building
 County Co Laois Townland Cooltedery
 Town Portarlington Address Station Road, Portarlington
 Grid 254814 210863 OS six-inch sheet LA 005

History Although the main station building opened in c.1850, this building was not completed until 1861. Closed 1937.

Survey date 29/06/2006 Surveyor Fred Hamond

Ownership Public (Iarnród Éireann)

Completeness Complete Condition Good/Fair Current use Station building

Description Detached multi-bay one- and two-storey building along platform on south side of line, incorporating waiting room and former refreshment rooms and staff accommodation. Roof, walls and openings detailed as station building on opposite platform. Small metal water tank at north-west corner. Restaurant section characterised by deep hipped roof, but is now derelict.

Evaluation Of architectural merit. Group value with rest of station complex. Regional heritage interest. Merits current inclusion in Record of Protected Structures (RPS LA 143).

Significance Regional

Statutory protection RPS LA 143 Action

Other databases LAIAR-005-028; NIAH 12800502

Photographs

F916c_01 29/06/2006 Station building (south), from north-west.



Feature	F916d	Portarlington Station	
----------------	--------------	------------------------------	--

Site type	Platform		
County	Co Laois	Townland	Cooltedery
Town	Portarlington	Address	Station Road, Portarlington
Grid	254832 210884	OS six-inch sheet	LA 005
History	Opened 1847 by the Great Southern & Western Railway Co. There was originally a third line between those along each platform. This was used to hold the Athlone train whilst awaiting the main line trains. It was removed in 1976.		
Survey date	29/06/2006	Surveyor	Fred Hamond
Ownership	Public (Iarnród Éireann)		
Completeness	Complete	Condition	Good
		Current use	Platform
Description	Platforms on both sides of line, here doubled. Faced with random rubble and concrete blocks, with concrete copings.		
Evaluation	Group value with rest of station complex. Regional heritage interest. Merits current inclusion in Record of Protected Structures (RPS LA 143).		
Significance	Regional		
Statutory protection	RPS LA 143	Action	
Other databases	LAIAR-005-028; NIAH 12800502		

Feature F916e Portarlington Station

Site type Water tank

County Co Laois Townland Cooltedery

Town Portarlington Address Station Road, Portarlington

Grid 254796 210856 OS six-inch sheet LA 005

History Of 20th century date.

Survey date 29/06/2006 Surveyor Fred Hamond

Ownership Public (Iarnród Éireann)

Completeness Complete Condition Good Current use Disused

Description Freestanding raised water tank to west of station building on south side of line. Of welded steel and resting on RSJs supported on diagonally braced cast-iron columns. Probably no longer in use.

Evaluation Group value with rest of station complex. Regional heritage interest. Merits current inclusion in Record of Protected Structures (RPS LA 143).

Significance Regional

Statutory protection RPS LA 143 Action

Other databases LAIAR-005-028; NIAH 12800502

Photographs
 F916e_01 29/06/2006 Water tower from south-west.



Feature F916f Portarlington Station

Site type Goods shed
 County Co Laois Townland Cooltedery
 Town Portarlington Address Station Road, Portarlington
 Grid 254852 210904 OS six-inch sheet LA 005

History Opened c.1850 by the Great Southern & Western Railway Co. Probably designed by Sancton Wood, the station's architect. Goods services were discontinued in 1975 with the exception of sugar beet traffic.

Survey date 29/06/2006 Surveyor Fred Hamond
 Ownership Public (Iarnród Éireann)
 Completeness Complete Condition Good Current use Disused

Description Detached three-bay, single-storey goods shed aligned east-west to east of station building on north side of track. Pitched natural slate roof (on king-post trusses). Squared random rubble walls. Brick segmental-headed loco doors on each gable. Sliding doors to north elevation. Openings on platform side have been infilled. Raised loading platform internally. Small office annex on west gable. No longer in use but survives in good condition (evidence of roof repairs).

Evaluation Of architectural merit. Group value with rest of station complex. Regional heritage interest. Merits current inclusion in Record of Protected Structures (RPS LA 143).

Significance Regional
 Statutory protection RPS LA 143 Action

Other databases LAIAR-005-028; NIAH 12800502

Photographs
 F916f_01 29/06/2006 Goods shed from north-west.





Feature F916g Portarlington Station

Site type Canteen

County Co Laois Townland Cooltedery

Town Portarlington Address Station Road, Portarlington

Grid 254877 210898 OS six-inch sheet LA 005

History Opened c.1850 by the Great Southern & Western Railway Co. Probably designed by Sancton Wood, the station's architect.

Survey date 29/06/2006 Surveyor Fred Hamond

Ownership Public (Iarnród Éireann)

Completeness Complete Condition Good Current use Store

Description Detached three-bay, single-storey store at east end of station complex, on north side of track. Pitched natural slate roof with limestone and brick chimneys. Square-headed openings with margined 1/1 sliding sash windows. Still in use as mess roof for station staff.

Evaluation Of architectural merit. Group value with rest of station complex. Regional heritage interest. Merits current inclusion in Record of Protected Structures (RPS LA 143).

Significance Regional

Statutory protection RPS LA 143 Action

Other databases LAIAR-005-028; NIAH 12800502

Photographs
 F916g_01 29/06/2006 Canteen at east end of complex, from south-east.



Feature F916h Portarlington Station

Site type Post box
 County Co Laois Townland Cooltedery
 Town Portarlington Address Station Road, Portarlington
 Grid 254825 210892 OS six-inch sheet LA 005

History 19th century pillar box.

Survey date 29/06/2006 Surveyor Fred Hamond

Ownership Public (Iarnród Éireann)

Completeness Complete Condition Excellent Current use Post box

Description Freestanding cast-iron pillar box on platform side of station building on north side of line. Ornate "VR" [=Victoria Regina] cast on front. At base is makers name - A. Handyside & Co Ltd/ Derby & London. Still in use.

Evaluation A well preserved Victorian pillar box with an attested maker. Of regional heritage significance. Merits current inclusion in Record of Protected Structures (RPS LA 143_B).

Significance Regional

Statutory protection RPS LA 143_B Action

Other databases LAIAR-005-028; NIAH 12800502

Photographs
 F916h_01 29/06/2006 Pillar box on north platform.



Feature	F916i	Portarlington Station
----------------	--------------	------------------------------

Site type	Locomotive shed		
County	Co Laois	Townland	Cooltedery
Town	Portarlington	Address	Station Road, Portarlington
Grid	255013 210899	OS six-inch sheet	LA 005
History	Probably an original feature of the station (i.e. dating to 1850s). Shown on 1888 OS six-inch map and explicitly cited as 'engine house' on 1907 edition (Laois sheet 5).		
Survey date	22/08/2006	Surveyor	Fred Hamond
Ownership			
Completeness	No visible remains	Condition	N/A
		Current use	N/A
Description	Site of engine shed.		
Evaluation	No industrial heritage significance.		
Significance	Record only		
Statutory protection	Action		
Other databases	LAIAR-005-028		

Feature F916j Portarlington Station

Site type Turntable
 County Co Laois Townland Cooltedery
 Town Portarlington Address Station Road, Portarlington
 Grid 254992 210868 OS six-inch sheet LA 005

History Cited as turntable on 1888 OS six-inch map (Laois sheet 5).

Survey date 22/08/2006 Surveyor Fred Hamond

Ownership

Completeness No visible remains Condition N/A Current use N/A

Description No traces of turntable, or siding thereto, survive.

Evaluation No industrial heritage significance.

Significance Record only

Statutory protection Action

Other databases LAIAR-005-028

Feature F916k Odlum's Mill siding

Site type Railway siding

County Co Laois Townland Cooltedery

Town Portarlinton Address Station Road, Portarlinton

Grid 254833 210933 OS six-inch sheet LA 005

History First shown on the 1907 OS six-inch map (Laois sheet 5).

Survey date 29/06/2006 Surveyor Fred Hamond

Ownership Public (Iarnród Éireann)

Completeness Some remains Condition Fair Current use Disused

Description Siding serving Odlum's Mill survives at east end, at junction with main line. Comprises a single track with loading bank along north side. North end of siding cleared.

Evaluation Local industrial heritage significance.

Significance Local

Statutory protection Action

Other databases LAIAR-005-010

Photographs
 F916k_01 29/06/2006 Looking north-west along former Odlum's Siding from junction with main line.



Feature F917

Site type Bridge (road/rail)
County Co Laois Townland Cooltedery
Town Portarlinton Address Station Road, Portarlinton
Grid 254729 210867 OS six-inch sheet LA 005

History This railway line was opened as far as Portlaoise by the Great Southern & Western Railway in 1847 (it reached Cork in 1849). The stonework is original, but the deck is a mid/late 20th century replacement.

Survey date 29/06/2006 Surveyor Fred Hamond
Ownership Public (Laois CC)
Completeness Complete Condition Excellent Current use Road bridge

Description A twin-span reinforced-concrete girder bridge carries a public road over the Dublin-Cork railway immediately west of Portarlinton Station. Abutments are of rock-faced limestone blocks with tooled arrises. Pier is of squared limestone laid randomly. Dressed masonry string course along line of original arch springing on main (north) span. Original spans replaced with pre-cast reinforced-concrete beams. Parapets of cast-in-situ concrete. Squared limestone rubble wing walls with masonry copings. Road ramped up to both ends. Iarnród Éireann bridge number 119.

Evaluation No industrial heritage significance.

Significance Record only

Statutory protection Action

Other databases LAIAR-005-027

Photographs

F917_01 29/06/2006 Road bridge from east.





Feature F918

Site type Railway
County Co Laois Townland Cooltedery
Town Portarlinton Address
Grid 254702 210863 OS six-inch sheet LA 005

History This railway line was opened as far as Portlaoise by the Great Southern & Western Railway in 1847 (it reached Cork in 1849). At Ballybrophy, there is a branch line to Limerick, opened in 1864.

Survey date 29/06/2006 Surveyor Fred Hamond
Ownership Public (Iarnród Éireann)
Completeness Complete Condition Excellent Current use Railway
Description Double track railway line from Dublin to Cork in use by Iarnród Éireann.

Evaluation Local industrial heritage significance.

Significance Local

Statutory protection Action

Other databases LAIAR-005-023

Photographs
F918_01 22/08/2006 Looking west along railway line from road bridge just west of Portarlinton Station. Cork line at left; Galway line at right.



- References Callaghan, S. 'The rise and fall of railways in Laois'. In Laois Association Yearbook, 1996-97. p.29.
- Johnson, S. Johnson's Atlas & Gazetteer of the Railways of Ireland, pp 71-72. Leicester: Midland Publishing, 1997.
- Middlemass, T. Irish Standard Gauge Railways, pp 13-21. Newton Abbot: David & Charles, 1981.
- Rowledge, J.W.P., A Regional History of Railways, vol.16: Ireland, p.86. Penryn: Transport Atlantic Publishers, 1995.
- Walsh, H. Borris-in-Ossory, Co Laois, pp 134-137. Kilkenny: Kilkenny Journal, 1969.

Feature F919

Site type	Railway		
County	Co Laois	Townland	Cooltedery
Town	Portarlinton	Address	
Grid	254262 211061	OS six-inch sheet	LA 005
History	Portarlinton to Tullamore section of railway line opened 1854 (extended to Athlone 1859). Since 1973, has been used as the main line from Dublin to Galway.		
Survey date	29/06/2006	Surveyor	Fred Hamond
Ownership	Public (Iarnród Éireann)		
Completeness	Complete	Condition	Excellent
		Current use	Railway
Description	Embanked single-track railway line runs from Portarlinton Station to Tullamore and onwards to Athlone and Galway.		
Evaluation	Local industrial heritage significance.		
Significance	Local		
Statutory protection	Action		
Other databases	LAIAR-005-003		
References	Johnson, S. Johnson's Atlas & Gazetteer of the Railways of Ireland, p.69. Leicester: Midland Publishing, 1997.		

Feature F920a

Site type Railway junction

County Co Laois Townland Cooltedery

Town Portarlinton Address Station Road, Portarlinton

Grid 254673 210860 OS six-inch sheet LA 005

History Portarlinton to Tullamore section of railway line opened 1854 (extended to Athlone 1859). Since 1973, has been used as the main line from Dublin to Galway.

Survey date 29/06/2006 Surveyor Fred Hamond

Ownership Public (Iarnród Éireann)

Completeness Complete Condition Excellent Current use Railway junction

Description Single track line diverges north-west to Tullamore and Athlone from double track Dublin-Cork line just west of road-over-railway bridge at Portarlinton Station.

Evaluation Local industrial heritage significance.

Significance Local

Statutory protection Action

Other databases

Photographs

F920a_01 29/06/2006 Railway junction from road bridge (feature 917).



Feature F920b

Site type Signal box

County Co Laois Townland Cooltedery

Town Portarlinton Address Station Road, Portarlinton

Grid 254697 210875 OS six-inch sheet LA 005

History Probably erected c.1854 when branch to Tullamore opened. Apparently the tallest signal box ever built in Ireland. Became obsolete when new signalling system introduced in 1976.

Survey date 22/08/2006 Surveyor Fred Hamond

Ownership

Completeness No visible remains Condition N/A Current use N/A

Description The signal box has been completely removed.

Evaluation No industrial heritage significance.

Significance Record only

Statutory protection Action

Other databases LAIAR-005-028

Feature	F921	Portarlington Gasworks		
Site type	Gas Works			
County	Co Laois	Townland	Cooltedery	
Town	Portarlington	Address	Station Road, Portarlington	
Grid	254585 210876		OS six-inch sheet	LA 005
History	First shown on 1888 OS six-inch map (Laois sheet 5); captioned as "Gas ho". On the 1907 edition, a gasometer and chimney are captioned.			
Survey date	29/06/2006	Surveyor	Fred Hamond	
Ownership				
Completeness	No visible remains	Condition	N/A	Current use N/A
Description	Site cleared and no visible remains survive.			
Evaluation	No industrial heritage significance.			
Significance	Record only			
Statutory protection	Action			
Other databases	LAIAR-005-026			

Feature F922

Site type Quarry

County Co Laois Townland Cooltedery

Town Portarlinton Address Station Road, Portarlinton

Grid 254551 210891 OS six-inch sheet LA 005

History Shown on 1838 OS six-inch map (Laois sheet 5), but not explicitly captioned as a quarry until the 1907 edition.

Survey date 29/06/2006 Surveyor Fred Hamond

Ownership

Completeness No visible remains Condition N/A Current use N/A

Description Quarry has been infilled and no visible traces remain.

Evaluation No industrial heritage significance.

Significance Record only

Statutory protection Action

Other databases LAIAR-005-025

Feature F923 Ballymorris House

Site type House
 County Co Laois Townland Cooltedery
 Town Portarlinton Address
 Grid 254335 211281 OS six-inch sheet LA 005

History Shown on 1838 OS six-inch map (Laois sheet 5).

Survey date 22/08/2006 Surveyor Fred Hamond

Ownership Private

Completeness Complete Condition Fair Current use Dwelling

Description Detached three-bay, two-storey house set in own grounds on east side of road. Aligned NW-SE with principal elevation facing SW. Hipped natural slate roof with two rendered chimneys and half-round metal gutters. Cement-harled random rubble walls with ashlar base course and string course at first floor level (on front façade). The frontage is symmetrical with a semicircular-headed doorway to ground floor middle. Timber door has eight raised panels, aproned sidelights and semicircular-headed overlight, all with decorative leadwork tracery. The end bays have 9/6 sliding sash windows to the ground floor, both with narrow 3/2 flanking windows, none of which have cills. Above the door is a semicircular window opening with three 2/2 sashes. The end bays have 6/6 sashes, both with 2/2 flankers. The first floor windows have concrete cills. Metal-framed casement windows to gables. Two-storey 20th century extension to rear elevation, with earlier outbuildings behind. No internal access. Entrance from main road comprises cast-iron railings on curved dwarf ashlar limestone wall which terminates in square cast-concrete piers. Vehicle gates to centre are flanked by pedestrian gates to both sides. The handles to the gates are in the style of a duck's beak.

Evaluation Although modest in scale, this house has sufficient architectural character to make it of local heritage significance. It is already included in the Record of Protected Structures (LA 674).

Significance Local

Statutory protection RPS LA 674 Action

Other databases NIAH 12800554

Photographs

F923_01 22/08/2006 Front façade of Ballymorris House, from south-east.



F923_02 22/08/2006 Front door detail.



F923_03 22/08/2006 Entrance screen at main road.



F923_04 22/08/2006 Duck's beak detail on gate handle.



Feature F924

Site type Bridge (rail/road)

County Co Laois Townland Cooltedery

Town Portarlington Address

Grid 254143 211361 OS six-inch sheet LA 005

History Portarlington to Tullamore section of railway line opened 1854 (extended to Athlone 1859). Now in use as the Dublin-Galway line. Deck replaced in mid/ate 1900s.

Survey date 29/06/2006 Surveyor Fred Hamond

Ownership Public (Iarnród Éireann)

Completeness Complete Condition Excellent Current use Railway bridge

Description A skew single-span girder bridge carries a single-track railway from Portarlington to Tullamore over a public road. The abutments are of rock-faced limestone blocks laid to courses and embellished with tooled arrises. The deck is a replacement and comprises plate girders along each side, with metal troughing between. Both ends rest on concrete pillow blocks. Cantilevered footplates and handrails across each side. The span measures 7.51m orthogonally, and 10.92m on the skew. The abutments are approximately twice the depth of the deck - the bridge was built to accommodate two tracks, but only one was laid. Curved wing walls of squared random rubble coped with dressed stones and terminating in square piers. Iarnród Éireann bridge number 406.

Evaluation Of local industrial heritage significance only.

Significance Local

Statutory protection Action

Other databases LAIAR-005-005

Photographs

F924_01 29/06/2006 South-west elevation of railway bridge.



F924_02

29/06/2006

South-east abutment of railway bridge. Note width compared with that of deck.



Feature F925

Site type Bridge (rail/road)

County Co Laois Townland Cooltedery

Town Portarlinton Address

Grid 254068 211489 OS six-inch sheet LA 005

History Portarlinton to Tullamore section of railway line opened 1854 (extended to Athlone 1859). Now in use as the Dublin-Galway line. Deck replaced in 1900s.

Survey date 29/06/2006 Surveyor Fred Hamond

Ownership Public (Iarnród Éireann)

Completeness Complete Condition Excellent Current use Railway bridge

Description A single-span reinforced-concrete bridge carries a single-track railway from Portarlinton to Tullamore over a field accommodation track. The abutments are of squared limestone rubble brought to courses and embellished with rock-faced quoins with tooled arrises. The original flat span has been replaced with a reinforced-concrete deck and parapets of 3.62m span. A timber footplates runs across the east face of the bridge. The abutments are 8.67m deep, but the deck is only 4.67m - it was obviously built for two tracks, but only one was laid. Curved wing walls of squared random rubble coped with dressed stones. Iarnród Éireann bridge number 406.

Evaluation Of local industrial heritage significance only.

Significance Local

Statutory protection Action

Other databases LAIAR-005-004

Photographs

F925_01 29/06/2006 West elevation.



Feature	F926				
Site type	Quarry				
County	Co Laois	Townland	Ballymorris		
Town	Address				
Grid	253913	210735	OS six-inch sheet	LA 004	
History	Shown on 1839 and 1888 OS six-inch maps (Laois sheet 4). Explicitly cited as 'quarry' on 1907 edition.				
Survey date	29/06/2006	Surveyor	Fred Hamond		
Ownership					
Completeness	No visible remains	Condition	N/A	Current use	N/A
Description	Quarry completely infilled and no visible traces.				
Evaluation	No industrial heritage significance.				
Significance	Record only				
Statutory protection	Action				
Other databases	LAIAR-004-012				

Feature F927

Site type Mile marker

County Co Laois Townland Ballymorris

Town Address

Grid 253135 211085 OS six-inch sheet LA 004

History Although first cited on 1907 OS six-inch map (Laois sheet 4), undoubtedly of earlier date.

Survey date 29/06/2006 Surveyor Fred Hamond

Ownership Private

Completeness Complete Condition Excellent Current use Ornamental feature

Description Freestanding masonry milestone on west side of public road into Portarlinton. Possibly slightly relocated, it is now embedded in concrete in a grass verge in front of a modern bungalow. It stands 80cm high and is of triangular cross section. Its two road faces and canted top surface are finely dressed. The south-facing side is inscribed "1/ Mile to/ Portar/ linton". The north face reads "5/ Miles/ to Mount/ melick". The top reads "Qcty/ Dub/ 36" [= Queen's County].

Evaluation This is a rare example of an 18th or early 19th century milestone. It is well maintained and a prominent roadside feature. Of regional significance, it merits inclusion in the Record of Monuments & Places.

Significance Regional

Statutory protection Action Include in RMP

Other databases LAIAR-004-025

Photographs

F927_01 29/06/2006 Milepost from south, showing roadside context.



F927_02

29/06/2006

Milepost from south (scale is 30cm long).



F927_03

29/06/2006

Milepost from north (scale is 30cm long).



Feature F928 Kilnahown Bridge

Site type	Bridge (road/river)		
County	Co Laois	Townland	Coolnavarnoge and Coolaghy; Co Offaly
Town	Address		
Grid	251346 210693	OS six-inch sheet	LA 004; OF 033
History	Cited as 'Kilnahown Bridge' on 1838, 1884 and 1910 OS maps for Co Offaly. Probably erected in second half of 18th century.		
Survey date	29/06/2006	Surveyor	Fred Hamond
Ownership	Public (Laois CC; Offaly CC)		
Completeness	Complete	Condition	Good
		Current use	Road bridge
Description	Four-arch masonry bridge carries minor road over River Barrow at county boundary. Of random rubble construction throughout. Originally there were angled cutwaters on the upstream (west) ends of the piers only, rising to above arch spring level. Mass concrete cutwaters were added on the downstream side and rise to spring level only. The bases of the abutments and piers are underpinned with concrete. The arches are of semicircular profile and have squared rubble voussoirs. From east (Offaly) to west (Laois), the spans are: 6.08m, 4.78m, 5.41m and 4.82m. There is also a small flood arch (now dry) on the Laois side. The parapets are 6.54m apart. Slight hump to deck.		
Evaluation	Architecturally, this bridge is of interest in terms of its scale, unadorned style typical of an 18th century Grand Jury construction. It also enhances the riverscape hereabouts. It is of regional heritage significance and merits inclusion in the Record of Protected Structures.		
Significance	Regional		
Statutory protection		Action	Include in RPS
Other databases	LAIAR-004-006; OFIAR-033-006		
Photographs			
F928_01	29/06/2006	Upstream (south-west) elevation of bridge.	



F928_02 17/06/2004 South (upstream) elevation, from left bank.



F928_03 17/06/2004 North (downstream) elevation, from right bank.



Feature F929 Tinnakill Castle

Site type	Sheela-na-gig; Tower house		
County	Co Laois	Townland	Tinnakill
Town	Address		
Grid	250170 208842	OS six-inch sheet	LA 008
History	Cited as 'Tinnakill Castle' on 1839 OS six-inch map (Laois sheet 8). Thought by Archaeological Survey to be of late 16th or early 17th century date. One of two sheela-na-gigs built into a nearby farmyard wall are thought to be from the castle. However, they were removed from this wall and their whereabouts is unknown.		
Survey date	29/06/2006	Surveyor	Fred Hamond
Ownership	Private		
Completeness	Substantial remains	Condition	Poor
		Current use	Disused
Description	Ruinous remains of four-storey tower house. Of random rubble throughout, with dressed stone openings. Walls are partly collapsed above second storey. Remains of roof parapet. Door on south elevation has two-centred head. Intramural spiral staircase at south corner has slit windows with splayed internal reveals. Flat-headed windows to upper floors. All internal floors now missing with exception of vaulted ceiling to second floor. Commands good views of flat ground on all sides. Not maintained. Ivy overgrowth will eventually dislodge stones, causing further collapse.		
Evaluation	Regional heritage significance. Current inclusion in RMP (LA008-00101-; LA008-00102-) and RPS (RPS LA 398) justified on ground of architectural, archaeological, historical and landscape merits.		
Significance	Regional		
Statutory protection	RMP LA008-00101-; RMP LA008-00102-; RPS LA 398	Action	
Other databases	SMR LA008-00101-; SMR LA008-00102-		

Photographs

F929_01 29/06/2006 Tinnakill Castle from north-west.



F929_02 29/06/2006 Doorway on south elevation.



References Sweetman, P.D., Alcock, O. and Moran, B. Archaeological Inventory of County Laois, p.116 (entry 968). Dublin: Stationery Office, 1995.

Feature F930a Rock Quarry

Site type Quarry (limestone)

County Co Laois Townland Kilnacash

Town Address The Rock, Kilnacash

Grid 247950 207364 OS six-inch sheet LA 008

History Not shown on 1839 or 1888 OS six-inch maps (Laois sheet 8). First shown on 1907 edition. Still in use in 1920s.

Survey date 14/06/2006 Surveyor Fred Hamond

Ownership Private

Completeness Substantial remains Condition Fair Current use Disused

Description Substantial remains of disused limestone quarry to south of Kilnacash House. Exposed rock faces stand 10-15m high.

Evaluation Local industrial heritage significance.

Significance Local

Statutory protection Action

Other databases LAIAR-008-071

Photographs
F930a_01 14/06/2006 Rock Quarry from south.





Feature F930b Rock Quarry

Site type Lime kiln
County Co Laois Townland Kilnacash
Town Address The Rock, Kilnacash
Grid 247934 207416 OS six-inch sheet LA 008

History According to the valuation revision books, a salt and lime house were erected by Jonathan Pim in 1859. William Pim took over operations in the mid 1860s. The premises is noted as "salt and lime factory" from the late 1870s onwards (although both were probably being manufactured since 1859). William Robinson took over from Pim in 1903. The factory disappears from the valuations in 1942 (although it may have been out of use before then). The limestone was probably derived initially from a small quarry shown in the adjoining townland of Kilmainham (shown on the 1888 OS six-inch map, Laois sheet 8), and then from the existing quarry (F930a). Neither the kiln nor salt pan is on any of the six-inch maps.

Survey date 14/06/2006 Surveyor Fred Hamond

Ownership

Completeness No visible remains Condition N/A Current use N/A

Description No traces of lime kiln survive.

Evaluation No industrial heritage significance.

Significance Record only

Statutory protection Action

Other databases LAIAR-008-071

Feature F930c Rock Quarry

Site type Salt pan
 County Co Laois Townland Kilnacash
 Town Address The Rock, Kilnacash
 Grid 247934 207416 OS six-inch sheet LA 008

History Rock salt imported from Carrickfergus via Mountmellick Canal. Processed into usable salt at this site. The pan, in which the rock salt was dissolved, apparently sat on top of lime kiln. According to the valuation revision books, a salt and lime house were erected by Jonathan Pim in 1859. William Pim took over operations in the mid 1860s. The premises is noted as "salt and lime factory" from the late 1870s onwards (although both were probably being manufactured since 1859). William Robinson took over from Pim in 1903. The factory disappears from the valuations in 1942 (although it may have been out of use before then). Neither the kiln nor salt pan is on any of the six-inch maps.

Survey date 14/06/2006 Surveyor Fred Hamond

Ownership

Completeness No visible remains Condition N/A Current use N/A

Description No visible traces of former salt pan.

Evaluation No industrial heritage significance.

Significance Record only

Statutory protection Action

Other databases LAIAR-008-071

Feature F930d Rock Quarry

Site type Electricity generator (wind)

County Co Laois Townland Kilnacash

Town Address The Rock, Kilnacash

Grid 247937 207379 OS six-inch sheet LA 008

History According to Mr Phillip Stewart, the owner, this was a home-made wind-powered device for charging batteries, installed in 1940s. It comprised a twin-bladed propeller on a metal post.

Survey date 14/06/2006 Surveyor Fred Hamond

Ownership Private

Completeness Traces Condition Fair Current use Disused

Description At south-west corner of quarry is rocky eminence surmounted by 2m high concrete pillar, on top of which is steel pole which supported the rotor. On north face of pillar is remnant of ratchet pulley for reefing tail vane.

Evaluation Local industrial heritage significance.

Significance Local

Statutory protection Action

Other databases LAIAR-008-071

Photographs
F930d_01 14/06/2006 Base of wind-powered electricity generator at Rock Quarry.



Feature F930e

Site type Water pump (wind)
County Co Laois Townland Kilnacash
Town Address Kilnacash House, Kilnacash
Grid 247958 207403 OS six-inch sheet LA 008

History Pumped up water from canal feeder to header tank which supplied Kilnacash House. Mr Phillip Stewart, the owner, states that imported from America in 1941. In use until canal closed in 1960 (when feeder dried up).

Survey date 14/06/2006 Surveyor Fred Hamond
Ownership Private
Completeness Complete Condition Fair Current use Disused

Description Freestanding wind pump located immediately south-west of Kilnacash House. Constructed of galvanised angle-iron and situated on a square random rubble base tower. Multi-vaned sails and triangular tailpole. The pump raised water into a cement-rendered brick cistern on top of the tower. This was used for domestic purposes in the adjoining house. Both the windpump and cistern are now defunct.

Evaluation Local industrial heritage significance.

Significance Local

Statutory protection Action

Other databases LAIAR-008-071

Photographs
F930e_01 14/06/2006 Domestic windpump at Kilnacash House, from west.



F930e_02

30/08/2006

Domestic windpump at Kilnacash House, from north-east.



F930e_03

30/08/2006

Domestic windpump at Kilnacash House, from south.



F930e_04

14/06/2006

Domestic windpump at Kilnacash House, from north-east.



Feature F931

Site type Mile marker

County Co Laois Townland Kilmainham

Town Address

Grid 247589 207432 OS six-inch sheet LA 008

History Although not shown on OS six-inch map (Laois sheet 8) until 1907 edition, undoubtedly of earlier date.

Survey date 14/06/2006 Surveyor Fred Hamond

Ownership

Completeness No visible remains Condition N/A Current use N/A

Description No visible remains of former milestone.

Evaluation No industrial heritage significance.

Significance Record only

Statutory protection Action

Other databases LAIAR-008-025

Feature F932 Triogue Bridge

Site type Bridge (road/river)

County Co Laois Townland Debicot; Kilmainham

Town Address

Grid 247574 207432 OS six-inch sheet LA 008

History Shown on 1839 and 1888 OS six-inch maps (Laois sheet 8). Explicitly cited as 'Triogue Bridge' on 1907 edition.

Survey date 14/06/2006 Surveyor Fred Hamond

Ownership Public (Laois CC)

Completeness Complete Condition Good Current use Road bridge

Description Twin-arch bridge carries main road over Triogue River. Of random rubble limestone. Arches are of segmental profile with dressed limestone voussoirs. Angled cutwater to upstream (south) ; squared to north side. Downstream (north) parapet partly replaced with mass concrete. Abutments and soffits have been gunited. Pipe carried across outside face of north parapet.

Evaluation No industrial heritage significance.

Significance Record only

Statutory protection Action

Other databases LAIAR-008-024

Photographs
 F932_01 14/06/2006 Triogue Bridge from upstream (south) side.





Feature F933

Site type Lime kiln; Salt pan

County Co Laois Townland Ballycullenbeg

Town Mountmellick Address Salthouse Lane

Grid 245882 207831 OS six-inch sheet LA 008

History Cited as "salt ho." on 1839 and 1888 OS six-inch maps (Laois sheet 8). Griffith valuation book notes that "offices, salt works, lime kiln" were owned by George Penrose in 1850s. This suggests that salt was being manufactured (probably a salt pan on top of the lime kiln), as well as being stored. In the 1866 valuation revision book entry, George is replaced by Jane Penrose and the saltworks and kiln are crossed out, indicating that they were no longer in use. The salt store is shown as a roofless shell on the 1907 OS map. According to the valuations, the store was replaced by a dwelling house in 1914.

Survey date 14/06/2006 Surveyor Fred Hamond

Ownership

Completeness No visible remains Condition N/A Current use N/A

Description The site of the salt store has been redeveloped and incorporated in a modern house. The street name - Salthouse Lane - recalls its former presence.

Evaluation No industrial heritage significance.

Significance Record only

Statutory protection Action

Other databases LAIAR-008-078

Photographs

F933_01 14/06/2006 Road sign near junction with main road.



References O'Keeffe, R. The Quakers of Mountmellick, p.31 (Mountmellick: Mountmellick Development Association, 1994).

Feature F934

Site type Water pump

County Co Laois Townland Ballycullenbeg

Town Mountmellick Address Harbour Street

Grid 245902 207678 OS six-inch sheet LA 008

History Probably installed by Mountmellick UDC in mid 1900s.

Survey date 14/06/2006 Surveyor Fred Hamond

Ownership Private

Completeness Complete Condition Excellent Current use Water pump

Description Freestanding cast-iron water pump on south side of main road. Plain banded column with fluted top and oak finial to cap. Cow tail handle. Bracket on spout from which to hand bucket. Mounted on concrete base over well. Still in working order.

Evaluation A rare example of a still-working pump. Local heritage significance is raised to regional interest on account of rarity and fact that still working. .

Significance Regional

Statutory protection Action Include in RPS

Other databases

Photographs
F934_01 14/06/2006 General view of water pump.



Feature F935

Site type House
County Co Laois Townland Ballycullenbeg
Town Mountmellick Address Harbour Street
Grid 245709 207626 OS six-inch sheet LA 008

History According to the valuation revision books for Mountmellick Urban Electoral Division, these houses were erected by Laois County Council in 1953. Each had the same rateable valuation of STG£7.

Survey date 14/06/2006 Surveyor Fred Hamond
Ownership Private
Completeness Complete Condition Excellent Current use Dwelling

Description Terrace of 22 two-bay, two-storey houses arranged as shallow crescent on north side of main road. Pitched terracotta roofs, rendered chimneys and cement-harled walls. Square-headed openings with replacement doors and windows. The line is broken by two symmetrically arranged timber-clad gables incorporating first-floor bedrooms. Small gardens to front. Strong streetscape character.

Evaluation Local heritage significance. Already included in Record of Protected Structures (RPS LA 688).

Significance Local

Statutory protection RPS LA 688 Action

Other databases NIAH 12900302

Photographs
F935_01 14/06/2006 Terrace from west.



Feature F936 Grange Lodge

Site type House
 County Co Laois Townland Ballycullenbeg
 Town Mountmellick Address Harbour Street
 Grid 245700 207551 OS six-inch sheet LA 008

History According to the Mountmellick Development Association, this is the oldest surviving house in Mountmellick. It was built in 1686 by John Pim and remained in his family's ownership until 1840. However, the NIAH dates the house to c.1835, but the basis of this assignation is not given. Cited as 'Grange Lodge' on 1839 OS six-inch map (Laois sheet 8).

Survey date 14/06/2006 Surveyor Fred Hamond
 Ownership Private
 Completeness Complete Condition Excellent Current use Dwelling

Description Detached four-bay, three-storey house on south side of main road. Hipped natural slate roof, rendered chimneys, and cement-rendered walls. Multi-panel door set in semicircular-headed opening with overlight. Square-headed window openings with replacement uPVC windows.

Evaluation Local heritage significance. Already included in Record of Protected Structures (RPS LA 689).

Significance Local
 Statutory protection RPS LA 689 Action

Other databases NIAH 12900303

Photographs
 F936_01 14/06/2006 Grange Lodge from north.



Feature F937

Site type House
County Co Laois Townland Ballycullenbeg
Town Mountmellick Address Harbour Street
Grid 245661 207511 OS six-inch sheet LA 008

History NIAH dates houses to c.1840. Shown on 1839 OS six-inch map (Laois sheet 8).

Survey date 14/06/2006 Surveyor Fred Hamond

Ownership Private

Completeness Complete Condition Excellent Current use Dwelling

Description Pair of semi-detached three-bay, two-storey houses on south side of main road. Pitched artificial slate roofs, rendered chimneys and cement-harled walls. Each façade is symmetrical, with door to ground floor centre and flanking windows. Six-panel door is set in semicircular-headed opening, with timber surround and spider's web overlight. All windows are square-headed - 6/6 to east house, and 1/1 to west house. Wall and railings to front of each house.

Evaluation Local heritage significance. Already included in Record of Protected Structures (RPS LA 690).

Significance Local

Statutory protection RPS LA 690 Action

Other databases NIAH 12900304

Photographs

F937_01 14/06/2006 Houses from north-west.



